

Mainstone Close,
Deepcut, Camberley, GU16 6RU

£1,250 PCM



Available 14th July 2025

Luff Associates are proud to offer this two bedroom mid terrace house situated in a cul-de-sac close to local shops and transport facilities.

Accommodation consists of small entrance hall leading through to the dining area opening in to the living room, kitchen and cloakroom. On the first floor there is the double bedroom, single bedroom and the family bathroom.

Externally there is a rear garden that is mainly laid to lawn. There is also allocated parking for one car.

Unfurnished

Pets Considered

Council Tax Band C £2175.25PA

Council tax charges change annually

- Two bedrooms
- Fully fitted kitchen
- Allocated parking space
- Garden
- Lounge and dining room
- Close to local amenities



1a Guildford Road, Frimley Green, Camberley, Surrey, GU16 6NL
Tel: 01252 834949 admin@luff-associates.com www.luff-associates.com

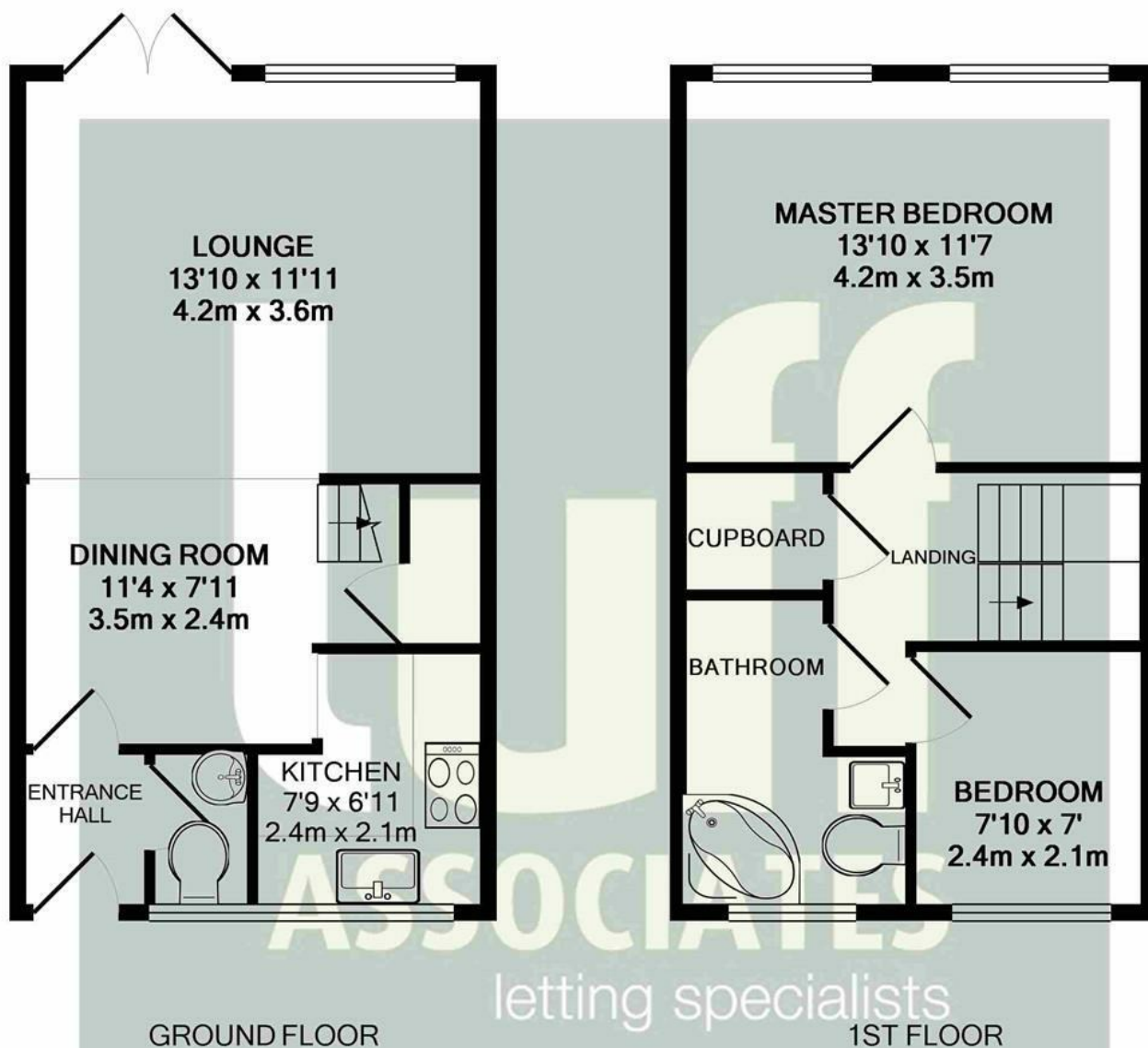

Whilst every attempt has been made to ensure the accuracy of the floor plan contained here, measurements of doors, windows, rooms and any other items are approximate and no responsibility is taken for any error, omission, or mis-statement. This plan is for illustrative purposes only and should be used as such by any prospective purchaser. The services, systems and appliances shown have not been tested and no guarantee as to their operability or efficiency can be given
Made with Metropix ©2018

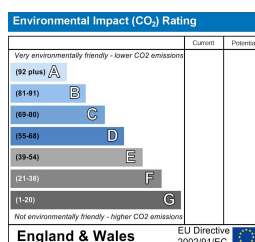
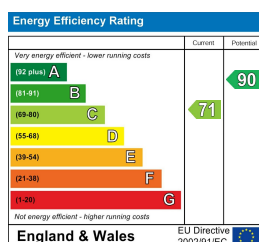

In partnership with
LUFF & WILKIN
sales 01252 838 899

Disclaimer: The Rent advertised does not include the Tenancy Deposit or any fee's or charges which are payable. Further information can be obtained from the agent or at the point of viewing. These details have been prepared and issued in good faith and do not constitute representations of fact or form part of any offer or contract Luff Associates Ltd have not carried out a structural survey of the property, nor have we tested any of the services or appliances. All measurements are intended to be approximate only and all photographs show parts of the property as they were at the time they were taken. Any reference to alterations or particular use of the property wherever stated, is not a statement that planning, building regulations or other relevant sent has been obtained