

Danebury Walk, Frimley, Camberley, GU16 8XU

£1,495 Per Month



Available 23rd May 2025

Luff Associates are proud to offer this end of terrace 2 bedroom house, located on the popular Paddock Hill development close to superb schools, local amenities and Frimley Park Hospital.

Comprising of living room with under stairs cupboard leading to kitchen/dining room where French doors lead out to the garden which is mainly laid to lawn. Two double bedrooms with family bathroom upstairs.

Garage in block.
Regret No Pets

Unfurnished
Council Tax band C £2175.25PA
Disclaimer; Council tax charges change annually

- Two bedrooms
- Terraced house
- Single Garage
- Paddock Hill
- Close to schools
- Fitted kitchen

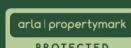

1a Guildford Road, Frimley Green, Camberley, Surrey, GU16 6NL
Tel: 01252 834949 admin@luff-associates.com www.luff-associates.com

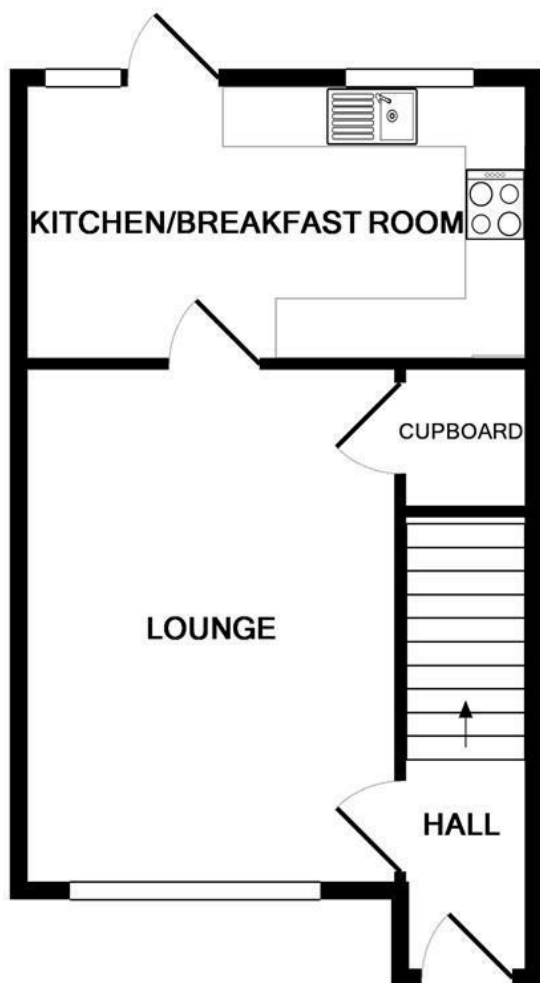

GROUND FLOOR

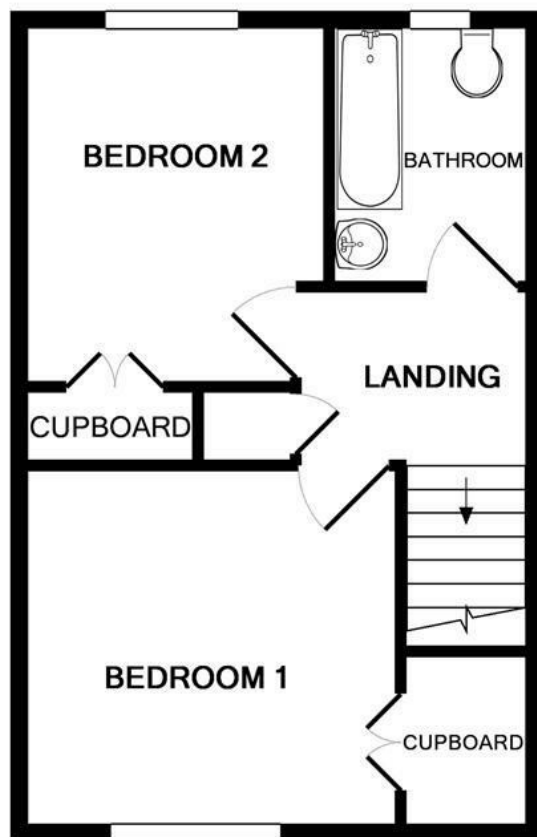

1ST FLOOR

Whilst every attempt has been made to ensure the accuracy of the floor plan contained here, measurements of doors, windows, rooms and any other items are approximate and no responsibility is taken for any error, omission, or mis-statement. This plan is for illustrative purposes only and should be used as such by any prospective purchaser. The services, systems and appliances shown have not been tested and no guarantee as to their operability or efficiency can be given
Made with Metropix ©2016

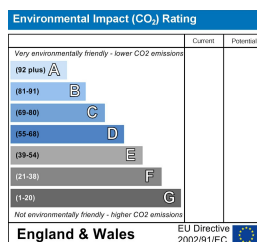
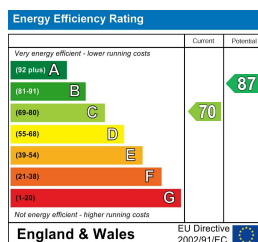

In partnership with
LUFF & WILKIN
sales 01252 838 899

Disclaimer: The Rent advertised does not include the Tenancy Deposit or any fee's or charges which are payable. Further information can be obtained from the agent or at the point of viewing. These details have been prepared and issued in good faith and do not constitute representations of fact or form part of any offer or contract Luff Associates Ltd have not carried out a structural survey of the property, nor have we tested any of the services or appliances. All measurements are intended to be approximate only and all photographs show parts of the property as they were at the time they were taken. Any reference to alterations or particular use of the property wherever stated, is not a statement that planning, building regulations or other relevant sent has been obtained