

Quebec Gardens,  
Blackwater, Camberley, GU17 9DE

£1,650 PCM



\*\*Available 26th August 2024\*\*

A three bedroom terrace home located within a quiet cul-de-sac location offering convenient access to local amenities.

The accommodation comprises of an entrance hall, 25ft lounge/dining room with doors to rear and kitchen with white goods. The first floor offers the three bedrooms and a bathroom.

Outside there is an enclosed rear garden, open plan front garden, garage and parking.

Unfurnished  
Regret No Pets  
Council Tax - Hart District band C - £1943.16pa  
Disclaimer; Council tax band charge may change yearly



1a Guildford Road, Frimley Green, Camberley, Surrey, GU16 6NL  
Tel: 01252 834949 admin@luff-associates.com www.luff-associates.com

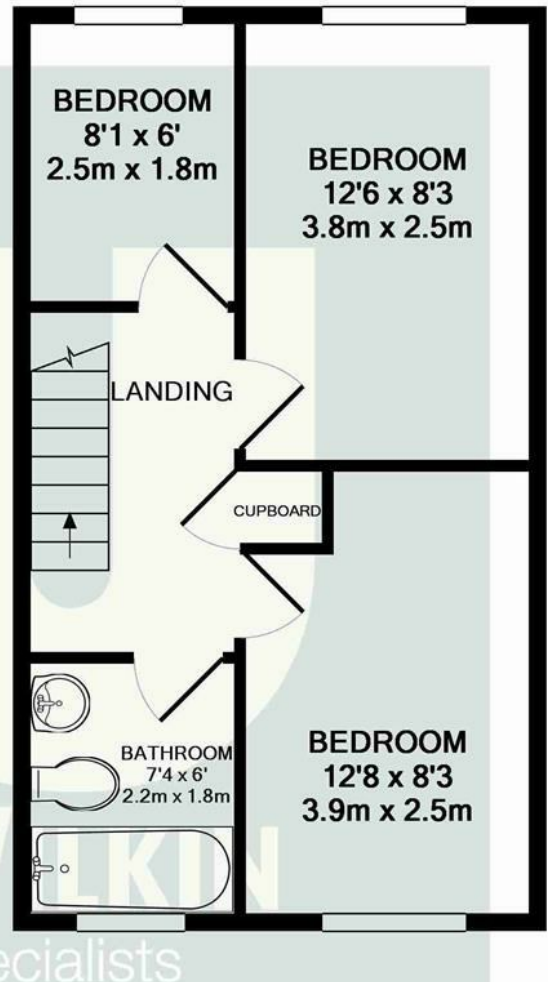
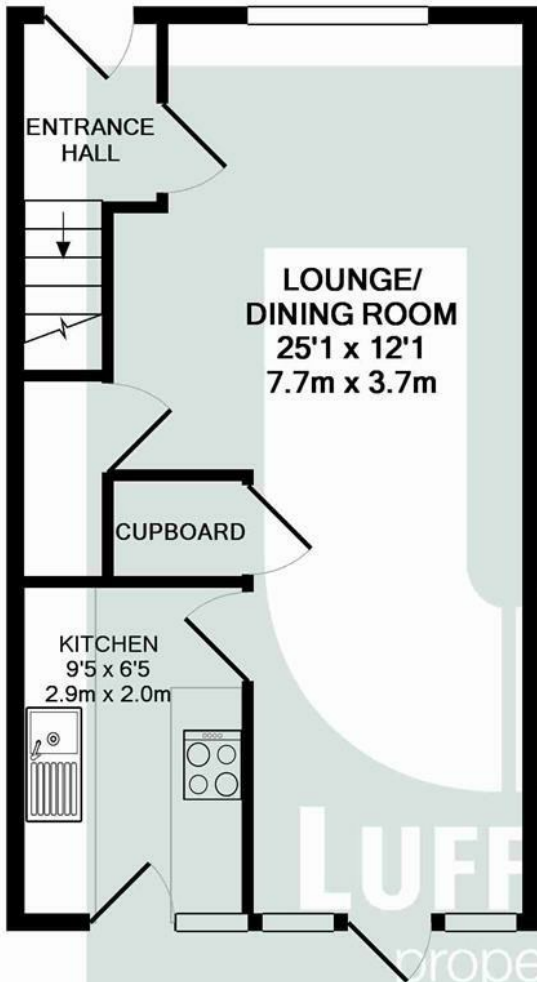

Whilst every attempt has been made to ensure the accuracy of the floor plan contained here, measurements of doors, windows, rooms and any other items are approximate and no responsibility is taken for any error, omission, or mis-statement. This plan is for illustrative purposes only and should be used as such by any prospective purchaser. The services, systems and appliances shown have not been tested and no guarantee as to their operability or efficiency can be given  
 Made with Metropix ©2013

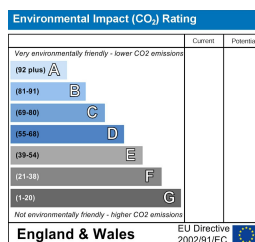
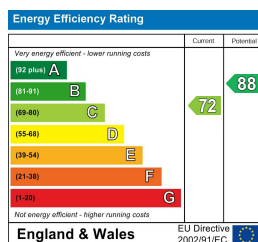

In partnership with  
**LUFF & WILKIN**  
 sales 01252 838 899

Disclaimer: The Rent advertised does not include the Tenancy Deposit or any fee's or charges which are payable. Further information can be obtained from the agent or at the point of viewing. These details have been prepared and issued in good faith and do not constitute representations of fact or form part of any offer or contract Luff Associates Ltd have not carried out a structural survey of the property, nor have we tested any of the services or appliances. All measurements are intended to be approximate only and all photographs show parts of the property as they were at the time they were taken. Any reference to alterations or particular use of the property wherever stated, is not a statement that planning, building regulations or other relevant sent has been obtained