

Mytchett Road,
Mytchett, Camberley, GU16 6ET

£1,100 Per Month



*** Available 13th September 2024***

A two bedroom flat in the heart of Mytchett village, close proximity to Farnborough town centre and Farnborough main station, along with North Camp station. Access to M3 and A30 are also nearby.

The property consists of lounge, kitchen/diner downstairs, with plenty of under stairs storage space. Upstairs is a main double bedroom, a decent sized second bedroom and a family bathroom with bath and shower.

Outside there is a garden space and parking at the front of the property.

Unfurnished
Regret No Pets

Council Tax band B £1818.30pa
Disclaimer: council tax charges may change yearly



1a Guildford Road, Frimley Green, Camberley, Surrey, GU16 6NL
Tel: 01252 834949 admin@luff-associates.com www.luff-associates.com

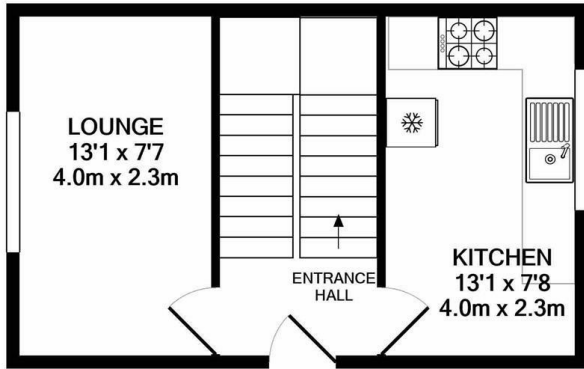

GROUND FLOOR
APPROX. FLOOR
AREA 280 SQ.FT.
(26.0 SQ.M.)

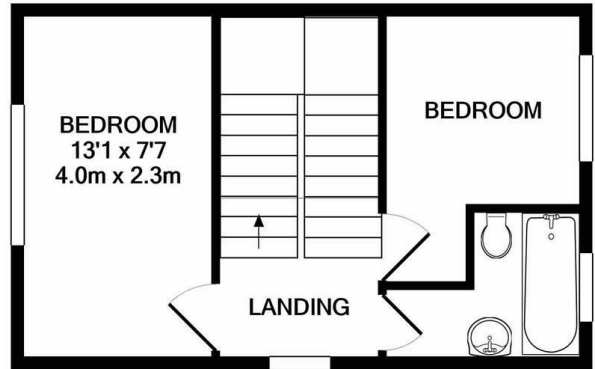

1ST FLOOR
APPROX. FLOOR
AREA 237 SQ.FT.
(22.1 SQ.M.)

TOTAL APPROX. FLOOR AREA 517 SQ.FT. (48.0 SQ.M.)

Whilst every attempt has been made to ensure the accuracy of the floor plan contained here, measurements of doors, windows, rooms and any other items are approximate and no responsibility is taken for any error, omission, or mis-statement. This plan is for illustrative purposes only and should be used as such by any prospective purchaser. The services, systems and appliances shown have not been tested and no guarantee as to their operability or efficiency can be given
Made with Metropix ©2020

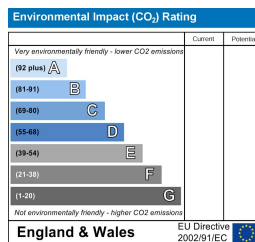
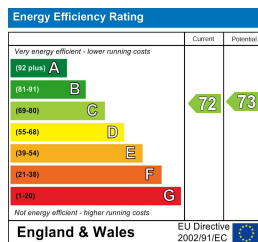

In partnership with
LUFF & WILKIN
sales 01252 838 899

Disclaimer: The Rent advertised does not include the Tenancy Deposit or any fee's or charges which are payable. Further information can be obtained from the agent or at the point of viewing. These details have been prepared and issued in good faith and do not constitute representations of fact or form part of any offer or contract Luff Associates Ltd have not carried out a structural survey of the property, nor have we tested any of the services or appliances. All measurements are intended to be approximate only and all photographs show parts of the property as they were at the time they were taken. Any reference to alterations or particular use of the property wherever stated, is not a statement that planning, building regulations or other relevant sent has been obtained