

Berkeley Crescent,
Paddock Hill, Frimley, GU16 8YN

£2,150 PCM



*** Available August 2024***

Luff Associates are proud to offer this charming four bedroom detached property on the ever popular Paddock Hill development with local shops and transport a short distance away. Presented to a high standard throughout.

The ground floor accommodation comprises of an entrance hallway with wooden flooring, lounge with doors to garden, a good size family room and kitchen/diner with double doors to garden. On the first floor there are four bedrooms 1 (double) with en-suite bathroom, bedroom 2 (double) bedroom 3 (double) bedroom 4 a large single and family bathroom with shower.

Outside there is a garage with utility area. Enclosed garden with patio ideal for entertaining, a lawn area complete with garden shed.

Unfurnished



1a Guildford Road, Frimley Green, Camberley, Surrey, GU16 6NL
Tel: 01252 834949 admin@luff-associates.com www.luff-associates.com

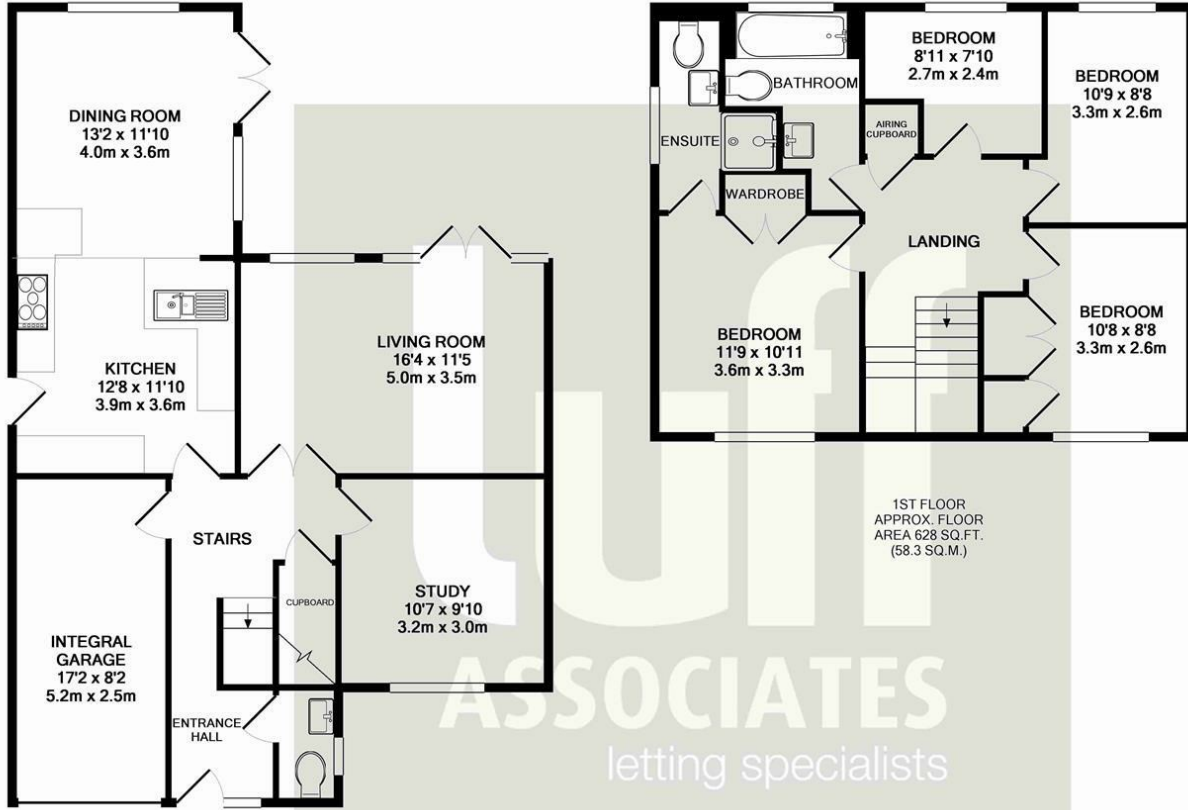

GROUND FLOOR
APPROX. FLOOR
AREA 894 SQ.FT.
(83.0 SQ.M.)

1ST FLOOR
APPROX. FLOOR
AREA 628 SQ.FT.
(58.3 SQ.M.)

TOTAL APPROX. FLOOR AREA 1521 SQ.FT. (141.3 SQ.M.)

Whilst every attempt has been made to ensure the accuracy of the floor plan contained here, measurements of doors, windows, rooms and any other items are approximate and no responsibility is taken for any error, omission, or mis-statement. This plan is for illustrative purposes only and should be used as such by any prospective purchaser. The services, systems and appliances shown have not been tested and no guarantee as to their operability or efficiency can be given
Made with Metropix ©2015

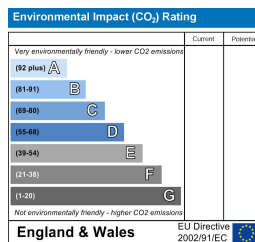
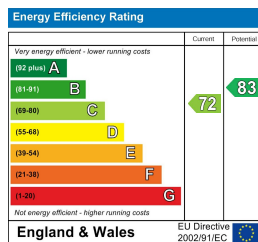

In partnership with
LUFF & WILKIN
sales 01252 838 899

Disclaimer: The Rent advertised does not include the Tenancy Deposit or any fee's or charges which are payable. Further information can be obtained from the agent or at the point of viewing. These details have been prepared and issued in good faith and do not constitute representations of fact or form part of any offer or contract Luff Associates Ltd have not carried out a structural survey of the property, nor have we tested any of the services or appliances. All measurements are intended to be approximate only and all photographs show parts of the property as they were at the time they were taken. Any reference to alterations or particular use of the property wherever stated, is not a statement that planning, building regulations or other relevant sent has been obtained