

Kingfisher Court,
Connaught Road, Fleet, GU51 3LS

£1,325 PCM



*** Available 10th June 2024***

A modern first floor apartment situated within walking distance of Fleet town centre shopping facilities and BR mainline station.

The accommodation comprises communal entrance with secure entry system, entrance hall, 17ft lounge/diner, 11ft kitchen with high and low level units plus built in appliances, two double bedrooms with ensuite shower room to master bedroom, and main bathroom with shower.

Outside there is allocated covered parking for one car with additional visitors parking spaces.

Furnished, regret NO pets

Council tax band C £1,955.23

Disclaimer; council tax charges may change yearly.



1a Guildford Road, Frimley Green, Camberley, Surrey, GU16 6NL
Tel: 01252 834949 admin@luff-associates.com www.luff-associates.com

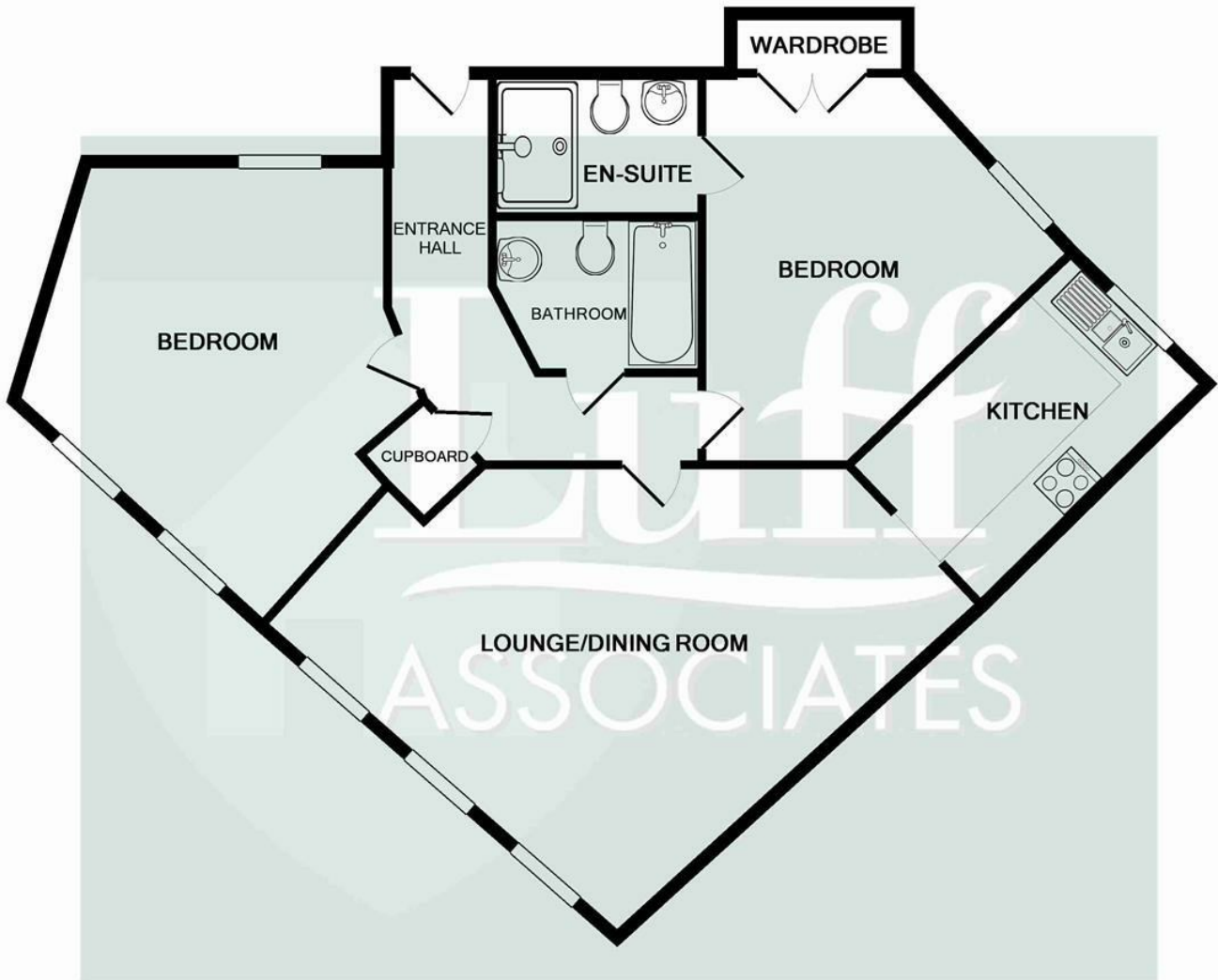

TOTAL APPROX. FLOOR AREA 835 SQ.FT. (77.5 SQ.M.)

Whilst every attempt has been made to ensure the accuracy of the floor plan contained here, measurements of doors, windows, rooms and any other items are approximate and no responsibility is taken for any error, omission, or mis-statement. This plan is for illustrative purposes only and should be used as such by any prospective purchaser. The services, systems and appliances shown have not been tested and no guarantee as to their operability or efficiency can be given

Made with Metropix ©2013

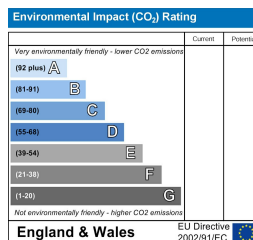
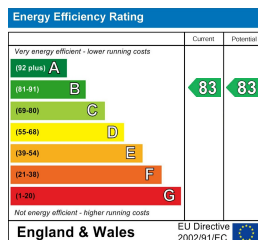

In partnership with
LUFF & WILKIN
sales 01252 838 899

Disclaimer: The Rent advertised does not include the Tenancy Deposit or any fee's or charges which are payable. Further information can be obtained from the agent or at the point of viewing. These details have been prepared and issued in good faith and do not constitute representations of fact or form part of any offer or contract Luff Associates Ltd have not carried out a structural survey of the property, nor have we tested any of the services or appliances. All measurements are intended to be approximate only and all photographs show parts of the property as they were at the time they were taken. Any reference to alterations or particular use of the property wherever stated, is not a statement that planning, building regulations or other relevant sent has been obtained