



- Three Double Bedrooms
- Garden
- Great Location
- Close transport links

Gloucester Road, Croydon, CR0 2DW

A 3 double bedroom property. Situated in an excellent area for Selhurst Train Station, local amenities, numerous bus routes and schools. This property benefits from two downstairs reception rooms, modern kitchen, utility room, modern bathroom and garden. upstairs there are three double bedrooms and a walk in closet.

EPC Rating D, Tax Band C.

Asking Price Of £359,995



Property Description

A 3 double bedroom property. Situated in an excellent area for Selhurst Train Station, local amenities, numerous bus routes and schools. This property benefits from two downstairs reception rooms, modern kitchen, utility room, modern bathroom and garden. upstairs there are three double bedrooms and a walk in closet. EPC Rating D, Tax Band C.





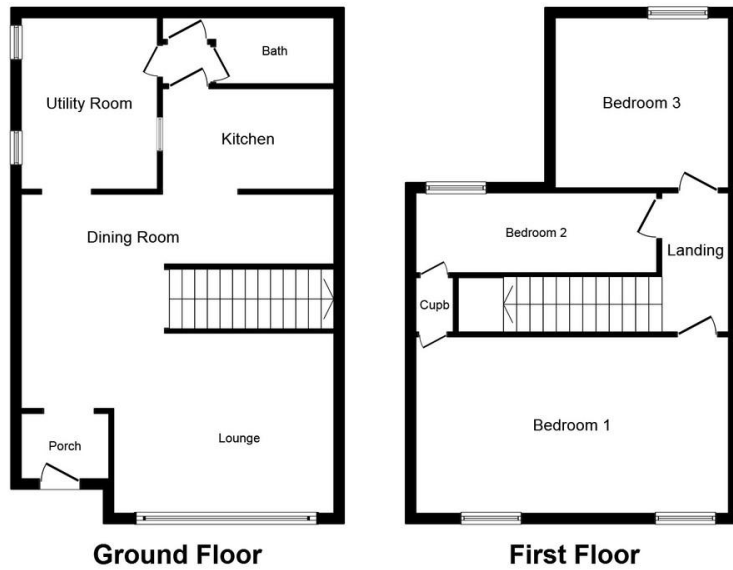

This plan is for illustration purposes only and may not be representative of the property. Plan not to scale.



%epcGraph_c_1_334%

49 Lower Addiscombe Road,
Croydon, Surrey, CR0 6PQ

www.bensonpartners.co.uk
02086670121
eastcroydon@bensonpartners.co.uk

Agents Note: Whilst every care has been taken to prepare these sales particulars, they are for guidance purposes only. All measurements are approximate are for general guidance purposes only and whilst every care has been taken to ensure their accuracy, they should not be relied upon and potential buyers are advised to recheck the measurements