

hawksbys
service & people you trust



Flat 5 Doddington Court, Wellingborough, NN8 2LE

£795 PCM



1



1



1



G



Flat 5 Doddington Court

Wellingborough, NN8 2LE

- Newly Refurbished
- Double glazing
- Refitted Bathroom
- Allocated Parking
- Smart Refitted Kitchen
- Quality Floor Coverings

Situated on Doddington road in Wellingborough is this stylish 1 bedroom first floor flat which is presented in excellent condition. The property has stylish refitted kitchen and bathroom, smart interior decor and top class floor coverings. This well presented accommodation consists of: Communal entrance, entrance hall., lounge, kitchen/diner, double bedroom and good sized bathroom. The building is quiet, has an allocated parking space and visitor parking too. View now to appreciate what is on offer here! Viewing is highly recommended to avoid disappointment.



Entrance Hall

Lounge 13'2" x 10'5" (4.01 x 3.18)

Kitchen/Diner 13'11" x 7'8" (4.24 x 2.34)

Bedroom 12'1" x 10'11" (3.68 x 3.33)

Bathroom



Directions

Floor Plans

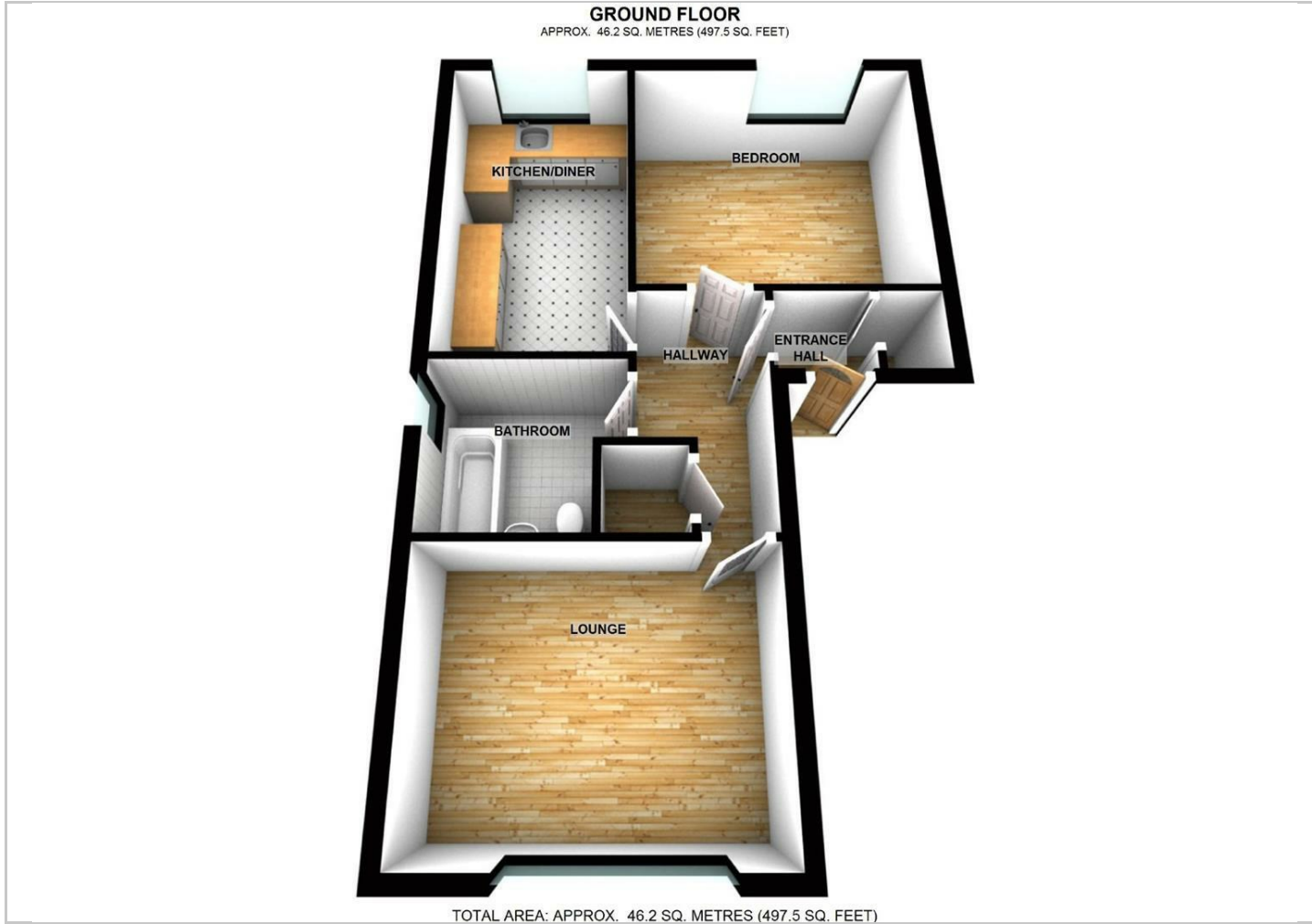

Location Map

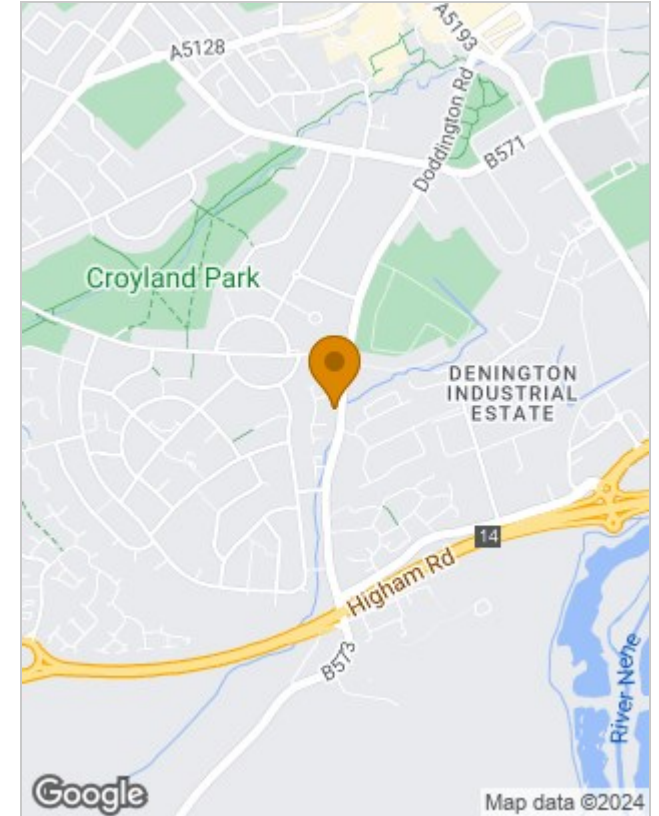

Energy Performance Graph

Energy Efficiency Rating		
	Current	Potential
Very energy efficient - lower running costs		
(92 plus) A		
(81-91) B		
(69-80) C		
(55-68) D		
(39-54) E		
(21-38) F		
(1-20) G	1	1
Not energy efficient - higher running costs		
England & Wales	EU Directive 2002/91/EC	

Viewing

Please contact our Wellingborough Office on 01933 224444 if you wish to arrange a viewing appointment for this property or require further information.

The particulars are set out as a general outline only for the guidance of intended purchasers or lessees, and do not constitute, any part of a contract. Nothing in these particulars shall be deemed to be a statement that the property is in good structural condition or otherwise nor that any of the services, appliances, equipment or facilities are in good working order. Purchasers should satisfy themselves of this prior to purchasing.