



14 Nightingale Lane, Wellingborough, NN8 4TP

£1,200 PCM



14 Nightingale Lane

Wellingborough, NN8 4TP

- PVCu Double Glazed
- New Kitchen
- Enclosed Garden
- 3 Good Size Beds
- New Carpets & Flooring

This property is really quite spacious and of particular note are the well proportioned 3 bedrooms. The property is recently refurbished and offers a 4 piece white bathroom which includes a separate shower cubicle. The kitchen is new and all the flooring in the house is new and being completely redecorated, all you need to do is move in and turn the gas warm air heating on!

There is a fence enclosed rear garden backing onto Nest Lane and PVCu double glazing completes the package. The property includes a cooker but is let FULLY FURNISHED- with white goods.



Hall

Ground Floor WC

Lounge/ Diner

21'8" x 12'2" max narrowing to 9'4" (6.60 x 3.71 max narrowing to 2.84)

Kitchen

11'3" x 10'6" inc cupboard (3.43 x 3.20 inc cupboard)

First Floor Landing

Bedroom 1 12'4" x 9'10" (3.76 x 3.00)

Bedroom 2 12'2" x 9'3" (3.71 x 2.82)

Bedroom 3 10'9" x 6'10" (3.28 x 2.08)

Bathroom





Directions





Floor Plans

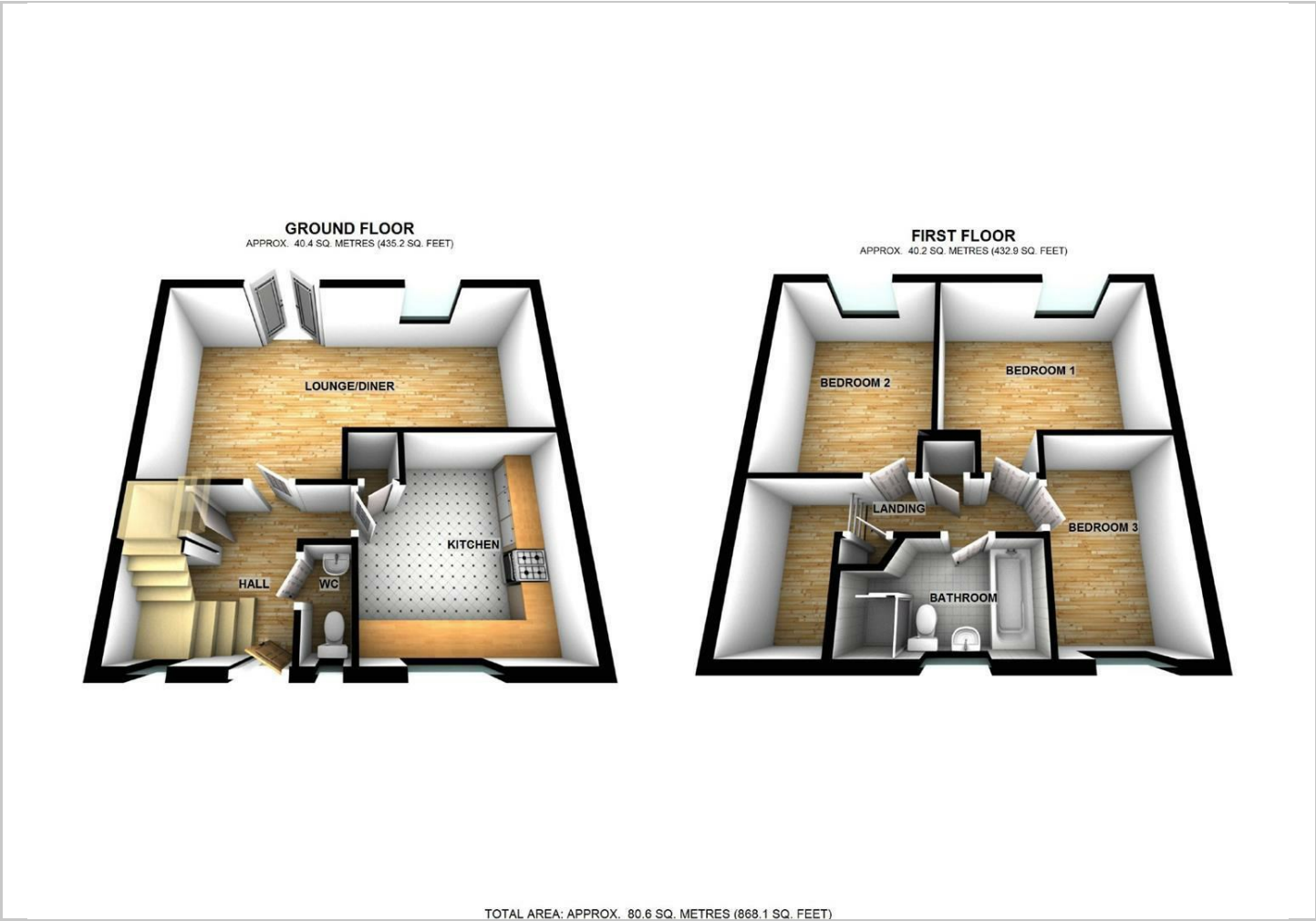

Viewing

Please contact our Wellingborough Office on 01933 224444 if you wish to arrange a viewing appointment for this property or require further information.

The particulars are set out as a general outline only for the guidance of intended purchasers or lessees, and do not constitute, any part of a contract. Nothing in these particulars shall be deemed to be a statement that the property is in good structural condition or otherwise nor that any of the services, appliances, equipment or facilities are in good working order. Purchasers should satisfy themselves of this prior to purchasing.

Location Map

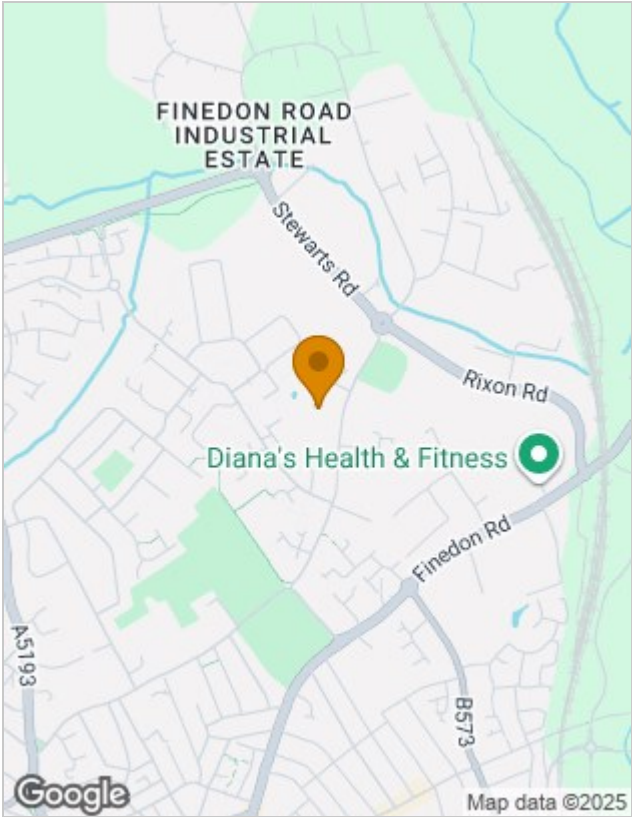

Energy Performance Graph

