



14 Meadow Close, Bricket Wood, St. Albans, AL2 3QF

Guide Price £230,000



CARTER HAYWARD  
INDEPENDENT ESTATE AGENTS





- No Chain
- Mobile Park Home
- Popular and Sought After Location
- Two Bedrooms
- Allocated Parking Space
- Close To Local Amenities
- Good Road Links
- Low Site & Pitch Fees
- Council Tax Band A

Welcome to this charming mobile home located in the popular Meadow Close, Bricket Wood, St. Albans. This delightful property boasts a cosy living room, perfect for relaxing after a long day. With two bedrooms, there is ample space ideal for downsizers. The bathroom provides convenience and comfort for everyday living.

Situated in a sought-after area, this mobile home offers a low-maintenance garden area where you can enjoy the outdoors without the hassle of extensive upkeep. The allocated parking space ensures you always have a convenient spot for your vehicle.

One of the highlights of this property is the air conditioning, a rare find in the UK, ensuring you stay cool during those warm summer days. With low pitch fees and no chain, this home is ready to move in.

Benefiting from being in council tax band A, this property is not only affordable but also conveniently located close to local amenities and good road links, making daily errands and commuting a breeze.

Don't miss out on the chance to own this lovely mobile home in a desirable location. Book a viewing today and envision the possibilities this property holds for you!







## Meadow Close AL2

Approximate Gross Internal Floor Area = 46.0 sq m / 496 sq ft

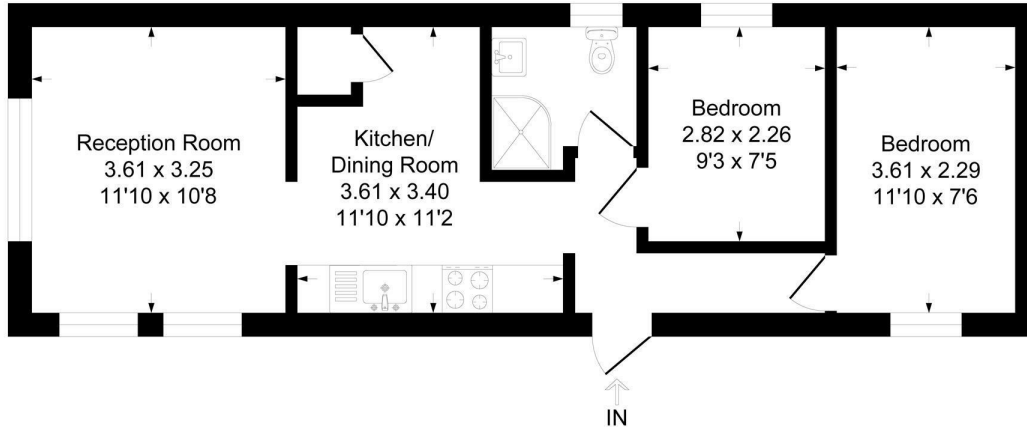

Illustration for identification purposes only, measurements are approximate, not to scale.  
Produced By Esjay Property Marketing



**CARTER HAYWARD**  
INDEPENDENT ESTATE AGENTS

119 Oakwood Road, Bricket Wood, St Albans,  
Hertfordshire, AL2 3QB  
01923 682 888 sales@carterhayward.co.uk

[www.carterhayward.co.uk](http://www.carterhayward.co.uk)

Energy Efficiency Rating		Environmental Impact (CO <sub>2</sub> ) Rating	
	Current	Potential	
<p><i>Very energy efficient - lower running costs</i></p> <p>(92 plus) <b>A</b></p> <p>(81-91) <b>B</b></p> <p>(69-80) <b>C</b></p> <p>(55-68) <b>D</b></p> <p>(39-54) <b>E</b></p> <p>(21-38) <b>F</b></p> <p>(1-20) <b>G</b></p> <p><i>Not energy efficient - higher running costs</i></p>			
<p><i>Very environmentally friendly - lower CO<sub>2</sub> emissions</i></p> <p>(92 plus) <b>A</b></p> <p>(81-91) <b>B</b></p> <p>(69-80) <b>C</b></p> <p>(55-68) <b>D</b></p> <p>(39-54) <b>E</b></p> <p>(21-38) <b>F</b></p> <p>(1-20) <b>G</b></p> <p><i>Not environmentally friendly - higher CO<sub>2</sub> emissions</i></p>			
<p><b>England &amp; Wales</b> EU Directive 2002/91/EC </p>		<p><b>England &amp; Wales</b> EU Directive 2002/91/EC </p>	