



20 Dencliffe Church Road, Ashford, TW15 2PF

£225,000

20 Dencliffe Church Road, Ashford, TW15 2PF

VERY SENSIBLE PRICE, PARKING SPACE AVAILABLE! Located in the heart of the town center, this two double-bedroom apartment offers a perfect blend of convenience and comfort. The property features a fully fitted kitchen, ideal for preparing meals with ease, and a spacious lounge designed for relaxation or entertaining. A well-appointed three-piece bathroom adds to the practicality and appeal of this home. Whether you're a first-time buyer seeking an affordable entry into the property market or an investor looking for a buy-to-let opportunity, this sensibly priced apartment ticks all the boxes.

Offered with no onward chain, this property is ready for its next owner to move in or let out with minimal hassle. Its central location ensures easy access to shops, restaurants, and excellent transport links, making it highly desirable for both homeowners and tenants. Photos provided are from a previous tenancy to showcase the apartment's potential. Don't miss the chance to view this fantastic opportunity—contact Aspen Estate Agents today to arrange your viewing!



Floor Plan

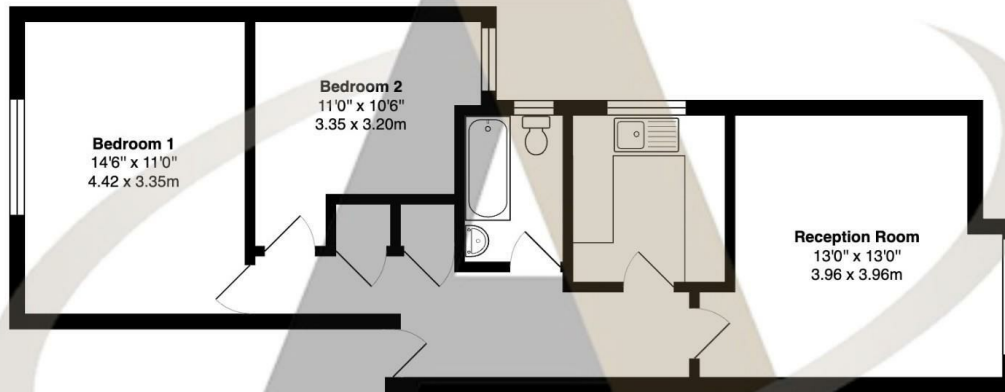

Dencliffe, Church Road, Ashford

Total Area: 669 ft² ... 62.2 m²

All measurements are approximate and for display purposes only



Features

- Parking space available on separate title
- Fitted kitchen
- Very sensible price
- Ideal first time buy or investment
- Town centre location
- Close to station
- No onward chain
- Good size

Aspen Residential Services
77 Church Road, Ashford, Surrey, TW15 2PE
Tel: 01784 252 202
Email: enquiries@aspensalesandlettings.com



Tenure - Leasehold Council Tax Band - C

