





## 14 Ashcombe Court, Ashford, TW15 3AF

Nestled on the top floor of a well-maintained, small development, this stylish apartment offers a perfect blend of comfort and convenience. Ideally located within easy reach of Ashford Town Centre and the hospital, the property benefits from secure communal entry and a welcoming entrance hall. The spacious open-plan living area is flooded with natural light and features a Juliet balcony, ideal for enjoying fresh air and views. A modern fitted kitchen comes complete with integrated appliances, making it ready for immediate use and perfect for entertaining or day-to-day living.

The apartment boasts two generous double bedrooms, including a principal bedroom with a sleek en-suite shower room, while a further modern bathroom caters to guests or family. Residents will also enjoy access to well-kept communal gardens, offering a peaceful green space to relax in. An allocated parking space ensures added convenience, making this home an ideal choice for professionals, couples, or small families looking for contemporary living in a desirable location.



Floor Plan

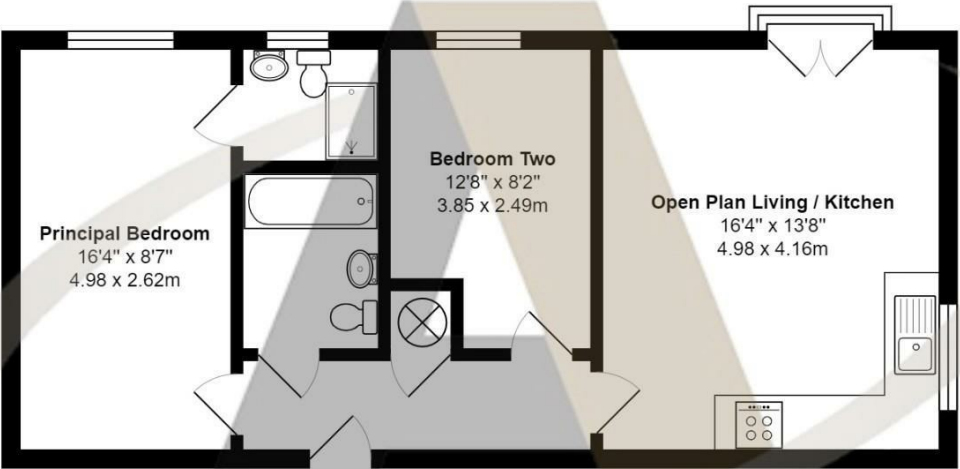

Ashcombe Court, London Road, Ashford

Total Area: 618 ft² ... 57.5 m²

All measurements are approximate and for display purposes only



Features

- Top Floor Apartment
- Master bedroom with en-suite
- Open Plan Living Room
- Two Bathrooms
- Allocated Parking
- Two Bedrooms
- Juliet Balcony
- Modern development



Tenure - Leasehold    Council Tax Band -



