



40 Littleton Road, Ashford, TW15 1UQ

£450,000

40 Littleton Road, Ashford, TW15 1UQ

This charming three-bedroom semi-detached home is nestled in a peaceful neighborhood, offering a perfect blend of comfort and convenience.

The property is ideally located within walking distance of local shops, schools, and bus routes, making it an excellent choice for families or professionals. The home features two inviting reception rooms, providing ample space for relaxation and entertaining, along with a downstairs bathroom for added convenience. The highlight of the property is the expansive rear garden, perfect for outdoor activities and gardening enthusiasts. The front garden is generously sized and offers the potential to be converted into a driveway, adding further practicality to the home.

Additionally, this property presents an exciting opportunity for future expansion, subject to the necessary planning permissions. With its attractive pricing and strong potential, this home is well-positioned for a quick sale. Don't miss the chance to make this well-maintained property your own.

For more information or to arrange a viewing, contact the vendors' chosen sole agents, Aspen, at 01784 252202.



Floor Plan

40, Littleton Road, Ashford, TW15 1UQ

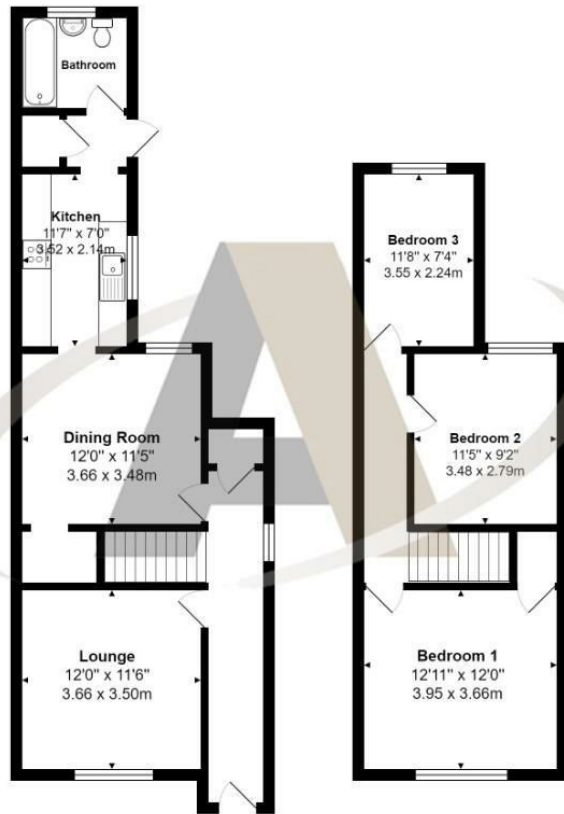

Total Area: 1047 ft² ... 97.3 m²

All measurements are approximate and for display purposes only



Features

Aspen Residential Services
77 Church Road, Ashford, Surrey, TW15 2PE
Tel: 01784 252 202
Email: enquiries@aspensalesandlettings.com

