



5 Rosa Avenue, Ashford, TW15 2ES

£450,000

5 Rosa Avenue, Ashford, TW15 2ES

A well-presented three-bedroom house situated in a quiet cul-de-sac, within walking distance of the town centre, station, recreation park with tennis courts, and Ashford's best schools. The property boasts a good-sized garden with a large garage, rear access, and an additional plot of garden beyond the garage. With potential to extend to the rear and into the loft, this home offers ample opportunity for customization to suit your needs.

The house features its own driveway with parking for two cars and is very sensibly priced for an early sale. This charming home, located in a highly sought-after area, is ideal for families looking for convenience and future growth. To arrange a viewing, call the vendors' top choice sole agents, Aspen, at 01784 252202.



Floor Plan

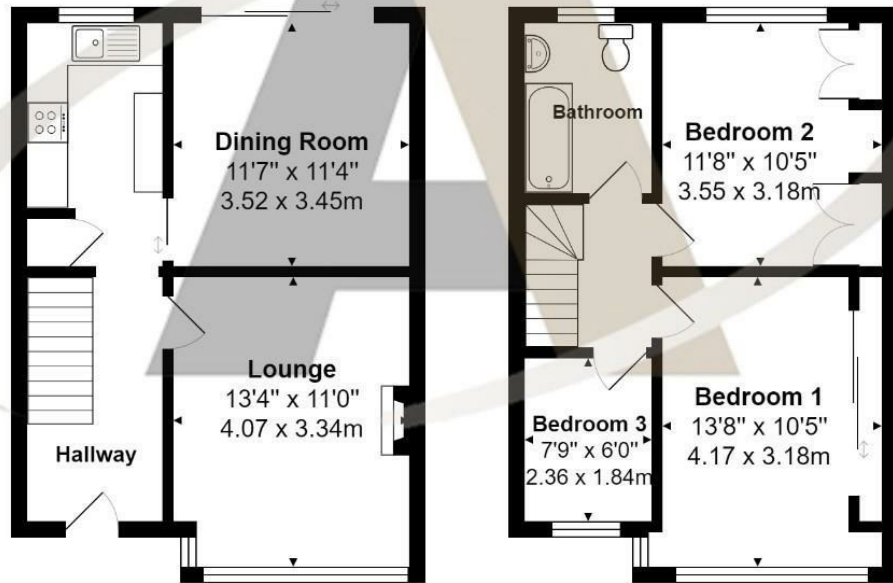
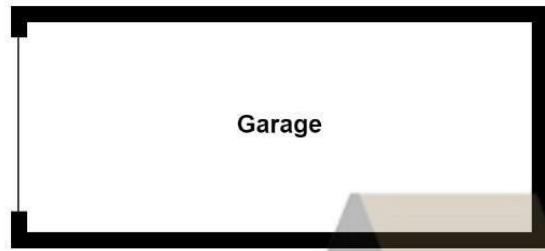

Features

- Well-presented three-bedroom house situated in a quiet cul-de-sac
- Good-sized garden with large garage and rear access
- Potential to extend to the rear and into the loft
- Ideal for families looking for convenience and future growth
- Walking distance to town centre, station, recreation park with tennis courts, and Ashford's best schools
- Additional plot of garden beyond the garage
- Own driveway with parking for two cars
- Sensibly priced for an early sale, call Aspen Estate Agents at 01784 252202 to arrange a viewing

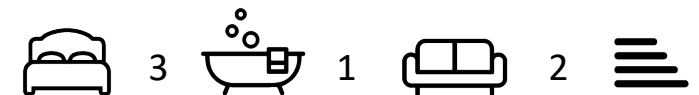



A
ASPEN
SALES & LETTINGS