



3 Maple Court, Ashford, TW15 1ST

£300,000



## 3 Maple Court, Ashford, TW15 1ST

Discover this immaculately presented two-bedroom, two-bathroom first-floor apartment, complete with its own front door entrance, located in a highly sought-after small development at the end of a quiet cul-de-sac. This prime location offers easy access to local shops, convenient bus routes, and BP's main head offices. The property features a spacious lounge with solid wood flooring, a separate kitchen, allocated parking, and beautifully maintained large communal gardens, providing a perfect blend of comfort and convenience.

With 102 years remaining on the lease and sensibly priced service charge and ground rent, this apartment is an ideal investment or first-time purchase (predicted monthly rental income of £1600 per month). The property is offered with no onward chain, ensuring a smooth and swift buying process. Don't miss out on this exceptional opportunity; to arrange a viewing, please contact the vendors' chosen sole agents at 01784 252202.



# Floor Plan

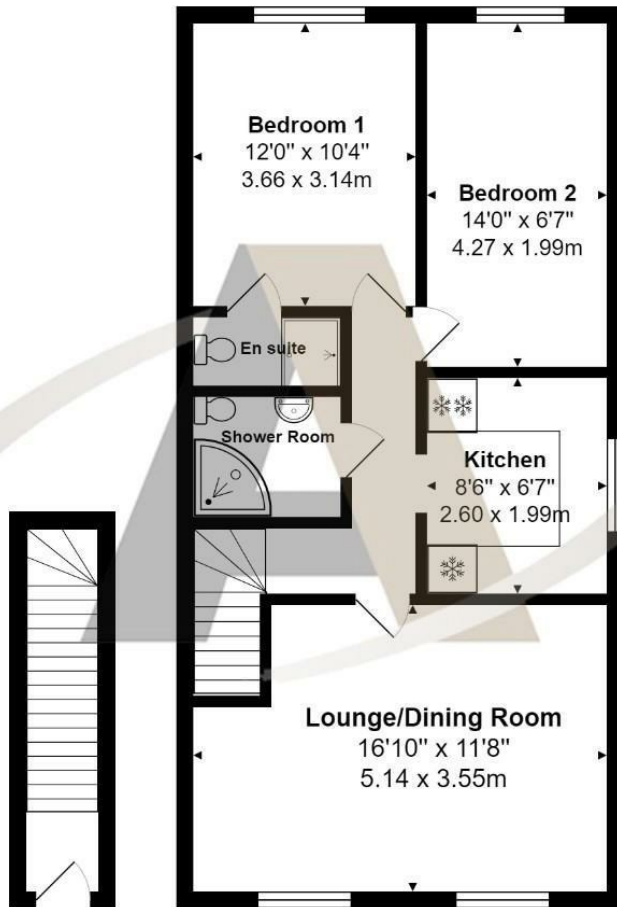

## Features

- Immaculately presented two-bedroom, two-bathroom first-floor apartment
- Located in a highly sought-after small development at the end of a quiet cul-de-sac
- 102 years remaining on the lease
- Separate, well-appointed kitchen
- Own front door for added privacy and convenience
- Prime location with easy access to local shops, bus routes, and BP's main head offices
- No onward chain, facilitating a smooth and swift buying process
- Sensibly priced service charge and ground rent, ideal for investment or first-time purchase

Aspen Residential Services  
 77 Church Road, Ashford, Surrey, TW15 2PE  
 Tel: 01784 252 202  
 Email: enquiries@aspensalesandlettings.com

