



18 Perrin Court Parkland Grove, Ashford, TW15 2GA

£190,000

18 Perrin Court Parkland Grove, Ashford, TW15 2GA

Situated in the heart of Ashford town centre is this immaculately presented first floor one double bedroom retirement apartment. This lovely property offers a very nice sized living room with a separate kitchen accessed via multi-pane glazed double doors.

The double bedroom benefits from mirrored fronted double wardrobes and there is a spacious shower room with a large shower cubicle. There are replacement electric heaters from Haverland and there is a modern replacement cylinder from Gledhill.

Perrin Court has a wonderful residents lounge and there is a communal area with Meile appliances for washing and drying. This superb apartment is offered with no onward chain and viewings are highly recommended.



Floor Plan

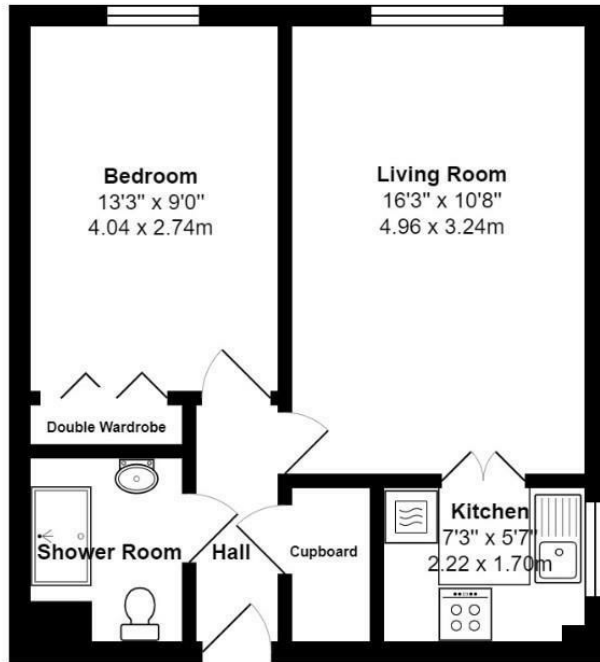

Parkland Grove, Ashford, TW15 2GA

Total Area: 451 ft² ... 41.9 m²

All measurements are approximate and for display purposes only



Features

- TOWN CENTRE LOCATION
- FIRST FLOOR RETIREMENT APARTMENT
- LOVELY SIZED LIVING ROOM
- SEPARATE KITCHEN
- DOUBLE BEDROOM WITH DOUBLE WARDROBES
- SHOWER ROOM WITH LARGE SHOWER CUBICLE
- REPLACEMENT ELECTRIC HEATERS BY HAVERLAND
- NO ONWARD CHAIN

