



9 Tawny Close, Feltham, TW13 7LH

£215,000

9 Tawny Close, Feltham, TW13 7LH

This ground-floor apartment is ideally situated in a quiet yet convenient location, close to Feltham Town Centre. The apartment features an entrance hall equipped with storage space, leading to a comfortable lounge that flows into a fitted kitchen complete with modern appliances. The double bedroom includes built-in wardrobes, offering ample storage, and the contemporary bathroom is fitted with an electric shower. This apartment would make a perfect first-time buy or investment and is sold with no onward chain. Call Aspen Estate Agents to arrange your viewing.



Floor Plan

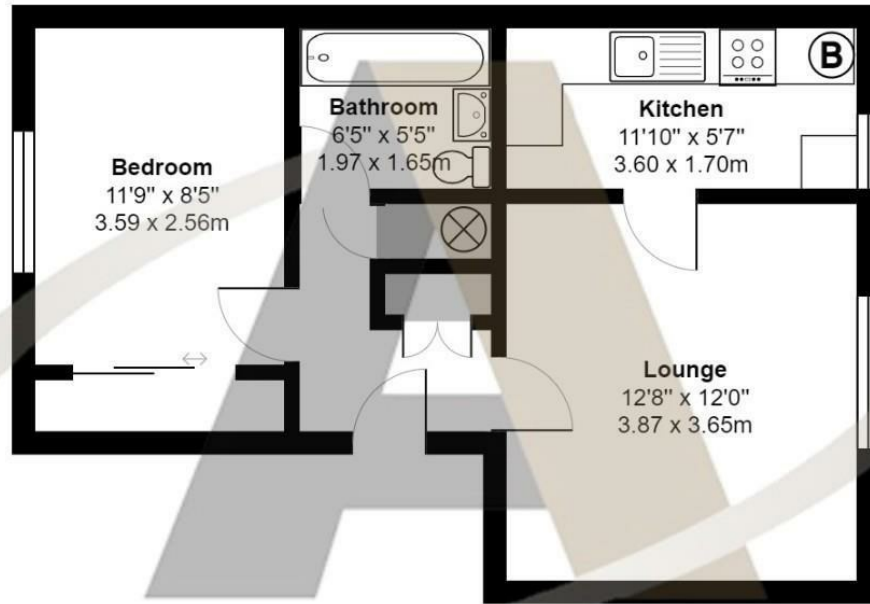

Ground Floor

Tawny Close, Feltham

Total Area: 436 ft² ... 40.5 m²

All measurements are approximate and for display purposes only



Features

- Ground Floor, One Bedroom Apartment
- Fitted Kitchen
- Built-in Wardrobes
- Bathroom
- Close to Feltham station and shops
- Double Bedroom
- Secure Entry
- Purpose Built Apartment

