



**A**  
**ASPEN**  
SALES & LETTINGS

HOW MUCH IS YOUR HOUSE WORTH?  
**A**  
**ASPEN**  
SALES & LETTINGS  
aspensaleagents.co.uk

46 Woodthorpe Road, Ashford, TW15 2RU

£425,000



## 46 Woodthorpe Road, Ashford, TW15 2RU

Nestled in the heart of central Ashford, this charming two double bedroom house offers the epitome of convenience and comfort. Boasting a prime location mere minutes away from the bustling station, vibrant town center, and esteemed educational institutions, it presents an ideal haven for families and commuters alike. Step inside to discover a spacious layout featuring a large lounge/dining room, seamlessly blending relaxation and entertainment. The addition of a conservatory infuses the home with natural light, creating a serene atmosphere for unwinding or hosting gatherings. Recently upgraded with a high-quality kitchen and bathroom, the property exudes modern elegance and functionality. Outside, a generous garden beckons for outdoor activities and al fresco dining, while the potential to extend, subject to planning permission, offers an exciting opportunity for future expansion. To experience the allure of this residence firsthand, contact the vendors chosen sole agents on 01784 252202 and arrange a viewing today.



# Floor Plan

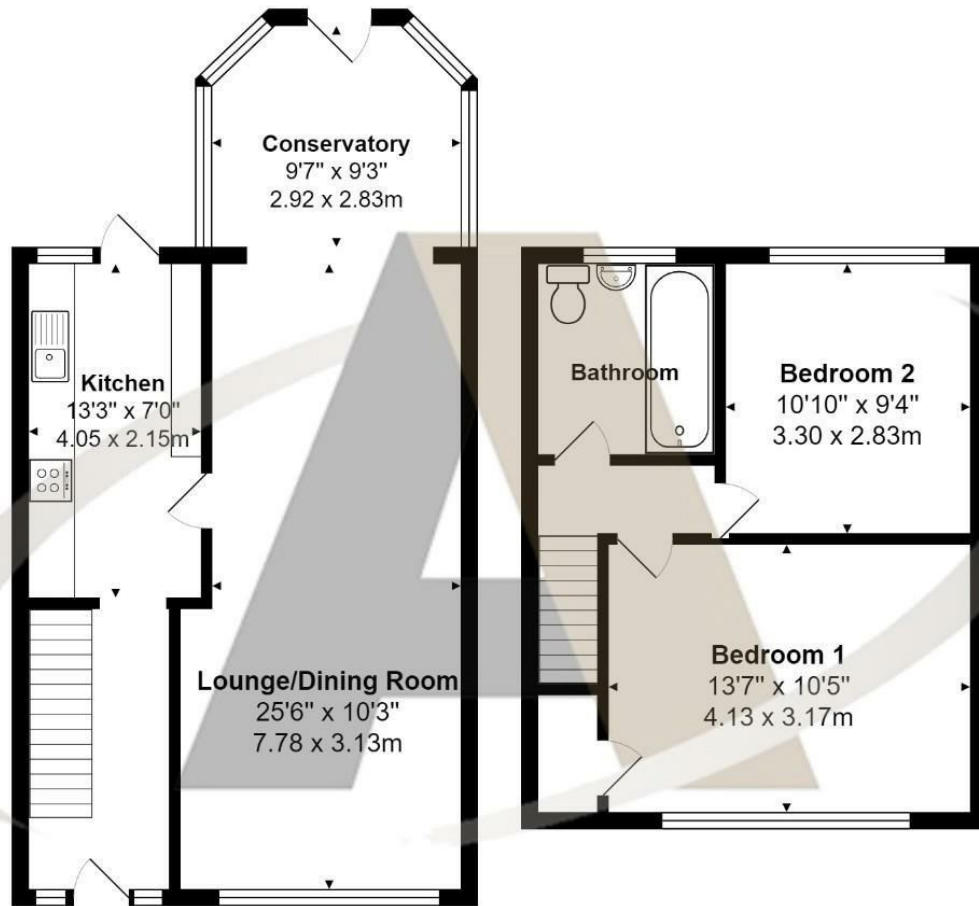

## Features

- Two Double Bedrooms
- Close to Schools
- Close To Shops
- Conservatory
- Recently Fitted Kitchen
- Close To Station
- Good Size Lounge
- Great Location





