



24 Cambridge Road, Ashford, TW15 1UF

£475,000

## 24 Cambridge Road, Ashford, TW15 1UF

Nestled in a tranquil yet sought-after neighborhood, this charming two double fronted detached bungalow offers a serene retreat within reach of urban conveniences. Boasting a prime location near local amenities and bus routes, residents enjoy seamless access to everyday essentials. The property features an exclusive driveway leading to a spacious garage, while the meticulously landscaped rear garden provides a picturesque setting for outdoor relaxation. With potential for extension, subject to planning approval, and the added convenience of no onward chain. Don't miss the chance to make this property your own – reach out to the dedicated sole agents appointed by the vendors today at 01784 252202.



# Floor Plan

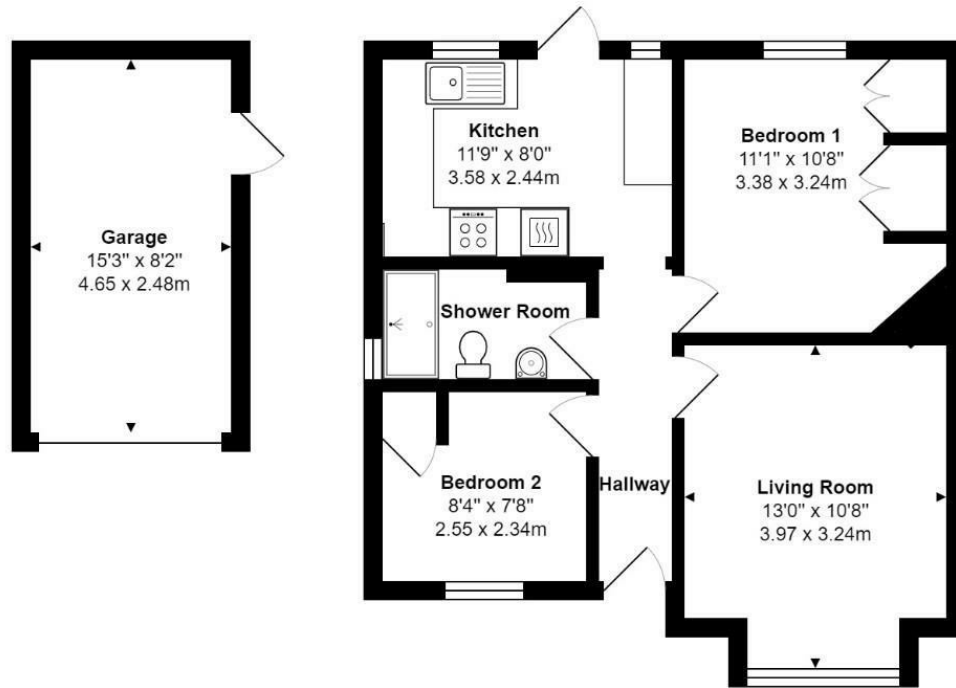

Cambridge Road, Ashford, TW15 1UF

Total Area: 637 ft<sup>2</sup> ... 59.2 m<sup>2</sup>

All measurements are approximate and for display purposes only



## Features

- Two Bedrooms
- Beautiful Garden
- Close To Shops
- Large Garage
- Quiet Location
- Potential To Extend

