



90 Kingsway, Staines-Upon-Thames, TW19 7QE

£525,000

## 90 Kingsway, Staines-Upon-Thames, TW19 7QE

A three double bedroom, three bathroom corner plot bungalow situated in one of the areas most sought after locations, within walking distance of Ashford train station, a main tesco, local school and giving easy access to the M25 and M3. The property offers flexible accommodational and is ideal for those looking for a family home or wanting to downsize and live in a premier road. Offers invited, please call the vendors chosen estate agent on 01784 252202.



# Floor Plan

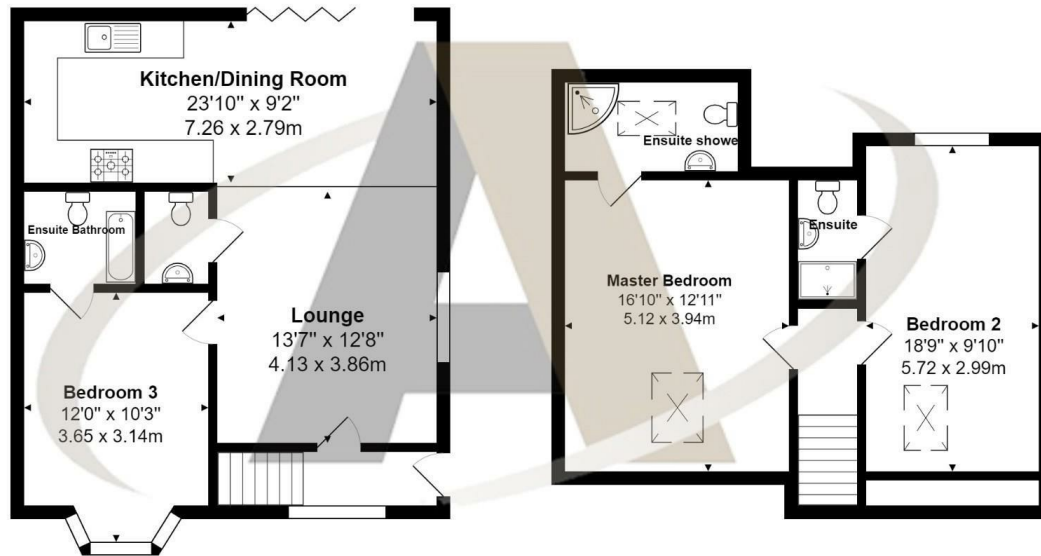

## Features

Aspen Residential Services  
77 Church Road, Ashford, Surrey, TW15 2PE  
Tel: 01784 252 202  
Email: enquiries@aspensalesandlettings.com



