



55 Fordbridge Road, Ashford, TW15 2TB

£655,000

55 Fordbridge Road, Ashford, TW15 2TB

A stunning four bedroom family home presented in fantastic condition throughout with an amazing homely feel situated on a highly regarded road convenient for easy access to the town centre, local amenities and main line station. The property features an ensuite to the master bedroom and a modern three piece family bathroom. The ground floor enjoys a dual aspect living area with a modern fitted kitchen and a utility/ laundry room with ground floor cloakroom. Externally the property enjoys a substantial garden that enjoys a high degree of privacy with off street parking to the front for several cars.



Floor Plan

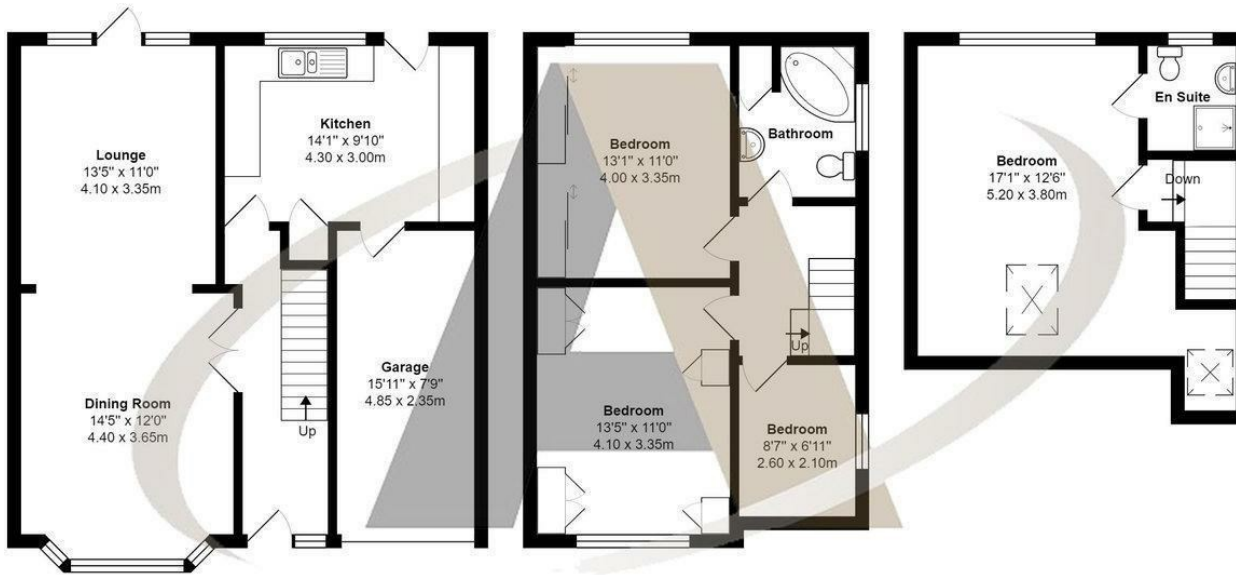

Fordbridge Road, Ashford

Total Area: 1531 ft² ... 142.2 m²
 All measurements are approximate and for display purposes only



Features

- Four Bedroom Semi Detached Home
- Stunning Condition
- Off Street Parking
- Modern Kitchen
- Close To Town Centre
- Ensuite To Master Home
- Private Rear Garden
- Desirable Location
- Utility Room
- Ground floor Cloakroom

Aspen Residential Services
 77 Church Road, Ashford, Surrey, TW15 2PE
 Tel: 01784 252 202
 Email: enquiries@aspensalesandlettings.com

