



33 Lyngrove Avenue, Ashford, TW15 1EP

£665,000

33 Lynegrove Avenue, Ashford, TW15 1EP

This very well presented four bedroom family home has been extended to provide a self contained one bedroom flat/annexe with its own rear garden. This property offers excellent versatility for a growing family, dependant relatives or even the possibility of rental income. Situated on a prominent corner position in a highly regarded residential area with ample parking to the front. A rare opportunity and highly recommended for the purchaser looking for two homes in one!



Floor Plan

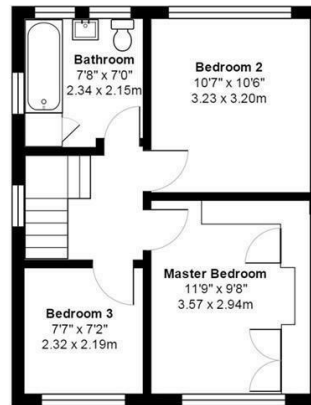

All measurements are approximate and for display purposes only



Features

- Extended Semi Detached Family Home
- Ample Parking
- Stunning Condition Throughout
- Modern Kitchens & Bathrooms
- South Facing Garden
- Self Contained One Bedroom Annexe
- Four Bedrooms
- Desirable Residential Location

Aspen Residential Services
77 Church Road, Ashford, Surrey, TW15 2PE
Tel: 01784 252 202
Email: enquiries@aspensalesandlettings.com

