



22 Perrin Court Parkland Grove, Ashford, TW15 2GA

£200,000

22 Perrin Court Parkland Grove, Ashford, TW15 2GA

Situated in the heart of Ashford centre with all of its shops and facilities is this very well presented one bedroom first floor retirement apartment. The property has been completely redecorated and the carpets have also been replaced. The kitchen has a built in oven and hob, the bedroom benefits from twin fitted double wardrobes and there is a very handy and deep storage cupboard with light and fitted shelving. The ground floor of Perrin Court houses a very good sized residents lounge and there is also a communal area fitted with Miele washing machines and dryers. The apartment is offered with no onward chain.



Floor Plan

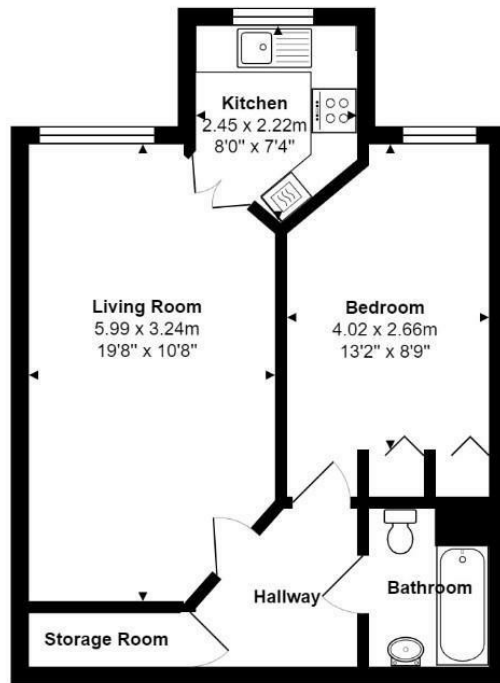

Perrin Court, Parkland Grove,
Ashford, TW15 2GA

Total Area: 45.0 m² ... 484 ft²

All measurements are approximate and for display purposes only



Features

- Retirement Apartment
- One Bedroom
- Bathroom
- Redecorated
- First Floor
- Kitchen With Oven And Hob
- Large Storage Cupboard
- No Chain



