



10 Spencer Gardens, Egham, TW20 0JN

This family home is situated in a quiet residential road in the picturesque village of Englefield Green and owned by the same family since new, in 1983! Englefield Green borders Windsor Great Park with central Windsor (approx. 4.7 miles away). Day to day shopping amenities are available in the village and nearby Egham, with its Station about 1.1 miles, giving direct rail connections to London Waterloo (approx. 44 mins). The M25 is available via Junction 13 in a 5-6 minute drive.

The property's well laid out accommodation is welcoming and ideal for entertaining and family life, with the spacious living room connecting with both the conservatory and dining room. The conservatory brings the lovely, secluded garden into play, with many different aspects to enjoy, whilst the dining room is adjacent to the kitchen and could be easily combined/knocked through for those preferring a more 'open-plan' lifestyle. If you work from home the study will be a welcome bonus and there is also a cloakroom completing the ground floor accommodation.

The first floor's master bedroom has en suite dressing room & bathroom and there are a further three bedrooms and a family bathroom.

To the front of the property is a huge garden area with lawn & shrubs and the driveway provides parking and access to the Double Garage. To the rear of the house is a larger than expected tiered garden with lots of interest and views out towards the London skyline.

Sporting and leisure facilities in the area include golf at Wentworth and Sunningdale; racing at Ascot and Windsor; tennis at Coopers Hill Tennis Club and various gyms and leisure facilities within a short drive. Beautiful walks abound locally with the River Thames at Runnymede, Virginia Water Lake, Savill Gardens and Windsor Great Park close to hand. Schooling in the area includes Bishopsgate School, St. John's Beaumont, St. Mary's, Heathfield, St. George's, Papplewick and the Marist Convent. Good state school is also close by, EPC Rating: C.



Floor Plan

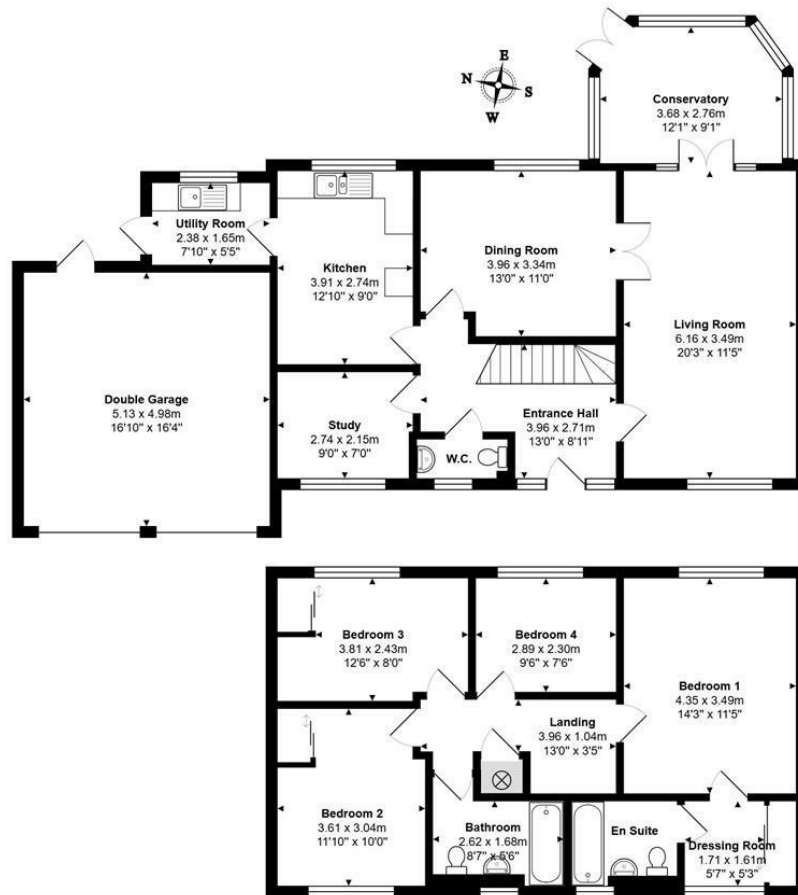

Total Area: 170.5 m² ... 1835 ft²



Features

- Four Bedroom Detached
- Three Reception Rooms
- En Suite Dressing Room
- Family Bathroom
- Lovely Front & Rear Garden
- Quiet Residential Road
- Downstairs Cloakroom
- En Suite Bathroom
- Kitchen & Utility Room
- Double Width Garage

10 St Judes Road, Englefield Green, Surrey TW20 0BY
Tel 01784 433696
sales@aspenestateagents.co.uk

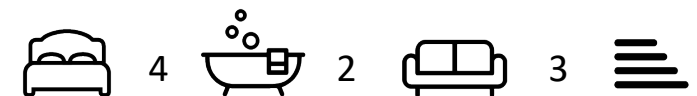

Tenure - Freehold Council Tax Band -

