



41 Park Street, Slough, SL1 1PS

£2,400

41 Park Street, Slough, SL1 1PS

This carefully extended property has been recently renovated and is offered to the market unfurnished and available mid May. The welcoming space includes three double bedrooms, two good size receptions and two modern bathrooms, both with shower over bath. The kitchen is fully fitted with washing machine, fridge freezer and gas hob. Outside boasts a tranquil private back garden and off street parking at the front. All this in easy access to local amenities such as Slough town centre and Elizabeth Line tube station. Enquire now to get a viewing slot as we still have limited availability. EPC rating C.



Floor Plan

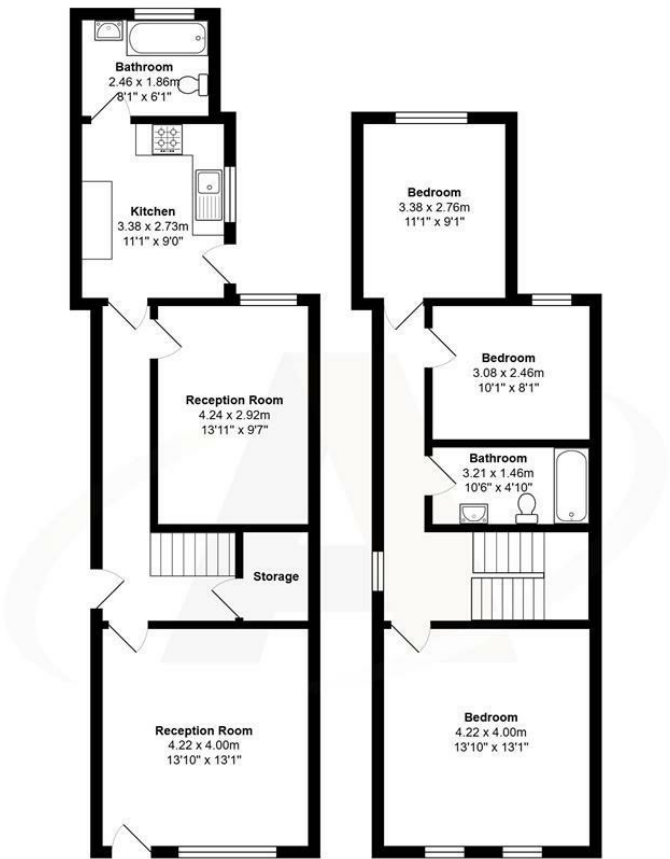

Park Street, Slough

Total Area: 108.4 m² ... 1167 ft²

All measurements are approximate and for display purposes only



Features

10 St Judes Road, Englefield Green, Surrey TW20 0BY
Tel 01784 433696
sales@aspenestateagents.co.uk



3



2



2



C

Tenure - Council Tax Band - D

