



56 Northcroft Road, Englefield Green, TW20 0EA

This very attractive four bedroom semi-detached Victorian villa is situated on the popular Northcroft Road with stunning views over many acres of paddocks and fields immediately behind the westerly aspect rear garden. These views and amazing sunsets can be enjoyed from both the decking area and the balcony off the third bedroom!

The accommodation comprises a gorgeous kitchen/dining room with flagstone floor and bi-fold doors that open up onto the rear garden with those incredible views beyond, utility room, cloakroom, double size lounge with open fireplace and a playroom/office on the ground floor; with a landing, four bedrooms (master with superb en suite wet room) and a modern family bathroom on the first floor.

The good size loft could also lend itself to further accommodation (subject to any necessary planning/building regulation approval) and would be ideal for a new master suite from which to enjoy those wonderful views!

Old and new work seamlessly together with character features such as sash windows and ornate ceilings blending with the modernity of lovely bathrooms, gas central heating to radiators and off road parking for 2 cars.

The village green and popular Barley Mow are only a 5 minute walk and Virginia Water, Savill Gardens and Windsor Great Park are all within easy reach and offer the chance of horse riding along with some of the most beautiful walks and bicycle rides in the area.

For commuters, Egham train station is about 1.25 miles and J13 of the M25 can be reached in under a 10 minute drive, giving easy access to the M3, M4 & M40 motorways. Heathrow Airport can also be reach within a 15-20 minute drive.

This would make an ideal family house, or for those looking to downsize without much compromise, with the almost unique feature of enjoying some of the most wonderful views and sunsets the village has to offer! EPC Rating: D.



Floor Plan

Northcroft Road, Englefield Green

Approximate Gross Internal Area
Ground Floor = 892 sq ft / 82.9 sq m
First Floor = 627 sq ft / 58.2 sq m
Total = 1519 sq ft / 141.1 sq m

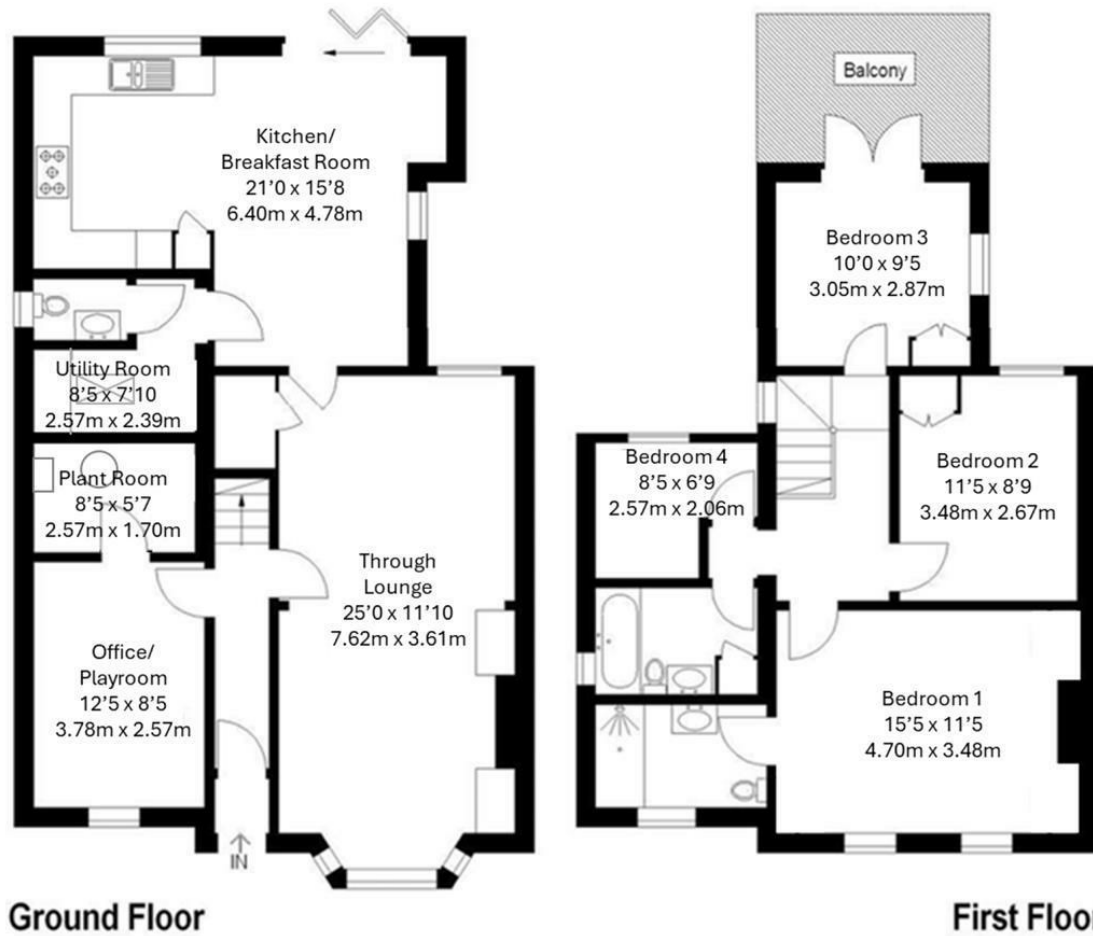

Features

- 4 Bedroom Character Semi
- Double Size Living Room
- Playroom/Office
- Modern Fitted En Suite & Family Bathroom
- Off Road Parking
- Stunning Views over Fields
- Large Kitchen/Breakfast Room
- Utility Room & Cloakroom
- South West Facing Garden & Balcony
- Loft Conversion Potential

10 St Judes Road, Englefield Green, Surrey TW20 0BY
Tel 01784 433696
sales@aspenestateagents.co.uk

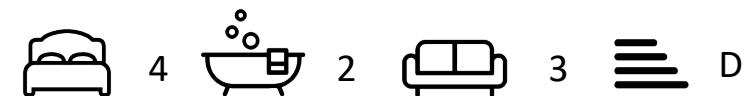

Tenure - Freehold Council Tax Band - E

