



1 Middle Hill, Englefield Green, TW20 0JQ

£785,000

1 Middle Hill, Englefield Green, TW20 0JQ

Situated in the sought-after Middle Hill of Englefield Green, this impressive 4-bedroom detached house, originally constructed circa 1700, has undergone extensive renovations to blend historic charm with modern comfort. Boasting a blend of period features and contemporary enhancements, this residence offers versatile living spaces ideal for family life. The ground floor showcases a spacious Living Room with seamless access to the well-appointed kitchen and utility room, perfect for entertaining or daily gatherings. Additionally, a further reception room with bi-folding doors opens onto the pretty rear garden. Upstairs, four bedrooms await, each equipped with built-in storage. The master bedroom features an ensuite shower room, while a family bathroom serves the remaining bedrooms. Outside, the property features a delightful south-westerly aspect rear garden, offering a picturesque retreat, alongside off-road parking at the front.

Nestled in a highly desirable residential locale, Middle Hill affords easy access to renowned local schools, Egham station, and an array of amenities including Waitrose, Starbucks, and the Everyman cinema in Egham. With its historic origins, modern updates, and convenient surroundings, this property presents an exceptional opportunity to relish the best of village living while enjoying the comforts of a contemporary family home in this coveted area of Englefield Green. There is so much to admire in this property it should be viewed to be appreciated. Contact Aspen Estate Agents to arrange your viewing.



Floor Plan

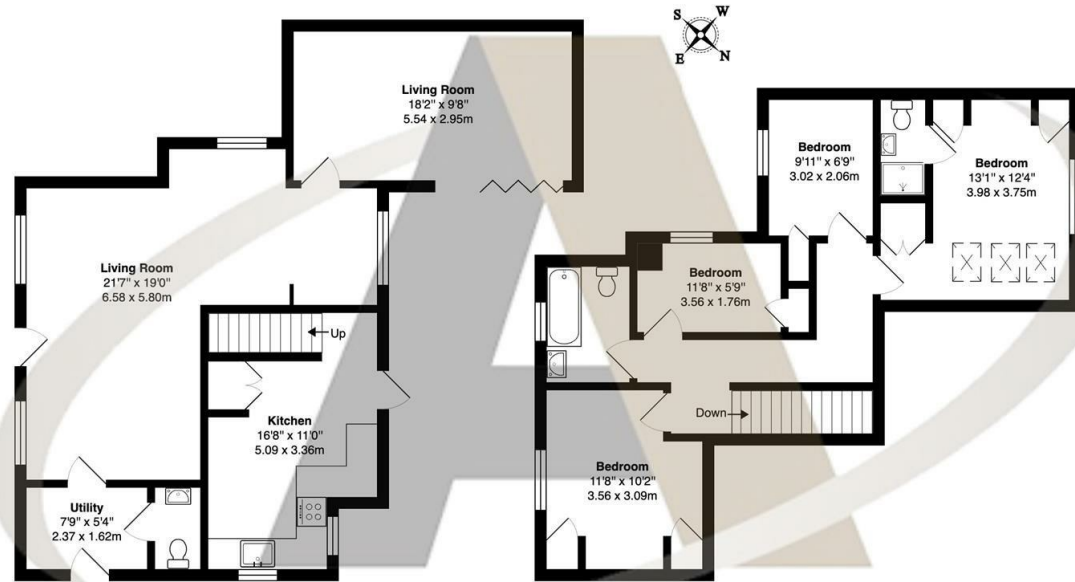

Middle Hill, Englefield Green

Total Area: 1292 ft² ... 120.0 m²

All measurements are approximate and for display purposes only



Features

- Extensively renovated 4-bedroom detached house, originally built circa 1700
- Versatile living spaces ideal for family life
- Additional reception room with bi-folding doors opening onto a pretty rear garden
- Master bedroom features an ensuite shower room; family bathroom serves the remaining bedrooms
- Off road parking
- Seamless blend of historic charm and modern comforts
- Spacious living room with access to the well-appointed kitchen and utility room
- Four bedrooms, each with built-in storage
- Popular location close to amenities

10 St Judes Road, Englefield Green, Surrey TW20 0BY
 Tel 01784 433696
 sales@aspenestateagents.co.uk

