



Norfolk Close, Warsop, Mansfield, NG20 0EZ

- 3 (bedroom icon)
- 1 (bathroom icon)
- 1 (carport icon)
- EPC C

£825 PCM

PINWOOD



Norfolk Close Warsop Mansfield NG20 0EZ



£825 PCM

**3 bedrooms
1 bathroom
1 reception**

- Three bedrooms
- End of terraced town house
- Modern fitted kitchen
- Neutral decor
- Gas central heating
- Bathroom with tub and shower
- Fitted carpet and laminate
- Enclosed rear garden
- Bond £980
- Tax Band A





Welcome to this charming property located in Norfolk Close, Warsop, Mansfield. This delightful end town house boasts a lovely façade that is sure to catch your eye.

Upon entering, you are greeted by a spacious lounge, perfect for relaxing or entertaining guests. The dining kitchen offers a wonderful space to prepare and enjoy meals with your loved ones.

This property features three cosy bedrooms, ideal for a growing family or those in need of extra space. The tiled bathroom adds a touch of elegance to the home.

Outside, you will find a rear garden complete with a patio and lawn, providing a lovely outdoor area to enjoy during the warmer months.

With parking available for one vehicle, convenience is at your doorstep. Don't miss the opportunity to make this house your home and create lasting memories in this wonderful property.

If you would like to view this property, or apply for it, please click the 'Request Details' button on Rightmove and enter your information

Entrance Hall

Having some storage, a uPVC door, laminate flooring and a central heating radiator.

Lounge

With a bow window to the front aspect, neutral decor, a central heating radiator and a fitted carpet.

Kitchen

An attractive kitchen with a dining area. With base and eye level units, integrated gas hob, oven and grill with extractor over. There is an integrated freezer and space for a washing machine. There is a uPVC window looking over the rear garden and double doors.

Bedroom 1

With uPVC window, neutral decor, laminate flooring and a central heating radiator.

Bedroom 2

With uPVC window, neutral decor, laminate flooring and a central heating radiator.

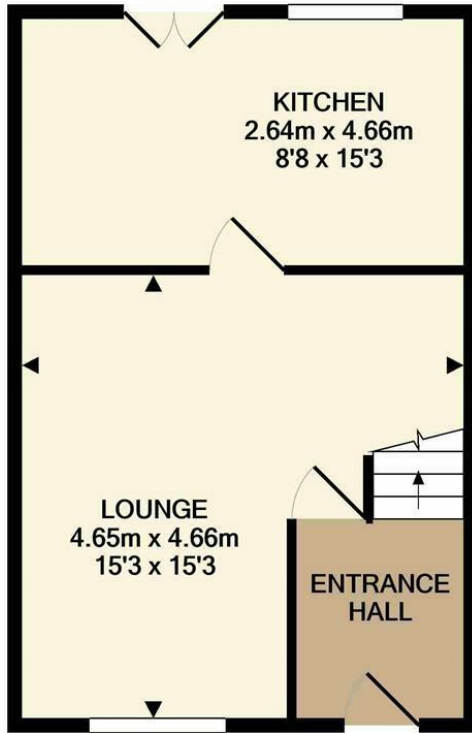

GROUND FLOOR

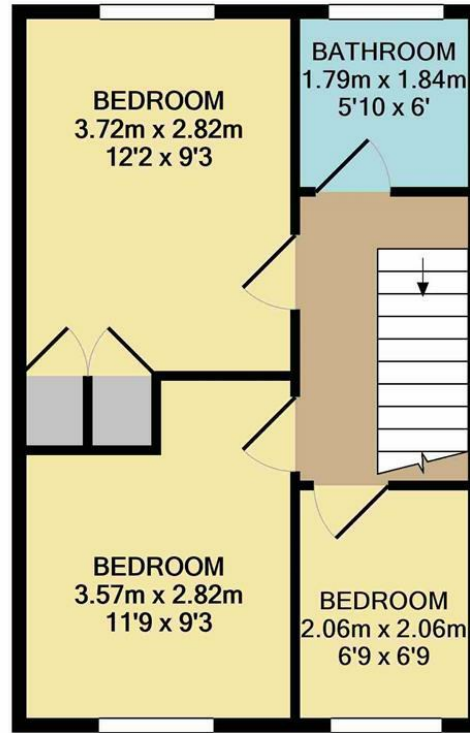

1ST FLOOR

Whilst every attempt has been made to ensure the accuracy of the floor plan contained here, measurements of doors, windows, rooms and any other items are approximate and no responsibility is taken for any error, omission, or mis-statement. This plan is for illustrative purposes only and should be used as such by any prospective purchaser. The services, systems and appliances shown have not been tested and no guarantee as to their operability or efficiency can be given

Made with Metropix ©2020

Bedroom 3

With uPVC window, neutral decor, laminate flooring and a central heating radiator.

Bathroom

A fully tiled three piece bathroom with bath tub, electric shower, pedestal wash basin and low flush w/c

Garden

The rear has a patio area from the double doors, a laid lawn and a free standing shed.

Other Information

Council Tax Band 'A'

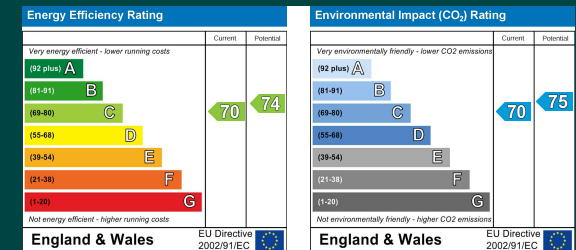

Mansfield branch
24 Albert Street
Mansfield, NG1
01623 621001

Clowne branch
26 Mill Street,
Clowne, S43 4JN
01246 810519

Clay Cross branch
20 Market Street,
Clay Cross, S45 9JE
01246 251194

Chesterfield branch
33 Holywell Street,
Chesterfield, S41 7SA
01246 221039

PINEWOOD

