

PINEWOOD



Greenwood View, Creswell, Worksop, South Yorkshire S80 4WD

 3  2  1  EPC B

£240,000



Welcome to Greenwood View, a stunning detached house located in the charming village of Creswell, Worksop. This modern property, built in 2020, offers a perfect blend of style and comfort.

As you step inside, you are greeted by a modern breakfast kitchen is equipped with top-of-the-line appliances, making it a dream for any aspiring chef, leading to a spacious lounge adorned with elegant bi-fold doors, allowing natural light to flood the room.

With three bedrooms, including a luxurious Master Bedroom with an ensuite, and a beautiful family bathroom, this home provides ample space for a growing family or those who love to entertain guests.

One of the highlights of this property is the large ground floor WC, adding convenience and practicality to everyday living. Additionally, the parking space for two vehicles ensures that you never have to worry about finding a spot for your car.

If you are looking for a contemporary home that offers both style and functionality, look no further than this gem in Greenwood View. Don't miss the opportunity to make this house your home sweet home.

To arrange your viewing, please call **PINEWOOD PROPERTIES**.

- THREE BEDROOM DETACHED
- SPACIOUS LOUNGE WITH BI-FOLD DOORS
- MASTER BED WITH ENSUITE
- POPULAR RESIDENTIAL LOCATION, CLOSE TO LOCAL AMENITIES
- COUNCIL TAX BAND: C
- MODERN KITCHEN WITH INTEGRATED APPLIANCES
- STUNNIG BATHROOM
- FULLY ENCLOSED REAR GARDEN
- DRIVEWAY FOR TWO CARS
- FREEHOLD

ENTRANCE

Having a composite style front door and some fitted storage behind double doors, with laminate flooring and a central heating radiator.

KITCHEN / DINER

13'7" x 9'10" (4.15 x 3.00)

A very practical and modern Kitchen / Diner to the front aspect with fitted appliances and a combination of slab and high gloss door and drawer fronts giving a contemporary feel with a lovely fitted square edge worktop with integrated hob, stainless steel sink with quarter bowl and drainer with an upstand and tiled splash backs. Adjacent are lovely high gloss units with an integrated Oven, Microwave and a Fridge / Freezer. With a lovely uPVC window and finished with a quality laminate floor.

GROUND FLOOR WC

The space here may surprise you, with lovely tiles, a large mirror, close coupled WC and wash basin.

LOUNGE

10'9" x 16'4" (3.30 x 4.98)

The lounge faces the rear garden with laminate flooring, a central heating radiator and Bi-fold doors that open the room up to the garden.

MASTER BEDROOM

12'0" x 8'11" (3.66 x 2.74)

With a rear aspect window overlooking the garden, a central heating radiator, fitted carpet, fitted wardrobes and access to the Ensuite.

ENSUITE

With lovely tiles, a walk in shower, porcelain suspended sink, a close coupled WC and chrome towel radiator.

BEDROOM TWO

15'7" x 8'11" (4.75 x 2.74)

With some room behind the door for a wardrobe and a having a front facing uPVC window, a central heating radiator and a fitted carpet.

BEDROOM THREE

8'11" x 6'11" (2.72 x 2.13)

A further double bedroom to the front aspect with a uPVC window, a central heating radiator and fitted carpet.

FAMILY BATHROOM

6'6" x 6'9" (2.00 x 2.06)

With lovely tiles, a bath tub with mixer shower with taps fitted to the tiled and includes a standard shower head integrated to the bath and a rain head shower with screen. a porcelain wash basin and close coupled WC.

OUTSIDE

With off road parking to the front and a rear aspect garden with some patio stone from the exit of the lounge to a laid lawn area.

DISCLAIMER

These particulars do not constitute part or all of an offer or contract. While we endeavour to make our particulars fair, accurate and reliable, they are only a general guide to the property and, accordingly. If there are any points which are of particular importance to you, please check with the office and we will be pleased to check the position.



GROUND FLOOR
43.2 sq.m. (465 sq.ft.) approx.

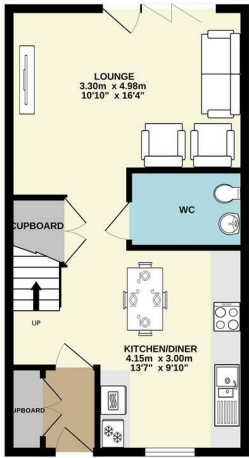

1ST FLOOR
43.2 sq.m. (465 sq.ft.) approx.



TOTAL FLOOR AREA: 86.4 sq.m. (920 sq.ft.) approx.
Whilst every effort has been made to ensure the accuracy of the figures contained here, measurements of plots, sections, areas and any other items are approximate and are not intended to be used as a basis for any contract or other statement. The plans are for illustrative purposes only and should be used as such for any prospective purchaser. The services, systems and appliances shown have not been tested and no guarantee as to their operability or efficiency can be given.
Made with Maptive 10/22



Energy Efficiency Rating		Current	Potential
Very energy efficient - lower running costs			
(92 plus) A			94
(81-91) B		83	
(69-80) C			
(55-68) D			
(39-54) E			
(21-38) F			
(1-20) G			
Not energy efficient - higher running costs			
England & Wales	EU Directive 2002/91/EC		

Environmental Impact (CO ₂) Rating		Current	Potential
Very environmentally friendly - lower CO ₂ emissions			
(92 plus) A			
(81-91) B			
(69-80) C			
(55-68) D			
(39-54) E			
(21-38) F			
(1-20) G			
Not environmentally friendly - higher CO ₂ emissions			
England & Wales	EU Directive 2002/91/EC		

DISCLAIMER

GENERAL - Whilst Pinewood Property Estates endeavour to make our sales particulars accurate they do not constitute or form part of an offer or any contract and none are to be relied upon as statements of representation or fact. Please be advised that some of the particulars may be awaiting vendor approval. If you require clarification or further information on any points, please contact Pinewood Properties, especially if you are travelling some distance to view.

SERVICES, SYSTEMS AND APPLIANCES listed in this advertisement have not been tested by Pinewood Property Estates and no guarantee as to their operating ability or efficiency is given. We strongly advise prospective buyers to commission their own survey or service reports before finalising their offer to purchase.

MEASUREMENTS have been taken as a guide to prospective buyers only, and are not precise. You must verify the dimensions carefully before ordering carpets or any built-in furniture.

FIXTURES AND FITTINGS may be mentioned in the advertisement but all these may not be included in the sale and are to be agreed with the seller.

MONEY LAUNDERING REGULATIONS - Intending purchasers will be asked to produce identification documentation at a later stage and we would ask for your co-operation in order that there will be no delay in agreeing the sale.

You may download, store and use the material for your own personal use and research. You may not republish, retransmit, redistribute or otherwise make the material available to any party or make the same available on any other website

Mansfield branch
24 Albert Street
Mansfield, NG1
01263 621001

Clowne branch
26 Mill Street,
Clowne, S43 4JN
01246 810519

Clay Cross branch
20 Market Street,
Clay Cross, S45 9JE
01246 251194

Chesterfield branch
33 Holywell Street,
Chesterfield, S41 7SA
01246 221039

PINEWOOD

