

PINEWOOD



Beckett Avenue, Mansfield, Nottinghamshire NG19 6BX

 3  1  2  EPC D

Offers In The Region Of £200,000



Welcome to Beckett Avenue, Mansfield, Nottinghamshire - a charming location that could be your next investment opportunity- Selling with Tenant in Situ! This delightful semi-detached house boasts 2 reception rooms, 3 bedrooms, and 1 bathroom, offering a cosy and comfortable living space spread across 923 sq ft.

Convenience is key with parking available for 1 vehicle, ensuring you never have to worry about finding a spot after a long day out. Whether you're looking to settle down or make a smart investment, this property has it all.

Currently housing a long-term tenant paying £700 per calendar month, this could be the perfect chance for you to step into the world of property investment with ease. Imagine the potential this property holds for you - a steady rental income and a promising future.

Don't miss out on this fantastic opportunity to own a piece of Mansfield. Book a viewing today.

- THREE BEDROOM SEMI-DETACHED INVESTMENT OPPORTUNITY
- GALLEY KITCHEN
- FAMILY BATHROOM
- GAS BOILER CENTRAL HEATING
- COUNCIL TAX BAND: A
- TWO RECEPTION ROOMS
- OUTBUILDING UTILITY
- UPVC
- OFF STREET PARKING AND LOVELY GARDEN
- FREEHOLD

PORCH

To the front aspect with a uPVC door leading to the entrance porch perfect for coats and cloak storage.

ENTRANCE HALL

A traditional entrance hall leading to both reception rooms and the kitchen.

LOUNGE

Currently set up to the rear of the property with a garden facing uPVC window, laminate flooring, a central heating radiator and a feature fireplace with electric fire.

DINING ROOM

Currently set up to the front of the property with a large bay window, a central heating radiator, a feature fireplace with electric fire and laminate flooring.

KITCHEN

A practical galley style kitchen to the rear of the property.

UTILITY ROOM

An outbuilding to the rear with a Baxi central heating boiler and space for a dryer.

BEDROOM ONE

A spacious double bedroom to the front aspect of the property.

BEDROOM TWO

A spacious double bedroom to the rear aspect of the property.

BEDROOM THREE

A single bedroom to the front aspect of the property.

FAMILY BATHROOM

A tiled family bathroom with a bath tub, pedestal wash basin and low flush WC.

OUTSIDE

Off street parking to the front aspect leading to a gated rear enclosed garden with patio areas and lawns.

DISCLAIMER

These particulars do not constitute part or all of an offer or contract. While we endeavour to make our particulars fair, accurate and reliable, they are only a general guide to the property and, accordingly. If there are any points which are of particular importance to you, please check with the office and we will be pleased to check the position.



GROUND FLOOR
45.0 sq.m. (485 sq.ft.) approx.

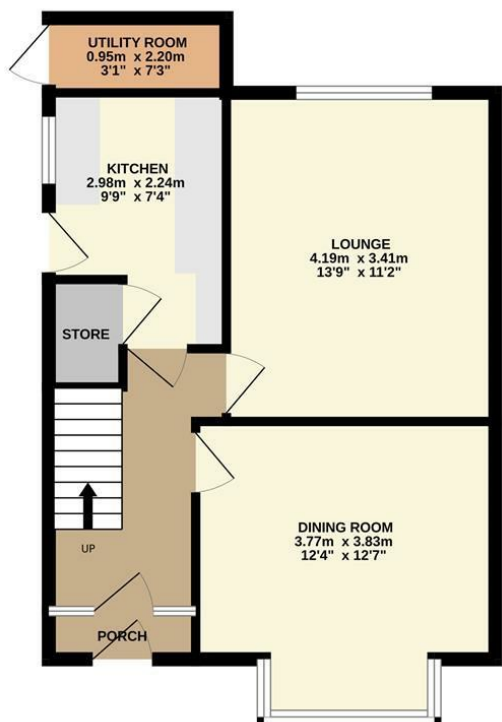

1ST FLOOR
40.7 sq.m. (438 sq.ft.) approx.

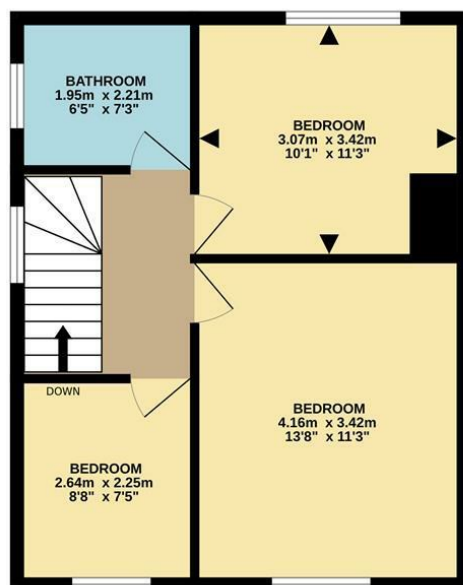

TOTAL FLOOR AREA: 85.7 sq.m. (923 sq.ft.) approx.

Whilst every attempt has been made to ensure the accuracy of the floorplan contained here, measurements of doors, windows, rooms and any other items are approximate and no responsibility is taken for any error, omission or mis-statement. This plan is for illustrative purposes only and should be used as such by any prospective purchaser. The services, systems and appliances shown have not been tested and no guarantee as to their operability or efficiency can be given.
Made with Metropix ©2024

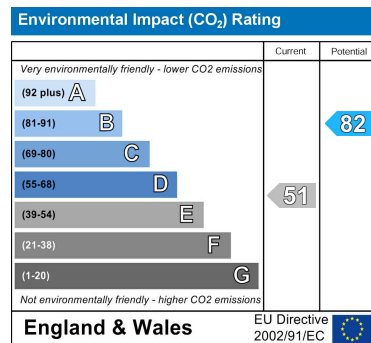
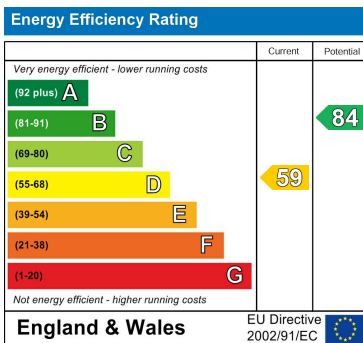
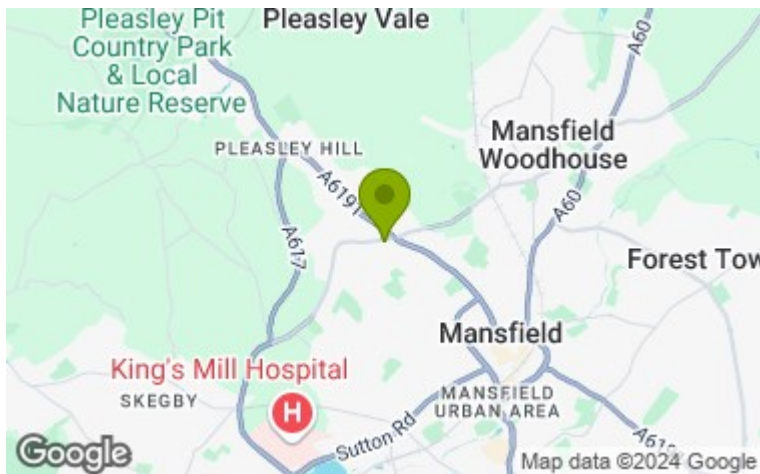

DISCLAIMER

GENERAL - Whilst Pinewood Property Estates endeavour to make our sales particulars accurate they do not constitute or form part of an offer or any contract and none are to be relied upon as statements of representation or fact. Please be advised that some of the particulars may be awaiting vendor approval. If you require clarification or further information on any points, please contact Pinewood Properties, especially if you are travelling some distance to view.

SERVICES, SYSTEMS AND APPLIANCES listed in this advertisement have not been tested by Pinewood Property Estates and no guarantee as to their operating ability or efficiency is given. We strongly advise prospective buyers to commission their own survey or service reports before finalising their offer to purchase.

MEASUREMENTS have been taken as a guide to prospective buyers only, and are not precise. You must verify the dimensions carefully before ordering carpets or any built-in furniture.

FIXTURES AND FITTINGS may be mentioned in the advertisement but all these may not be included in the sale and are to be agreed with the seller.

MONEY LAUNDERING REGULATIONS - Intending purchasers will be asked to produce identification documentation at a later stage and we would ask for your co-operation in order that there will be no delay in agreeing the sale.

You may download, store and use the material for your own personal use and research. You may not republish, retransmit, redistribute or otherwise make the material available to any party or make the same available on any other website

Mansfield branch
24 Albert Street
Mansfield, NG1
01623 621001

Clowne branch
26 Mill Street,
Clowne, S43 4JN
01246 810519

Clay Cross branch
20 Market Street,
Clay Cross, S45 9JE
01246 251194

Chesterfield branch
33 Holywell Street,
Chesterfield, S41 7SA
01246 221039

PINEWOOD

