



High Street, Whitwell, Worksop, Nottinghamshire S80 4QZ

 2  1  1  D

£625 PCM

PINEWOOD



**High Street
Whitwell
Worksop
Nottinghamshire
S80 4QZ**



£625 PCM

**2 bedrooms
1 bathrooms
1 receptions**

- OVER 2 FLOORS
- TWO BEDROOMS
- GAS CENTRAL HEATING
- UPVC DOUBLE GLAZING
- SPACIOUS KITCHEN / DINER
- LARGE BATHROOM WITH TUB & SHOWER
- ROOF TERRACE
- FLEXIBLE LAYOUT
- HOLDING DEPOSIT £144
- COUNCIL TAX BAND A

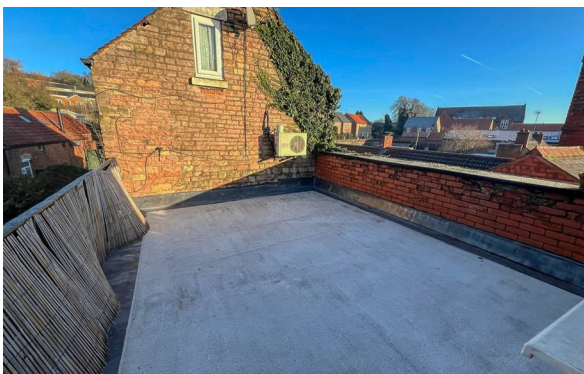

Welcome to this charming Edwardian flat located on High Street in the picturesque village of Whitwell. This property boasts a versatile layout spread over two floors, offering a unique living experience.

Upon entering, you are greeted by a practical kitchen diner, ideal for preparing delicious meals and creating lasting memories with loved ones, perfect for relaxing or entertaining guests. The property features two well-appointed bedrooms, providing ample space for a small family or guests. The bathroom is conveniently located to serve both bedrooms.

One of the highlights of this property is the roof terrace, where you can enjoy stunning views of the village and unwind after a long day.

With its Edwardian charm and modern amenities, this flat offers a perfect blend of character and comfort. Don't miss the opportunity to make this unique property your new home in the heart of Whitwell.

****If you would like to view this property, or apply for it, please click the 'Request Details' button on Rightmove and enter your information****

ACCOMMODATION

Entrance is gained through the upvc double glazed door with adjacent window into the;

OPEN LOUNGE/KITCHEN

Open plan lounge, dining and kitchen.

To the Lounge area is a central heating radiator, a television aerial point and a telephone point.

To the kitchen area is a range of units fitted above and below areas of easy clean work surface inset to which is a stainless steel sink unit with mixer tap. Also fitted is tiling to splashbacks, facilities for an automatic washing machine, laminate flooring, facilities for an electric cooker and a upvc double glazed window viewing to the rear of the property.

INNER HALL

Fitted with a useful storage cupboard, a central heating radiator and the staircase allowing access to the first floor.

LANDING

Fitted with a upvc double glazed window viewing to the rear of the property, a central heating radiator and a upvc door opening onto the roof terrace.

GROUND FLOOR

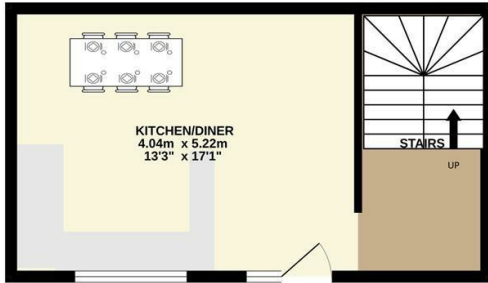

1ST FLOOR

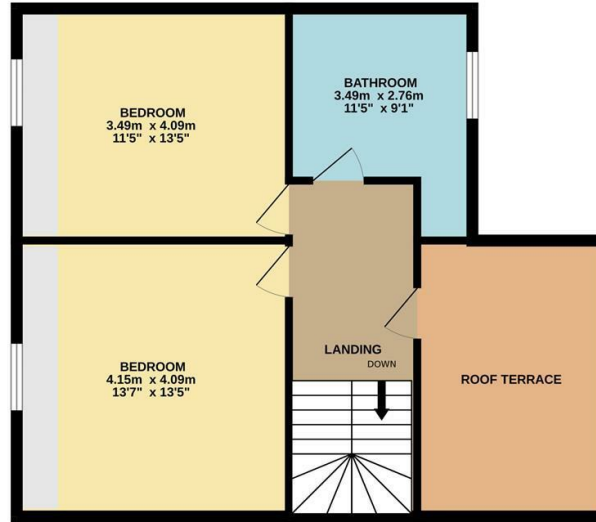

Whilst every attempt has been made to ensure the accuracy of the floorplan contained here, measurements of doors, windows, rooms and any other items are approximate and no responsibility is taken for any error, omission or mis-statement. This plan is for illustrative purposes only and should be used as such by any prospective purchaser. The services, systems and appliances shown have not been tested and no guarantee as to their operability or efficiency can be given.
Made with Metropix ©2023

BEDROOM ONE / LOUNGE

Fitted with a central heating radiator, a sky television point and a upvc double glazed dormer window viewing to the front of the property.

BEDROOM TWO

Fitted with a central heating radiator, eaves storage and a upvc double glazed dormer window viewing to the front of the property.

BATHROOM

Fitted with a suite in white comprising of a panelled bath, a separate shower cubicle, a pedestal wash hand basin and a low flush toilet. Also fitted is tiling to splashbacks, a central heating radiator, an extractor fan and a upvc double glazed window viewing to the rear of the property.

ROOF TERRACE

Just off the first floor landing is a lovely roof terrace.

OTHER INFORMATION

DISCLAIMER

These particulars do not constitute part or all of an offer or contract. While we endeavour to make our particulars fair, accurate and reliable, they are only a general guide to the property and, accordingly. If there are any points which are of particular importance to you, please check with the office and we will be pleased to check the position.

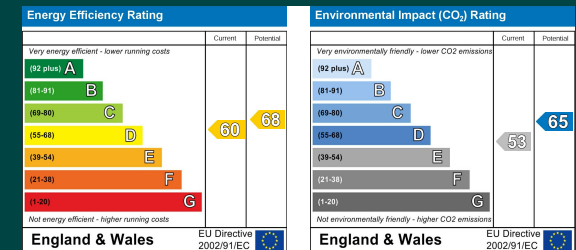

Mansfield branch
24 Albert Street
Mansfield, NG1
01623 621001

Clowne branch
26 Mill Street,
Clowne, S43 4JN
01246 810519

Clay Cross branch
20 Market Street,
Clay Cross, S45 9JE
01246 251194

Chesterfield branch
33 Holywell Street,
Chesterfield, S41 7SA
01246 221039

PINEWOOD

