

# Abbott & Abbott

Estate Agents, Valuers and Lettings



29 Charters Towers Hastings Road, Bexhill-On-Sea, TN40 2LY

£175,000

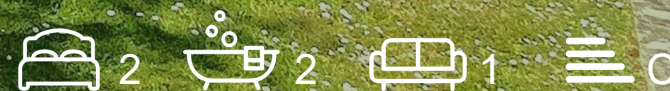







£175,000

# 29 Charters Towers Hastings Road

Bexhill-On-Sea, TN40 2LY

- GROUND FLOOR FLAT
- EN SUITE TO BEDROOM 1
- OFF STREET PARKING
- GAS HEATING
- IN NEED OF REDECORATION/MODERNIZATION
- TWO BEDROOMS
- 16 X 13 LIVING ROOM
- NO CHAIN
- DOUBLE GLAZING

Abbott and Abbott are instructed to sell this spacious Ground floor flat situated in a modern purpose built complex.

The property offered for sale with no chain has gas heating and double glazing but requires modernisation and redecoration.

There is a 16 x 13 living room and two bedrooms with one en suite.

Off street parking is located at the rear of the block



**LIVING ROOM** 16 x 13 (4.88m x 3.96m)

**BEDROOM 1** 13'6 x 12 (4.11m x 3.66m)

**BEDROOM 2** 13'6 x 9'3 (4.11m x 2.82m)

**KITCHEN** 13'6 x 6'10 (4.11m x 2.08m)

**EN SUITE BATHROOM**

**SHOWER ROOM**

**ALLOCATED PARKING BAY**

**COMMUNAL GARDENS**









Floor Plans

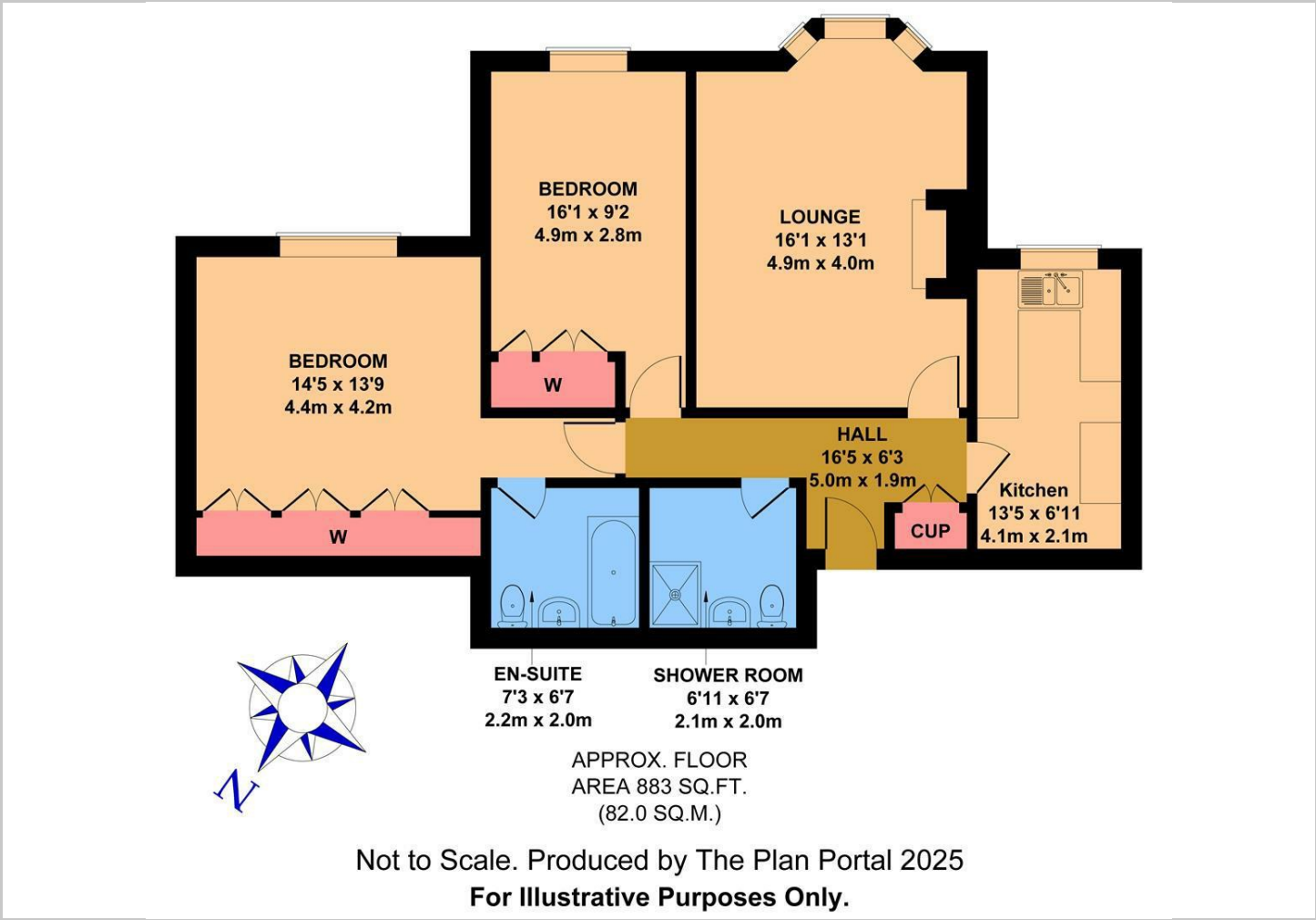

Viewing

Please contact our Sales Office on 01424 212233 if you wish to arrange a viewing appointment for this property or require further information.

The particulars are set out as a general outline only for the guidance of intended purchasers or lessees, and do not constitute, any part of a contract. Nothing in these particulars shall be deemed to be a statement that the property is in good structural condition or otherwise nor that any of the services, appliances, equipment or facilities are in good working order. Purchasers should satisfy themselves of this prior to purchasing.

Location Map

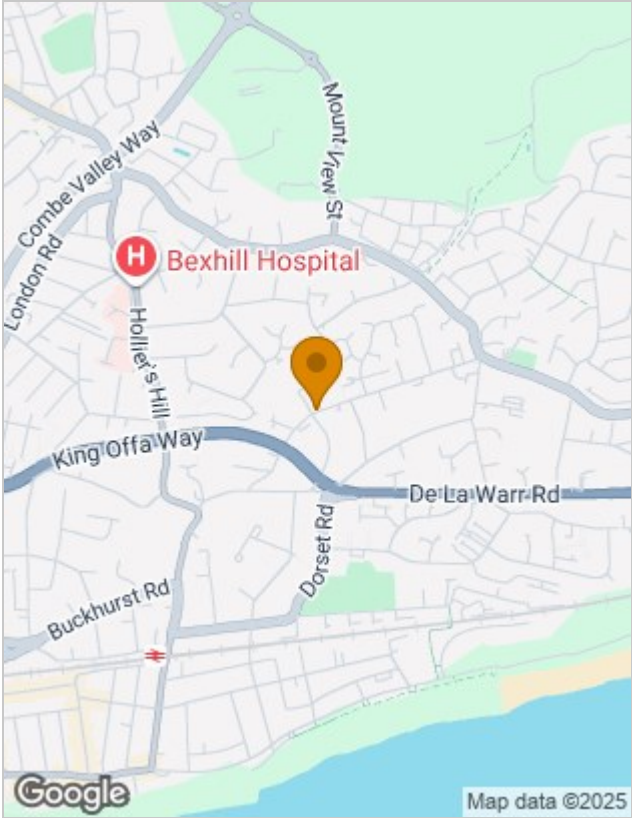

Energy Performance Graph

