

Abbott & Abbott

Estate Agents, Valuers and Lettings



17 Fryatts Way, Bexhill-On-Sea, TN39 4LW

Asking Price £460,000



3



2



3

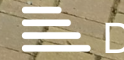

D



Asking Price £460,000

17 Fryatts Way

Bexhill-On-Sea, TN39 4LW

- Detached Bungalow
- Living Room/Dining Room
- Detached Studio/Office
- Three Bedrooms - one with en-suite facilities
- Family Room
- Off Road Parking

Abbott and Abbott are delighted to offer for sale this spacious detached, three bedroom bungalow which is extremely well-presented with gas heating and double glazing, and well fitted kitchen and bathroom facilities.

There are en-suite facilities to the main bedroom, a living room/dining room leading into the conservatory, and an impressive 20ft family room with doors leading into the garden.

Externally, there is also a detached studio suitable for an office for home working, ample parking on the private driveway, and a west facing rear garden.



Entrance Porch with Double Glazed Door

Entrance Hall

Living Room 15'8" x 12'8" (4.80 x 3.87)

Dining Room 10'11" x 10'7" (3.35 x 3.23)

Conservatory 13'8" x 8'7" (4.17 x 2.63)

Kitchen 14'1" x 7'8" (4.30 x 2.34)

Utility Cupboard

Family Room 19'11" x 11'7" (6.08 x 3.55)

Bedroom 1 with en-suite facilities

15'3" x 14'8" (4.66 x 4.48)

Bedroom 2 15'1" x 11'8" (4.60 x 3.58)

Bedroom 3 15'10" x 11'6" (4.84 x 3.53)

Bathroom





**Outside Studio/Office
Gardens**





Floor Plans

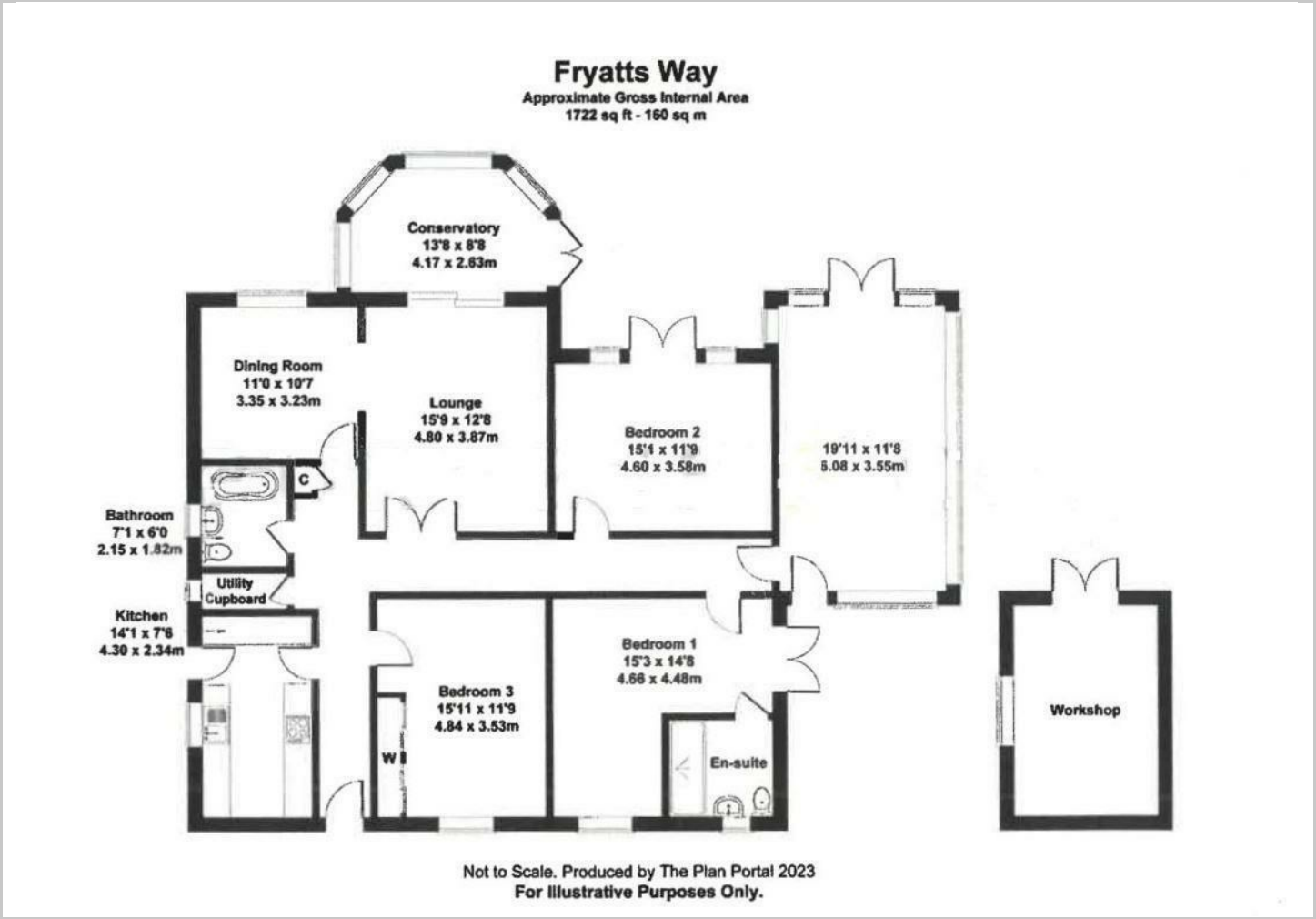

Viewing

Please contact our Sales Office on 01424 212233 if you wish to arrange a viewing appointment for this property or require further information.

The particulars are set out as a general outline only for the guidance of intended purchasers or lessees, and do not constitute, any part of a contract. Nothing in these particulars shall be deemed to be a statement that the property is in good structural condition or otherwise nor that any of the services, appliances, equipment or facilities are in good working order. Purchasers should satisfy themselves of this prior to purchasing.

Location Map

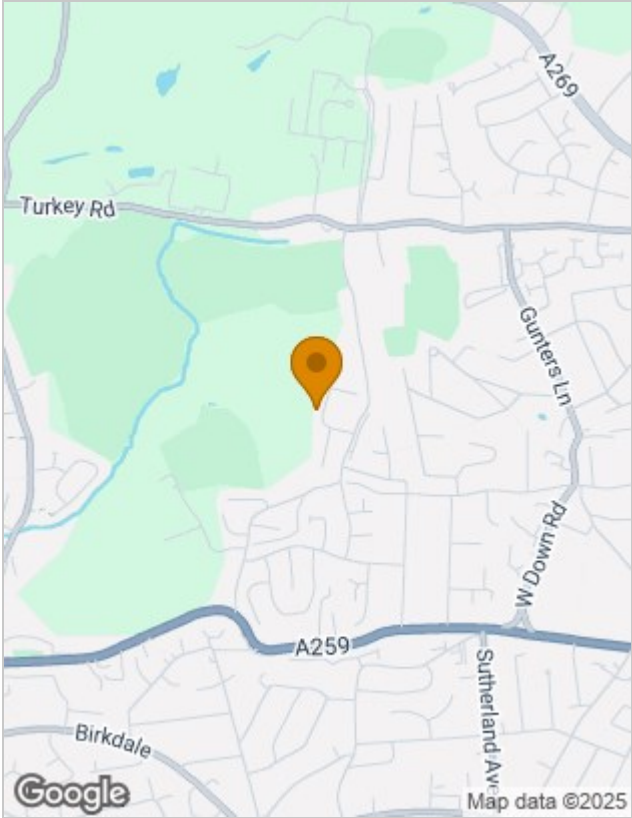

Energy Performance Graph

