



90 Almsford Road  
York, YO26 5NT

Offers In The Region Of £330,000

 3  1  1  C

Fabulous opportunity to buy your forever home in this popular residential area. This lovely three bedroom traditional style semi-detached house already provides ample space to move straight into with the large entrance hall, lounge with bay window opening into the dining room and a separate good size fitted kitchen. Outside to the rear is a beautifully landscaped garden. Upstairs are the three bedrooms, bathroom and separate toilet. The front garden with private driveway leads to a large garage. Similar properties have been extended in various ways if more family living space is needed.

**Entrance Porch**

**Entrance Hallway**

**Lounge**

13'6 x 11'9 (4.11m x 3.58m)

**Dining Room**

12'0 x 10'8 (3.66m x 3.25m)

**Kitchen**

13'6 x 7'5 (4.11m x 2.26m)

**Integral Garage**

23'1 x 10'3 (7.04m x 3.12m)

**First Floor Landing**

**Bedroom 1**

13'6 x 11'0 (4.11m x 3.35m)

**Bedroom 2**

11'6 x 11'2 (3.51m x 3.40m)

**Bedroom 3**

7'1 x 6'8 (2.16m x 2.03m)

**Bathroom**

7'2 x 5'2 (2.18m x 1.57m)

**Separate WC**

**Driveway**

**Rear Garden**



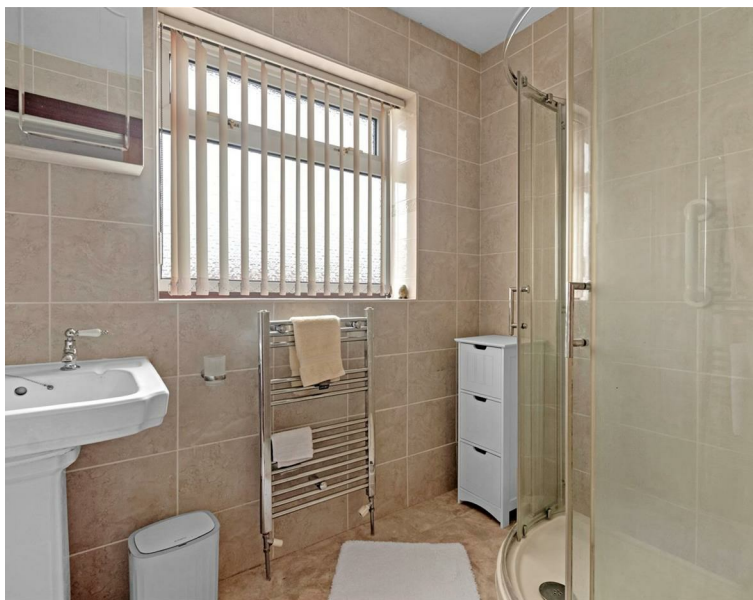

# FLOOR PLAN

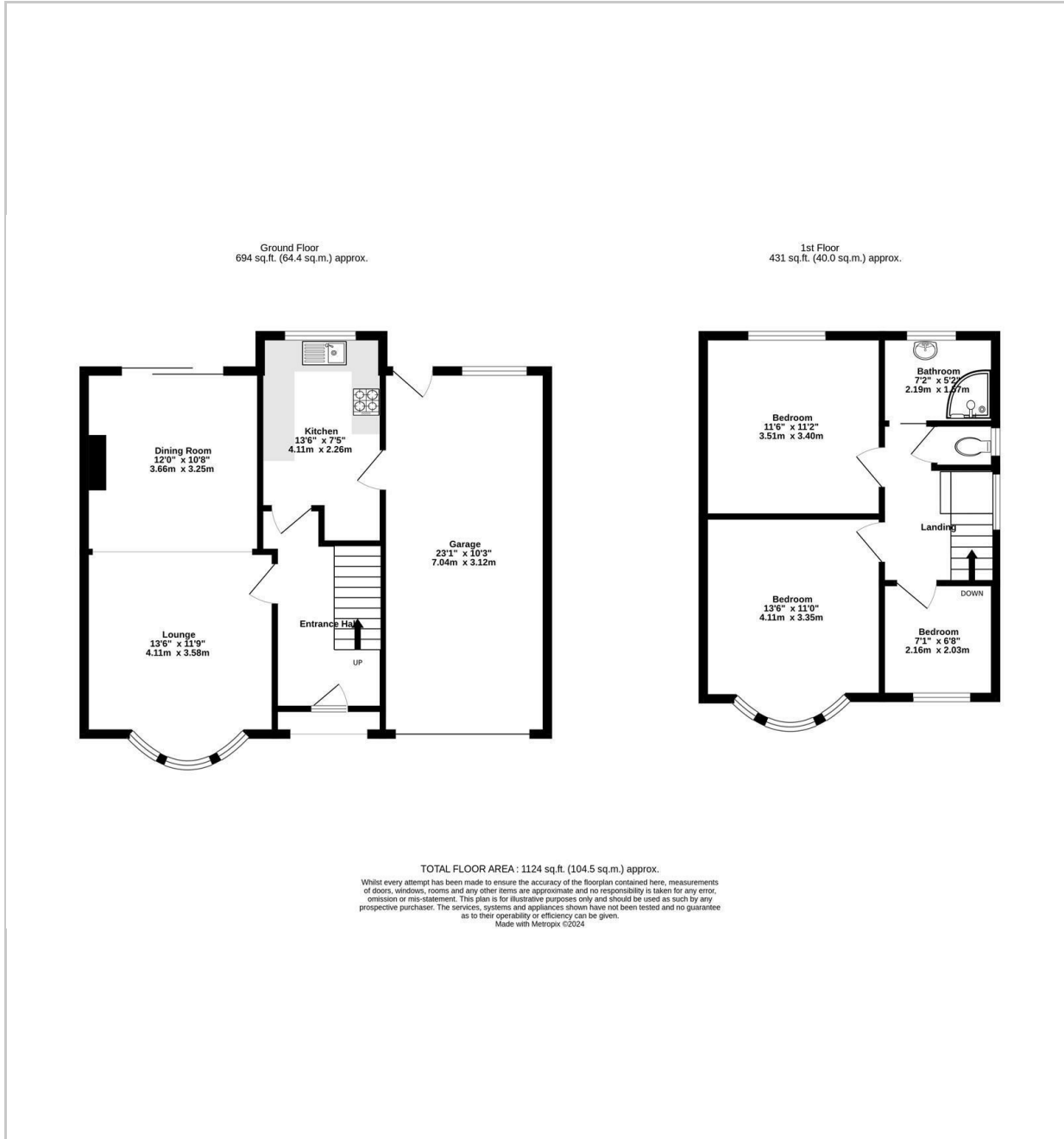

# LOCATION

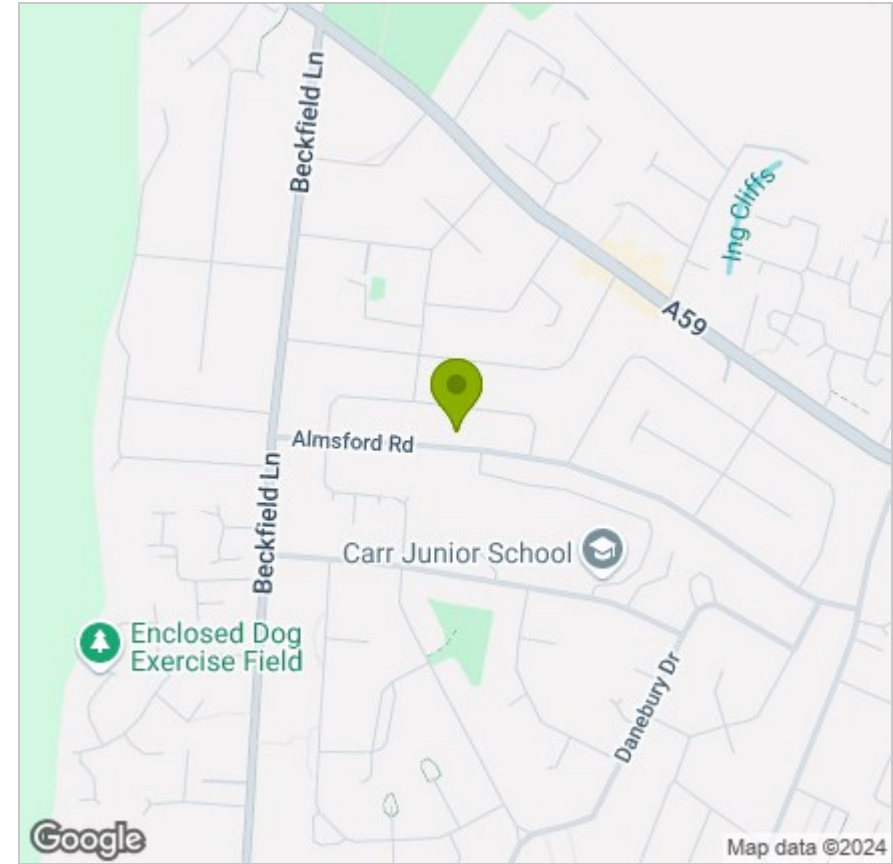

## EPC

Energy Efficiency Rating		Current	Potential
Very energy efficient - lower running costs			
(92 plus) <b>A</b>			<b>84</b>
(81-91) <b>B</b>			
(69-80) <b>C</b>		<b>71</b>	
(55-68) <b>D</b>			
(39-54) <b>E</b>			
(21-38) <b>F</b>			
(1-20) <b>G</b>			
Not energy efficient - higher running costs			
<b>England &amp; Wales</b>		EU Directive 2002/91/EC	

These particulars, whilst believed to be accurate are set out as a general outline only for guidance and do not constitute any part of an offer or contract. Intending purchasers should not rely on them as statements of representation of fact, but must satisfy themselves by inspection or otherwise as to their accuracy. No person in this firm's employment has the authority to make or give any representation or warranty in respect of the property.