

# Rolfe East



Gordon Road, W5

£180,000

- One bedroom
- Excellent condition
- Gas central heating
- Age restriction, must be 60 or more
- Retirement community
- Residents parking
- Double glazed window
- EPC rating: TBC / council tax band: D



An opportunity for those over 60 years old to join this retirement community in the heart of Ealing. For sale is a one bedroom apartment in this well maintained block of flats which is serviced by a lift and has residents parking. This property is in excellent condition and is available now and with vacant possession.

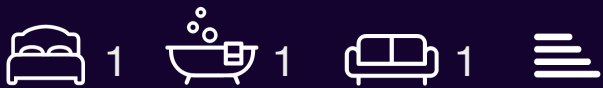

Council Tax Band: D



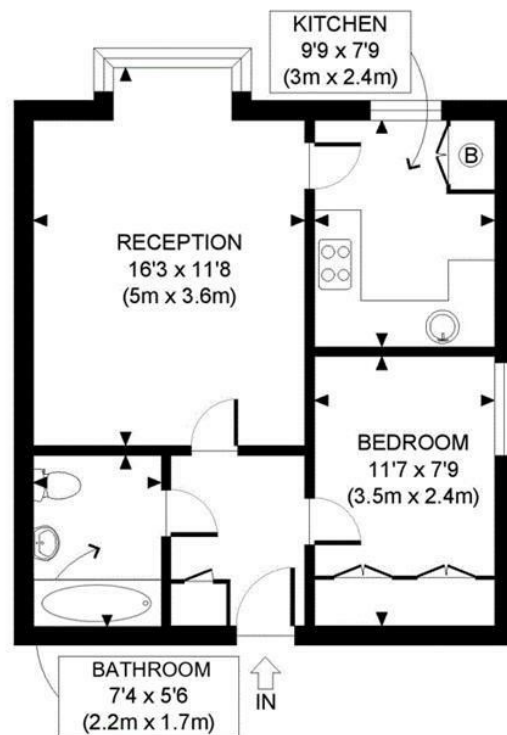

SECOND FLOOR  
GROSS INTERNAL  
FLOOR AREA 443 SQ FT



APPROX. GROSS INTERNAL FLOOR AREA: 443 SQ FT/ 41 SQM

**Rolfe East**

This plan is for illustrative purposes only and should be used as such by any prospective client. Whilst every attempt has been made to ensure the accuracy of the Floor Plan contained here, measurements of the doors, windows, rooms and any other items are approximate and no responsibility is taken for any errors, omissions, or misstatement. The services, systems and appliances shown have not been tested and no guarantee as to the operability or efficiency can be given.

**PROPERTY PHOTO PLANS** COUK  
ONE STOP SHOP FOR PROPERTY MARKETING



Directions



Viewings

Viewings by arrangement only.  
Call 020 8567 2242 to make an appointment.

EPC Rating:

Energy Efficiency Rating		
	Current	Potential
Very energy efficient - lower running costs		
(92 plus) A		
(81-91) B		
(69-80) C		
(55-68) D		
(39-54) E		
(21-38) F		
(1-20) G		
Not energy efficient - higher running costs		
England & Wales	EU Directive 2002/91/EC 