

Rolfe East



Woodville Road, Ealing, W5 2SE

£449,500

- One double bedroom
- Period conversion
- Private rear garden
- EPC rating: D / council tax band: D
- Ground floor flat
- Modernisation required
- Off street parking

With a beautiful private rear garden and off street parking this bright and spacious one double bedroom ground floor flat is offered for sale with the benefits of no upper chain and share of freehold. Although requiring modernisation this property has high ceilings and large sash windows.

 1  1  1  D

Council Tax Band: D



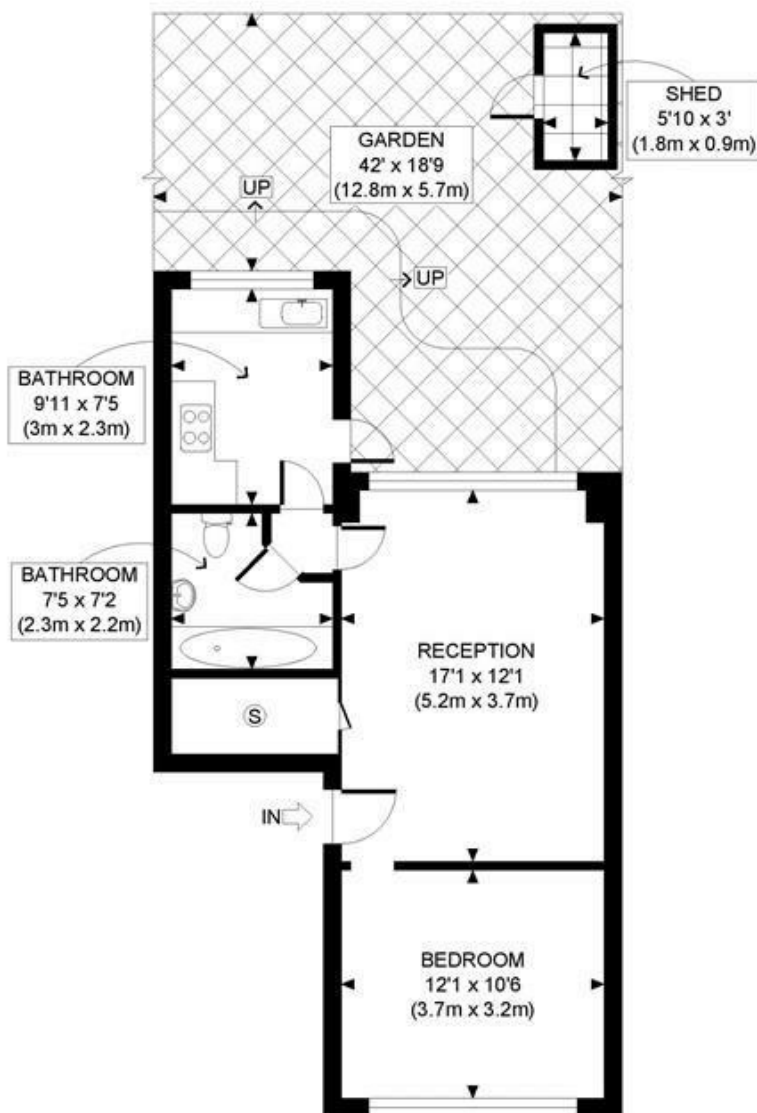

GROUND FLOOR
GROSS INTERNAL
FLOOR AREA 502 SQ FT

APPROX. GROSS INTERNAL FLOOR AREA: 502 SQ FT/ 47 SQM

PROPERTY PHOTO PLANS.CO.UK
ONE STOP SHOP FOR PROPERTY MARKETING

This plan is for illustrative purposes only and should be used as such by any prospective client. Whilst every attempt has been made to ensure the accuracy of the Floor Plan contained here, measurements of the doors, windows, rooms and any other items are approximate and no responsibility is taken for any errors, omissions, or misstatement. The services, systems and appliances shown have not been tested and no guarantee as to the operability or efficiency can be given.

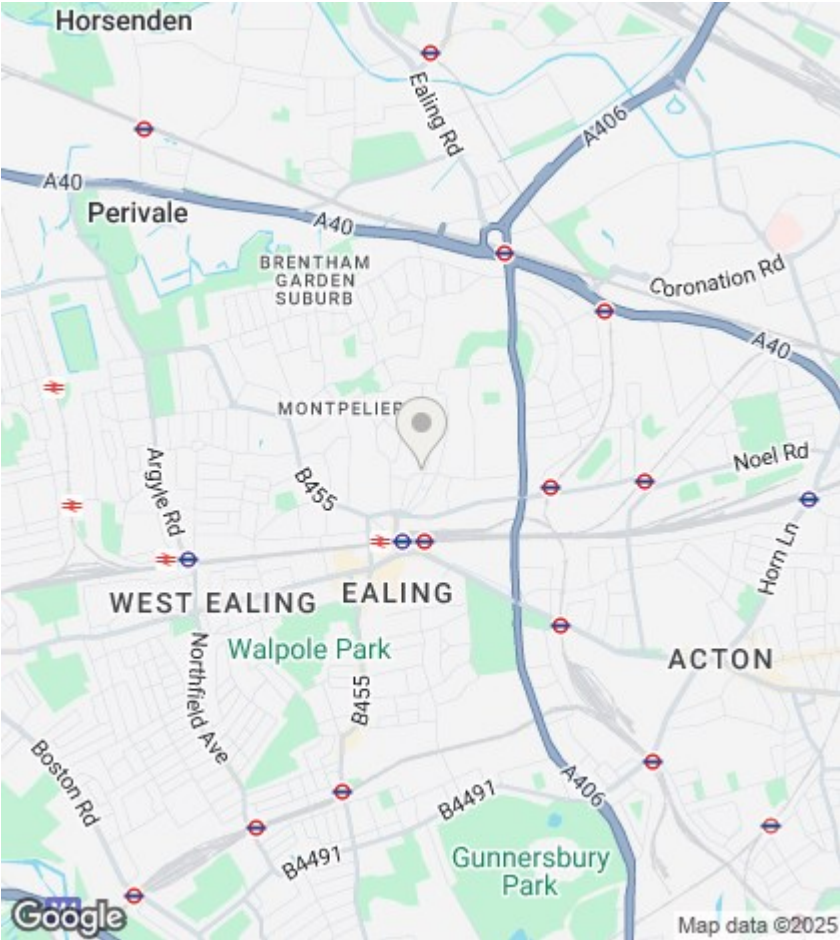

Directions

Viewings

Viewings by arrangement only. Call 020 8567 2242 to make an appointment.

EPC Rating:
D

Energy Efficiency Rating		
	Current	Potential
Very energy efficient - lower running costs		
(92 plus) A		
(81-91) B		
(69-80) C		
(55-68) D	61	
(39-54) E		
(21-38) F		
(1-20) G		
Not energy efficient - higher running costs		
England & Wales		EU Directive 2002/91/EC