



RIDGEWAY

RESIDENTIAL SERVICES



Flat 7, Thornley Close

, Lymm, WA13 0EL

£150,000



2 1 1 C

Floor Plan

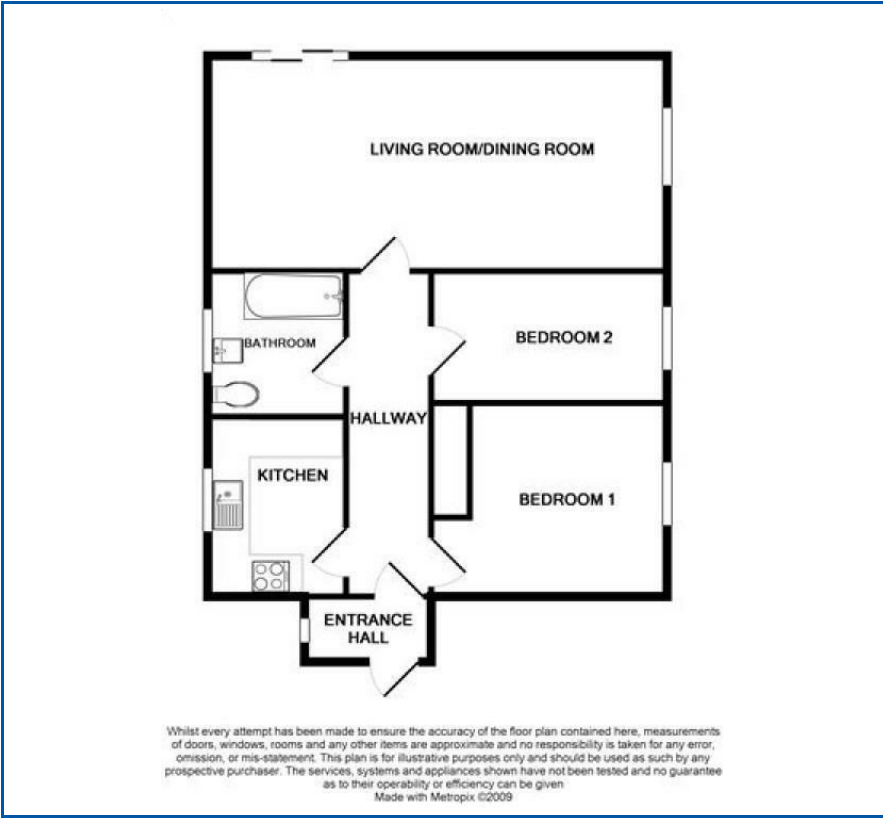

Area Map



Energy Efficiency Graph

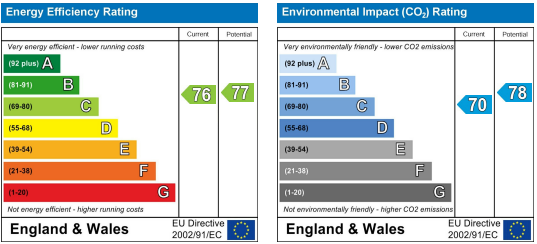

Viewing

Please contact us on 01925 756931 if you wish to arrange a viewing appointment for this property or require further information.

- Entrance Hall: Welcoming and spacious, providing access to all rooms.
- Modern Kitchen: Functional kitchen equipped with all essential appliances.
- Family Bathroom: Featuring a full suite, including a bath with an electric shower.
- Allocated Parking: A dedicated parking space for your convenience.
- Living/Dining Room: Bright and airy space with stunning views over the Bridgewater Canal.
- Two Bedrooms: Two well-sized bedrooms, ideal for family living or as a guest room/office space.
- Gas Central Heating & UPVC Double Glazing: Ensuring a warm and energy-efficient home.
- Communal Gardens: Beautifully maintained gardens at the rear of the development, offering an outdoor space to enjoy.

Charming Second-Floor Apartment – Walking Distance to Lymm Village Centre

Discover this well-appointed second-floor apartment, ideally located within walking distance of the picturesque Lymm village centre. Perfectly positioned for convenience and scenic views, this property offers comfortable and stylish living.

This apartment offers the perfect blend of location, comfort, and style. With its proximity to Lymm village and tranquil canal views, it's an opportunity not to be missed.

Book your viewing today to appreciate all that this wonderful property has to offer!



These particulars, whilst believed to be accurate are set out as a general outline only for guidance and do not constitute any part of an offer or contract. Intending purchasers should not rely on them as statements of representation of fact, but must satisfy themselves by inspection or otherwise as to their accuracy. No person in this firm's employment has the authority to make or give any representation or warranty in respect of the property.