



RIDGEWAY

RESIDENTIAL SERVICES



Flat 7, Thornley Close

, Lymm, WA13 0EL

£154,950



Floor Plan

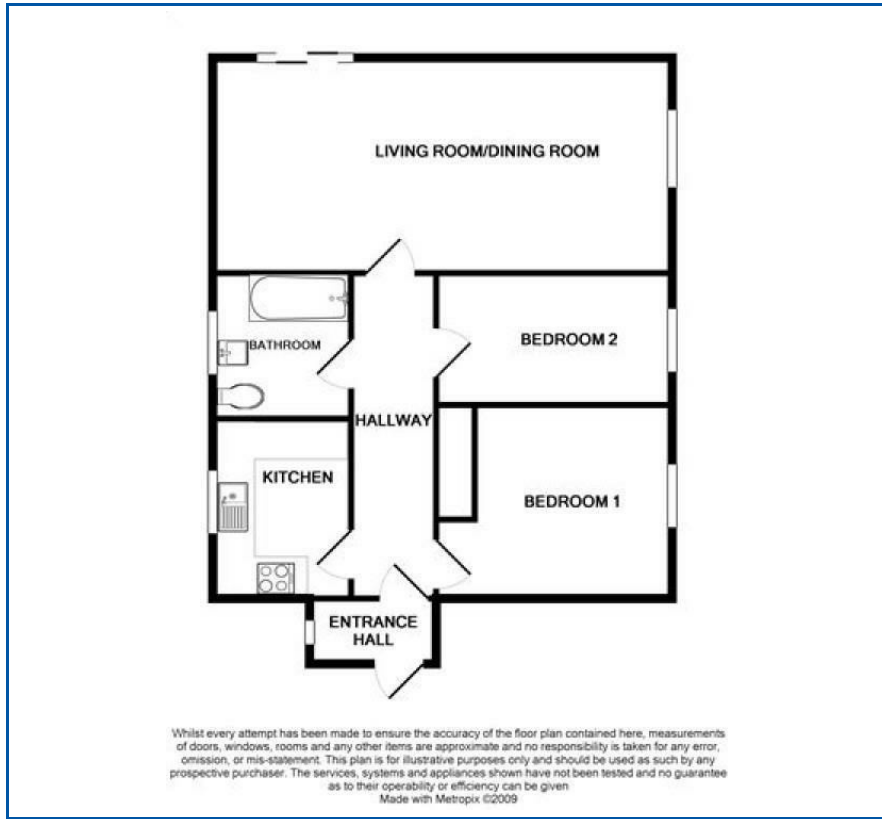

Area Map



Energy Efficiency Graph

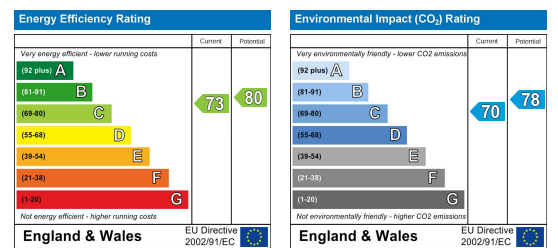

Viewing

Please contact us on 01925 756931 if you wish to arrange a viewing appointment for this property or require further information.

- Well Presented
- Spacious open plan living/dining room
- Gas Central heating
- Overlooking the Bridgewater Canal
- 2nd Floor Apartment
- 2 bedrooms
- Kitchen room
- Large Communal Gardens
- Allocated Parking
- Viewing Recommended

A well appointed second floor apartment, within walking distance of Lymm village centre. The accommodation comprises entrance hall, open plan living/dining room with views over the Bridgewater canal, kitchen, two bedrooms, family bathroom with electric shower above the bath. The property benefits from, gas central heating, UPVC double glazing, allocated parking and delightful communal gardens to the rear of the development.



These particulars, whilst believed to be accurate are set out as a general outline only for guidance and do not constitute any part of an offer or contract. Intending purchasers should not rely on them as statements of representation of fact, but must satisfy themselves by inspection or otherwise as to their accuracy. No person in this firm's employment has the authority to make or give any representation or warranty in respect of the property.