



**Northesk House Tent Street, London E1 5DS**

**welcome to**  
**Northesk House Tent Street, London**

A bright and airy, two-bedroom flat on the second floor of this purpose-built block.

Comprising entrance hallway, living room, kitchen, bathroom with separate WC and two double bedrooms.

A fantastic opportunity to purchase a spacious flat in this popular residential location in E1, East London.

The property has been well looked after by the current owner and has new laminate flooring in the living room and kitchen.



# Tent Street, London, E1

Approximate Area = 542 sq ft / 50.3 sq m

For identification only - Not to scale

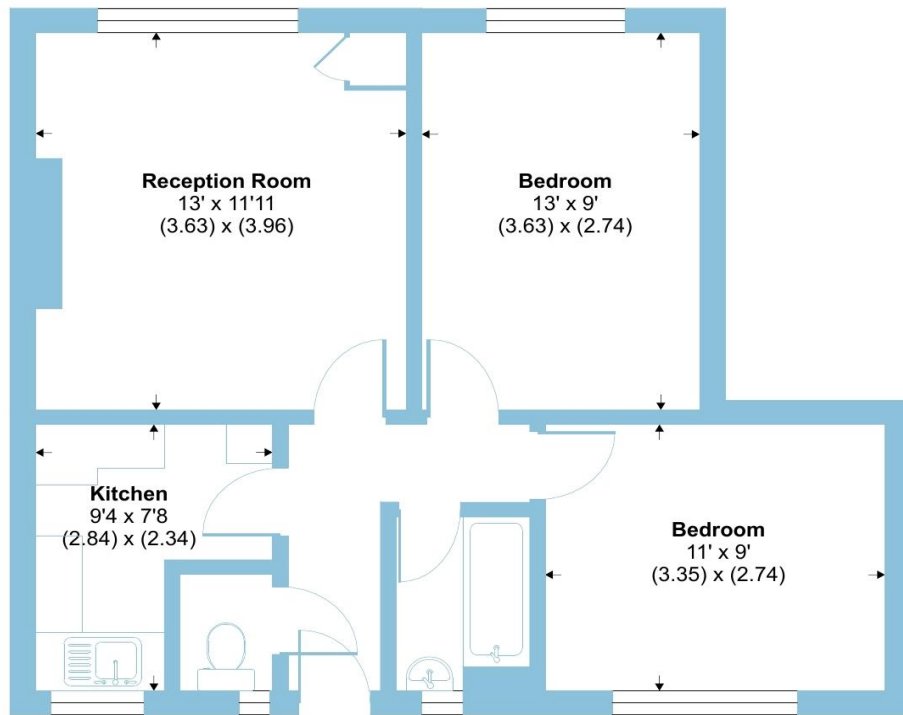

SECOND FLOOR



The Elizabeth Line at Whitechapel connects you to Canary Wharf, Liverpool Street, Farringdon, Tottenham Court Road and Bond Street.

There is also plenty of public green space to choose from, including Weavers Fields, Bethnal Green Gardens and Spitalfields City Farm. Brick Lane is also within easy reach, just a 15 minutes' walk away.



Floor plan produced in accordance with RICS Property Measurement Standards incorporating International Property Measurement Standards (IPMS2 Residential). © ncheom 2024. Produced for Barnard Marcus. REF: 1188695



welcome to

## Northesk House Tent Street, London

- Bright and airy two-bedroom flat
- Two double bedrooms
- Close to local amenities and Brick Lane
- Short walk to Bethnal Green & Whitechapel Stations
- 0.1 to Bethnal Green Overground Station

Tenure: Leasehold EPC Rating: C

This is a Leasehold property. We are awaiting further details about the Term of the lease. For further information please contact the branch. Please note additional fees could be incurred for items such as Leasehold packs.

# £350,000



Please note the marker reflects the postcode not the actual property

view this property online [barnardmarcus.co.uk/Property/KWY104265](https://barnardmarcus.co.uk/Property/KWY104265)



Property Ref:  
KWY104265 - 0003

1. MONEY LAUNDERING REGULATIONS Intending purchasers will be asked to produce identification documentation at a later stage and we would ask for your co-operation in order that there is no delay in agreeing the sale. 2. These particulars do not constitute part or all of an offer or contract. 3. The measurements indicated are supplied for guidance only and as such must be considered incorrect. Potential buyers are advised to recheck measurements before committing to any expense. 4. We have not tested any apparatus, equipment, fixtures or services and it is in the buyers interest to check the working condition of any appliances. 5. Where an EPC, or a Home Report (Scotland only) is held for this property, it is available for inspection at the branch by appointment. If you require a printed version of a Home Report, you will need to pay a reasonable production charge reflecting printing and other costs. 6. We are not able to offer an opinion either written or verbal on the content of these reports and this must be obtained from your legal representative. 7. Whilst we take care in preparing these reports, a buyer should ensure that his/her legal representative confirms as soon as possible all matters relating to title including the extent and boundaries of the property and other important matters before exchange of contracts.



barnard marcus



020 7836 8427



CoventGarden@barnardmarcus.co.uk



53 Endell Street, Covent Garden, LONDON,  
WC2H 9AJ



[barnardmarcus.co.uk](https://barnardmarcus.co.uk)