



Charlesworth House, Dod Street, London E14

welcome to
Charlesworth House, Dod Street, London

A very bright and spacious 529 square foot one bedroom apartment with private balcony.

Set on the second floor, with lift access, the flat comprises hallway, living room and balcony, kitchen, bedroom and bathroom.



Dod Street, London, E14

Approximate Area = 529 sq ft / 49.1 sq m

For identification only - Not to scale

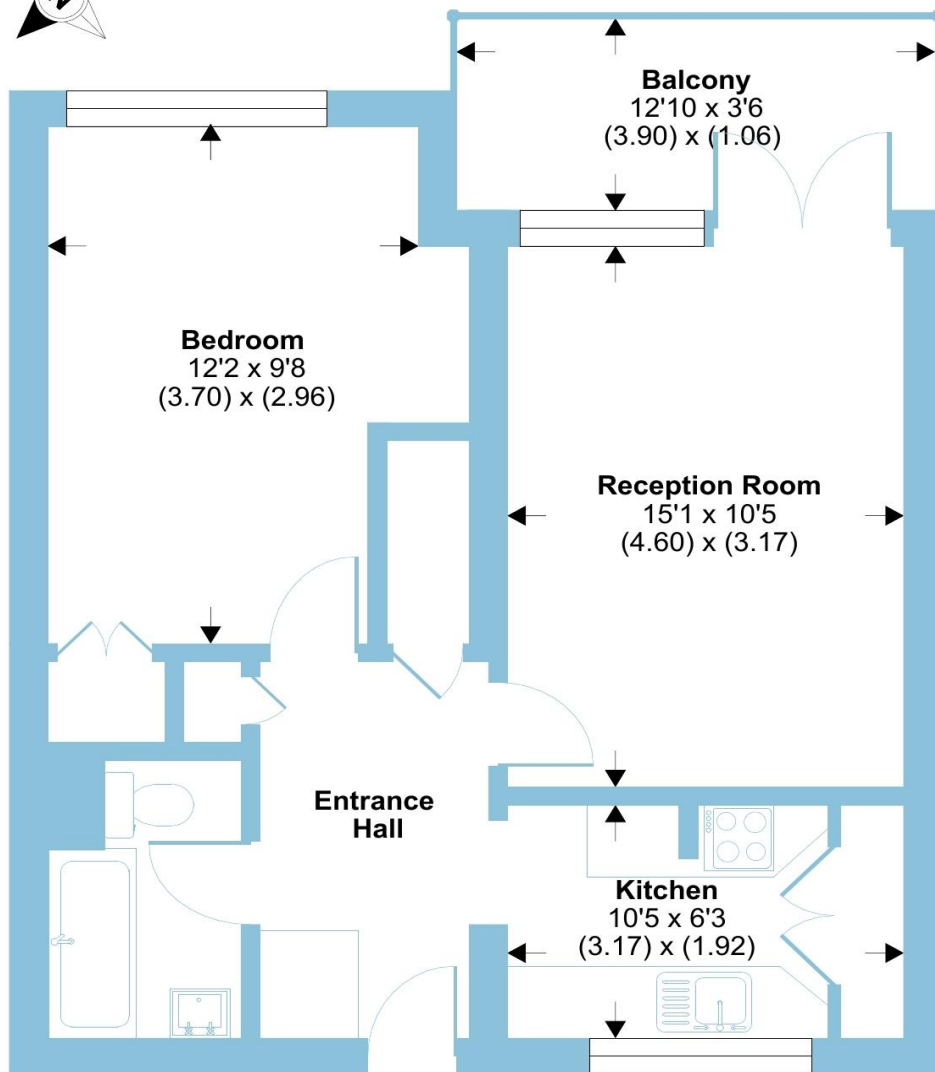

SECOND FLOOR



This one bedroom flat is part of Charleswoth House on Dod Street, which is located 0.4 miles from Westferry DLR station.

The living room, balcony and bedroom face south-west so are very bright and airy and the balcony has views of Canary Wharf.

The development is within easy reach of Canary Wharf, which is 0.7 miles away.



Floor plan produced in accordance with RICS Property Measurement Standards incorporating International Property Measurement Standards (IPMS2 Residential). © nchecon 2024. Produced for Barnard Marcus. REF: 1103859



welcome to

Charlesworth House, Dod Street, London

- One bedroom
- Second floor with lift
- 529 square foot
- South-west facing balcony
- Residents' permit parking

Tenure: Leasehold EPC Rating: C

This is a Leasehold property. We are awaiting further details about the Term of the lease. For further information please contact the branch. Please note additional fees could be incurred for items such as Leasehold packs.

£300,000



Please note the marker reflects the postcode not the actual property

view this property online barnardmarcus.co.uk/Property/KWY104135



Property Ref:
KWY104135 - 0002

1. MONEY LAUNDERING REGULATIONS Intending purchasers will be asked to produce identification documentation at a later stage and we would ask for your co-operation in order that there is no delay in agreeing the sale. 2. These particulars do not constitute part or all of an offer or contract. 3. The measurements indicated are supplied for guidance only and as such must be considered incorrect. Potential buyers are advised to recheck measurements before committing to any expense. 4. We have not tested any apparatus, equipment, fixtures or services and it is in the buyers interest to check the working condition of any appliances. 5. Where an EPC, or a Home Report (Scotland only) is held for this property, it is available for inspection at the branch by appointment. If you require a printed version of a Home Report, you will need to pay a reasonable production charge reflecting printing and other costs. 6. We are not able to offer an opinion either written or verbal on the content of these reports and this must be obtained from your legal representative. 7. Whilst we take care in preparing these reports, a buyer should ensure that his/her legal representative confirms as soon as possible all matters relating to title including the extent and boundaries of the property and other important matters before exchange of contracts.

Barnard Marcus is a trading name of Sequence (UK) Limited which is registered in England and Wales under company number 4268443, Registered Office is Cumbria House, 16-20 Hockliffe Street, Leighton Buzzard, Bedfordshire, LU7 1GN. VAT Registration Number is 500 2481 05.



barnard marcus



020 7836 8427



CoventGarden@barnardmarcus.co.uk



53 Endell Street, Covent Garden, LONDON,
WC2H 9AJ



barnardmarcus.co.uk