



15 Swansfield Park Road
Alnwick





15 Swansfield Park Road, Alnwick, Northumberland, NE66 1AT

Guide Price £195,000

Beautifully presented, traditional stone terraced home, occupying a lovely position on this popular residential road in the heart of Alnwick Town. The property offers well proportioned accommodation, finished to an excellent standard, with town garden to front and good sized enclosed rear courtyard. Swansfield Park Road enjoys excellent access to the town centre, as well as local services and shopping facilities.

Entrance hall with stairs to the first floor | Pleasant reception room to the front which has feature fireplace | Lounge to the rear including feature fireplace and wood burning stove | Contemporary fitted kitchen in a grey high gloss with complimentary Silestone work surfaces. Integrated appliances include induction hob with glass extractor, electric oven and microwave, dishwasher and fridge/freezer. Door gives access to the rear yard | To the first floor - Family bathroom fitted with bath and separate double shower | Double bedroom which has built in wardrobe | Second double bedroom | Good sized third bedroom | Externally - Town garden to front laid to lawn and enclosed rear courtyard with pedestrian access gate.

Services: Mains Electric, Gas, Water & Drainage | Gas Central Heating | Tenure: Freehold | Council Tax: Band B | EPC: D









Ground Floor

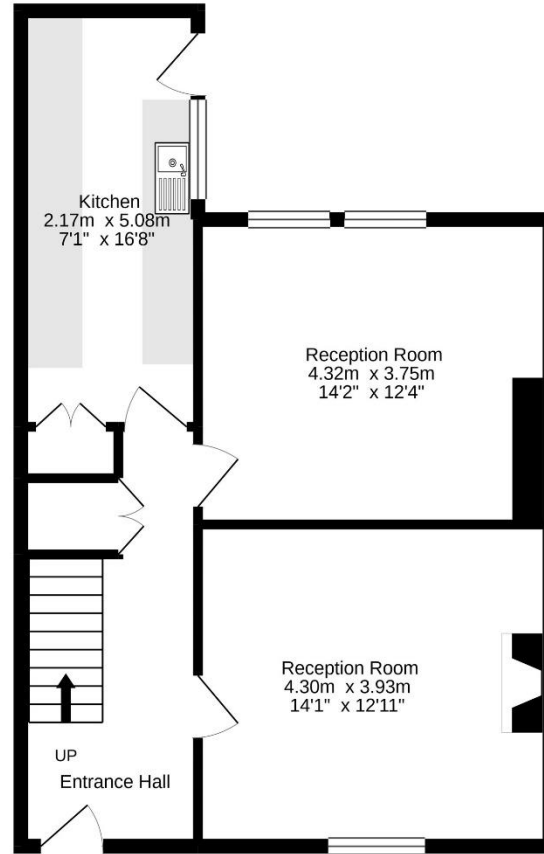

1st Floor

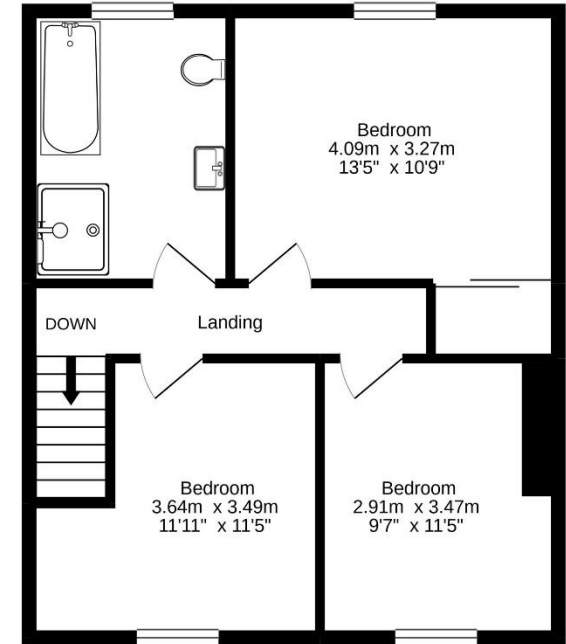

Whilst every attempt has been made to ensure the accuracy of the floorplan contained here, measurements of doors, windows, rooms and any other items are approximate and no responsibility is taken for any error, omission or mis-statement. This plan is for illustrative purposes only and should be used as such by any prospective purchaser. The services, systems and appliances shown have not been tested and no guarantee as to their operability or efficiency can be given.
Made with Metropix ©2021



All enquiries to our Alnwick Office | 35 Bondgate Without, Alnwick, Northumberland NE66 1PR

T: 01665 600 170 | www.sandersonyoung.co.uk

