



# ESTATE AGENTS

*... the key to a successful move*



**Crossfield Avenue, Blythe Bridge, Stoke-On-Trent, ST11 9PL**

**Offers in the  
region of  
£180,000**

- \* SPACIOUS THREE BEDROOM SEMI DETACHED HOUSE
- \* SITUATED IN A POPULAR RESIDENTIAL LOCATION
- \* EXCELLENT HOME FOR A GROWING FAMILY
- \* EASY ACCESS TO THE A50 A500 AND M6

w: [www.keysestateagents.co.uk](http://www.keysestateagents.co.uk)

# Crossfield Avenue, Blythe Bridge, Stoke-On-Trent,

## ACCOMMODATION

### DESCRIPTION

Welcome to Crossfield Avenue, Blythe Bridge - a semi-detached house with immense potential! This property comprises a spacious entrance hall, lounge/diner, kitchen and to the first floor, three cosy bedrooms, and a well-appointed bathroom. Situated on a good-sized plot, this could be the perfect first home for you.

The best part? This property comes with no chain, making the buying process smoother and quicker for you. While it requires some updating, this presents a fantastic opportunity for you to put your own stamp on this lovely home.

Imagine the possibilities - from redesigning the reception room to creating your dream bedroom. The good-sized plot offers ample space for outdoor activities or even a beautiful garden retreat.

Don't miss out on the chance to own this gem in Blythe Bridge. With its great potential and ideal location, this property could be the start of your perfect home journey.



# Crossfield Avenue, Blythe Bridge, Stoke-On-Trent,



Energy Efficiency Rating		
	Current	Potential
<i>Very energy efficient - lower running costs</i>		
(92 plus) <b>A</b>		
(81-91) <b>B</b>		
(69-80) <b>C</b>		
(55-68) <b>D</b>		
(39-54) <b>E</b>		
(21-38) <b>F</b>		
(1-20) <b>G</b>		
<i>Not energy efficient - higher running costs</i>		
<b>England &amp; Wales</b>	EU Directive 2002/91/EC	

Environmental Impact (CO <sub>2</sub> ) Rating		
	Current	Potential
<i>Very environmentally friendly - lower CO<sub>2</sub> emissions</i>		
(92 plus) <b>A</b>		
(81-91) <b>B</b>		
(69-80) <b>C</b>		
(55-68) <b>D</b>		
(39-54) <b>E</b>		
(21-38) <b>F</b>		
(1-20) <b>G</b>		
<i>Not environmentally friendly - higher CO<sub>2</sub> emissions</i>		
<b>England &amp; Wales</b>	EU Directive 2002/91/EC	

For illustration purposes only. Do not scale.

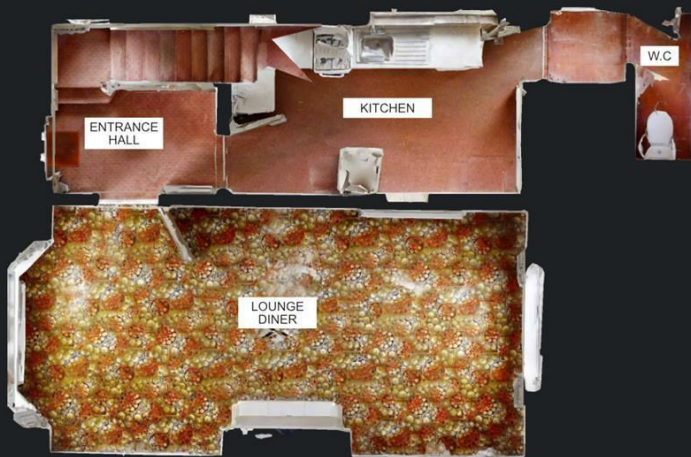

Ground Floor



First Floor

## Crossfield Avenue, Blythe Bridge FLOOR PLAN



Keys Independent Estate Agents Ltd for themselves and for the vendors of this property whose agents they are given notice that (i) the particulars are set out as general outline only for the guidance of intending purchasers, and do not constitute, nor constitute part of, an offer or contract; (ii) all descriptions, dimensions, references to condition and necessary permissions for use and occupation, and other details are given without responsibility and any intending purchasers should not rely on them as statements or representations of fact but must satisfy themselves by inspection or otherwise as to the correctness of each of them; (iii) no person in the employment of Keys Independent Estate Agents Ltd has any authority to make or give any representation or warranty whatsoever in relation to this property. Keys Estate Agents is the Marketing name of Keys Independent Estate Agents. Registered in England, Reg no.4554970 Directors: Danny Mayer, James Havill.

YOU HOME IS AT RISK IF YOU DO NOT KEEP UP REPAYMENTS ON A MORTGAGE OR OTHER LOAN SECURED ON IT  
Written quotations of credit terms available on request. A life assurance policy may be required