



## Lowshoe Lane, Romford - RM5 2AA

£550,000 Freehold

NO ONWARD CHAIN • FOUR BEDROOMS • SOUTH FACING REAR GARDEN • OUTBUILDING WITH POTENTIAL FOR ALTERNATIVE USES • CLOSE PROXIMITY TO MULTIPLE PRIMARY SCHOOLS • EN-SUITE TO PRINCIPAL BEDROOM



Offered with no onward chain, this four-bedroom end-of-terrace home on Lowshoe Lane is an excellent opportunity for families and investors alike. With a modern interior, an outbuilding offering extra space, and a south-facing garden, it's ready to move into.

The ground floor features a spacious reception room leading into an open-plan kitchen and dining area. The kitchen is modern with sleek units and integrated appliances. A conservatory at the rear provides additional living space, ideal for a playroom or home office.

On the first floor, there are three well-proportioned bedrooms and a stylish family bathroom with a freestanding bath. The top floor is dedicated to the principal bedroom, complete with an en-suite shower room.

The south-facing rear garden is perfect for outdoor relaxation, and the large outbuilding offers potential for a home office, gym, or workshop.

Located within easy reach of several primary schools, this home is ideal for families. It's also well-connected to local amenities and transport links, making commuting a breeze.

Council Tax band: D

Tenure: Freehold

EPC Energy Efficiency Rating: D

EPC Environmental Impact Rating: E



**Accord**  
Sales & Lettings

Hallway

Reception Room

10' 11" x 10' 11" (3.32m x 3.32m)

Kitchen

17' 5" x 10' 0" (5.30m x 3.05m)

Conservatory

15' 2" x 8' 10" (4.62m x 2.70m)

Landing

Bedroom

11' 0" x 10' 10" (3.35m x 3.30m)

Bedroom

10' 9" x 10' 2" (3.27m x 3.09m)

Bedroom

7' 1" x 6' 4" (2.15m x 1.93m)

Bathroom

Bedroom

16' 9" x 16' 1" (5.11m x 4.90m)

En-suite

Garden Room/Outbuilding

19' 8" x 9' 4" (6.00m x 2.85m)





**Accord**  
Sales & Lettings



**Accord**  
Sales & Lettings



**Accord**  
Sales & Lettings



**Accord**  
Sales & Lettings



**Accord**  
Sales & Lettings



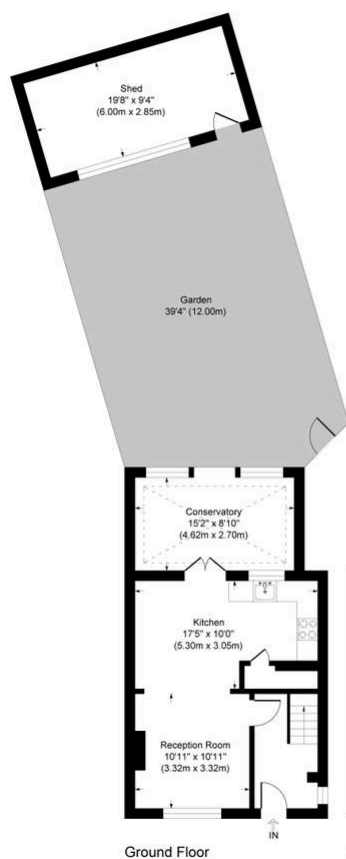

**Accord**  
Sales & Lettings

## Lowshoe Lane

Approximate Gross Internal Area

Ground Floor = 48.8 sq m / 526 sq ft

First Floor = 34.9 sq m / 377 sq ft

Second Floor = 25.9 sq m / 280 sq ft

Outbuilding = 17.1 sq m / 184 sq ft

Total = 126.7 sq m / 1367 sq ft

This plan is for layout guidance only. Not drawn to scale unless stated. Windows and door openings are approximate. Whilst every care is taken in the preparation of this plan, please check all dimensions, shapes and compass bearings before making any decisions reliant upon them.

powered by:

**THE360IMAGE**  
www.the360image.co.uk