



Longford Park Road
Bodicote



ROUND & JACKSON
ESTATE AGENTS

www.roundandjackson.co.uk



66 Longford Park Road

Bodicote, Banbury, OX15 4FU

£500,000

A superb detached family house with beautifully presented, spacious accommodation, a landscaped garden and garage. The property is located within this highly regarded development and close to a wide range of amenities.

The Property

66 Longford Park Road, Bodicote is a superb detached family house which is pleasantly located within the sought after Longford Park development and close to open parkland. The property is beautifully presented throughout and has spacious accommodation which is arranged over two floors. On the ground floor there is a central hallway, a cloakroom/WC, a large sitting room, a separate dining room and an open plan kitchen/dining room. On the first floor there is a very large master bedroom with an en-suite, three further double bedrooms and a modern family bathroom. Externally there is a beautifully landscaped garden to the rear and there is a single garage and driveway to the side.

We have prepared a floorplan to show the room sizes and layout. Some of the main features include:

Entrance Hallway

A spacious hallway with attractive tiled flooring, stairs to the first floor with a cupboard beneath and doors to all ground floor accommodation.

Sitting Room

A spacious and beautifully decorated dual aspect room with double doors onto the garden.

Dining Room

A good sized reception room with windows to the front and side.

Cloakroom

Fitted W.C. and wash hand basin.

Kitchen/Dining Room

A superb open plan room with double doors onto the garden and ample space for dining furniture. The kitchen is fitted with modern eye level cabinets and base units and drawers with work surfaces over and an inset sink and draining board. Other features include an inset four ring hob with extraction hood, a double oven, integrated dishwasher and washing machine and space for a fridge/freezer.

Master Bedroom

A superb master bedroom with ample space for furniture and an en-suite shower room.

Bedroom Two

A large double bedroom with windows to the front and rear.

Bedroom Three

A double room with windows to the front and side and a hatch to the loft space.

Bedroom Four

A double room with a window to the front and a built in storage cupboard.

Outside

To the front of the property there is a landscaped garden area with steps to the front door. To the rear there is a beautifully landscaped garden which is ideal for relaxing and entertaining. The garden is predominantly laid to lawn with a large patio adjoining the house with pergola and there is a further paved area to the one side and well stocked flower and plant borders. There is a gate which gives access to the private driveway and garage.

Garage and Parking

At the side of the property there is a private driveway with parking for two vehicles and a single garage with an up and over door.

Situation

Bodicote is a popular and thriving village lying approximately a mile and a half South of Banbury. It has a community feel with such groups as The Bodicote Cricket Club and Bodicote Players Amateur Dramatics Group. Within the village amenities include a Post Office/shop, two farm shops, two public houses, an Indian restaurant, Bishop Loveday Church of England Primary School, village hall, Banbury Rugby Club, Kingsfield sports and recreation area with children's playground, Bannatyne's Health and Leisure Club, and a bus service to and from the town centre. Longford Park is a popular and relatively new development which is located on the eastern side of the village. There are many amenities which include the beautiful country park with meandering pathways to the canal, a community hall, the Longford Park primary school, football pitches and sports pavilion and there is provision for retail units.

Services

All mains services connected.

Local Authority

Cherwell District Council.

Viewing Arrangements

By prior arrangement with Round & Jackson.

Tenure

A freehold property.



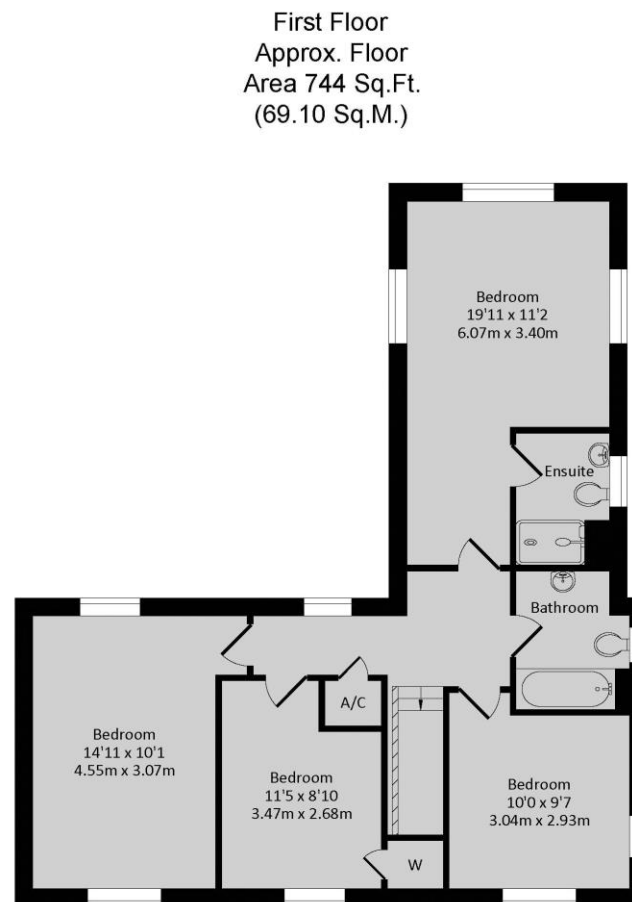
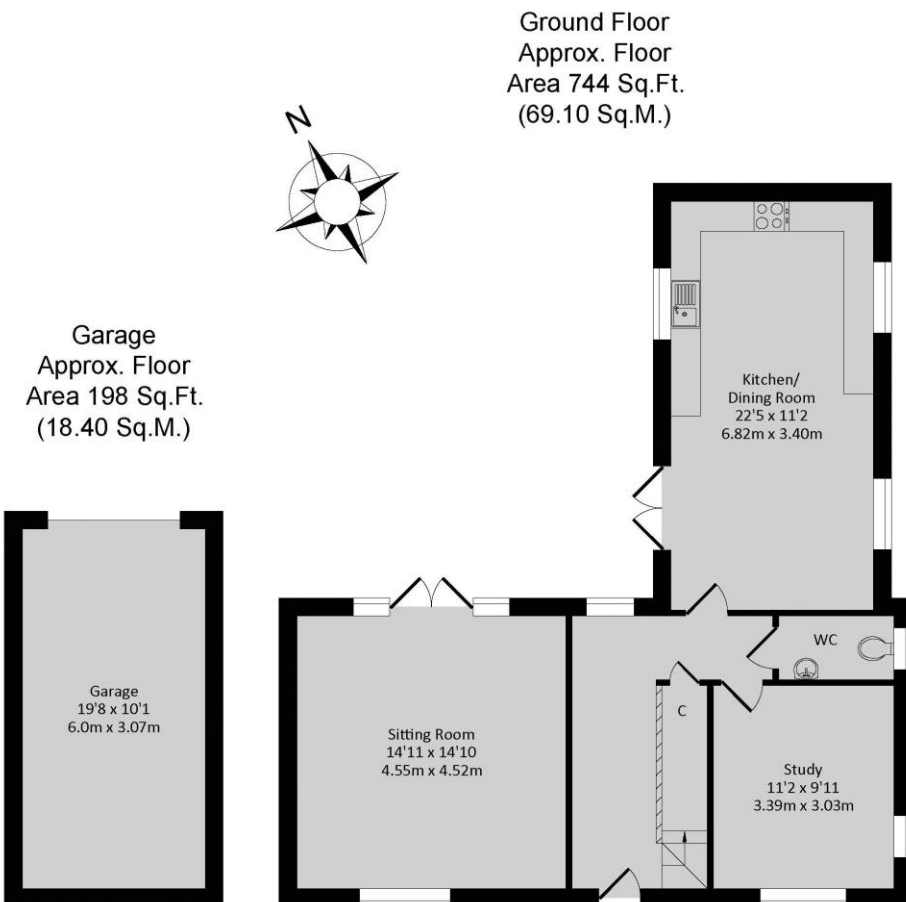

Total Approx. Floor Area 1686 Sq.Ft. (156.60 Sq.M.)

All items illustrated on this plan are included in the "Total Approx Floor Area"

Whilst every attempt has been made to ensure the accuracy of the floor plan contained here, measurements of doors, windows, rooms and any other items are approximate no responsibility is taken for any error, omission, or misstatement. This plan is for illustrative purposes only and should be used as such by any prospective purchaser. The Services Systems and appliance shown have not been tested and no guarantee as to their operability or efficiency can be given.

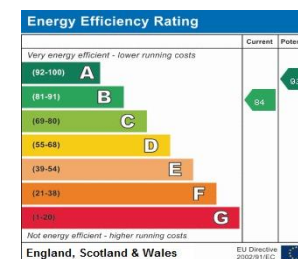

The Office, Oxford Road, Banbury, Oxon, OX16 9XA
T: 01295 279953 E: office@roundandjackson.co.uk
www.roundandjackson.co.uk



ROUND & JACKSON
ESTATE AGENTS

Property Misdescriptions Act 1991: The Agents have not tested any apparatus, equipment, fixtures and fittings, or services, so cannot verify that they are in working order or fit the for the purpose. The buyer is advised to obtain verification from his or her professional buyer. References to the Tenure of the property are based on information supplied by the Vendor. The agents have not had sight of the title documents. The buyer is advised to obtain verification from their solicitor. You are advised to check the availability of any property before travelling any distance to view.