



**4 Bed
House - Terraced
located in**

£1,550 Per Month



**STANTON
PROPERTIES**

GROUND FLOOR
437 sq.ft. (40.6 sq.m.) approx.

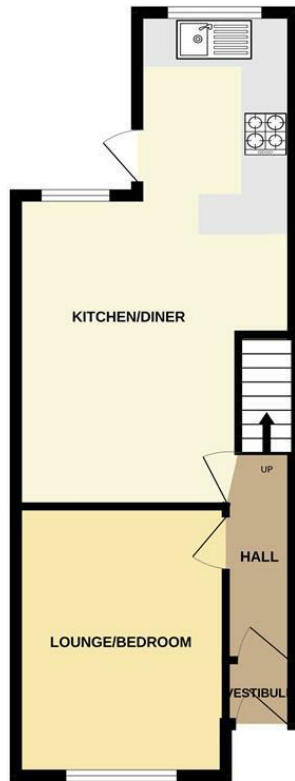

1ST FLOOR
380 sq.ft. (35.3 sq.m.) approx.



2ND FLOOR
247 sq.ft. (22.9 sq.m.) approx.



TOTAL FLOOR AREA: 1065 sq.ft. (98.9 sq.m.) approx.

Whilst every attempt has been made to ensure the accuracy of the floorplan contained here, measurements of doors, windows, rooms and any other items are approximate and no responsibility is taken for any error, omission or mis-statement. This plan is for illustrative purposes only and should be used as such by any prospective purchaser. The services, systems and appliances shown have not been tested and no guarantee as to their operability or efficiency can be given.
Made with Metroplan ©2025

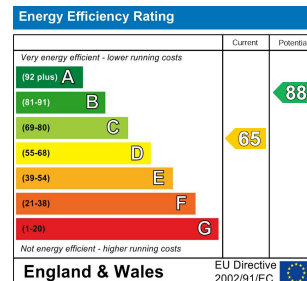

DIRECTIONS

CONTACT

31 Barlow Moor Road
Didsbury
Manchester
M20 6TW

E: office@stantonproperties.co.uk
T: 01614345307

