



10 Borelli Mews , Farnham, GU9 7YZ

A 2 bedroom end of terrace town house situated on a small private development in the heart of Farnham town. The house has a rear courtyard garden and a allocated parking space.

Price Guide £425,000

10 Borelli Mews

, Farnham, GU9 7YZ



- Prime town centre location
- Allocated parking space
- Entrance hall
- Cloakroom
- Sitting room with door to rear courtyard garden
- Kitchen
- 2 bedrooms with wardrobe cupboards
- Shower room
- Courtyard garden
- No onward chain

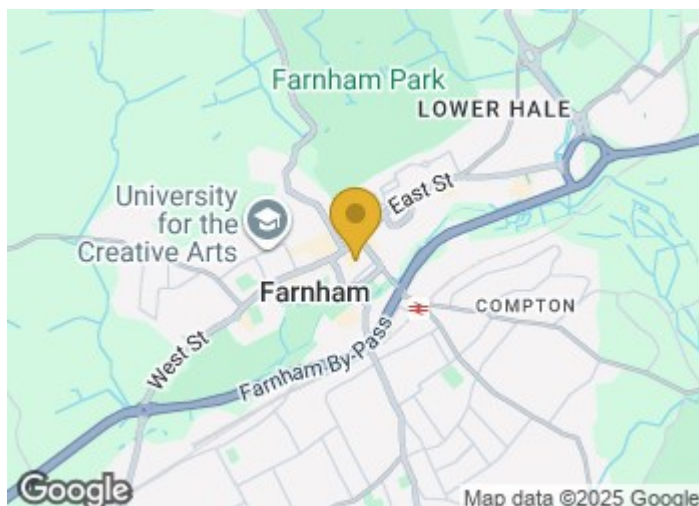

Directions



Floor Plan

GROUND FLOOR
328 sq.ft. (30.5 sq.m.) approx.

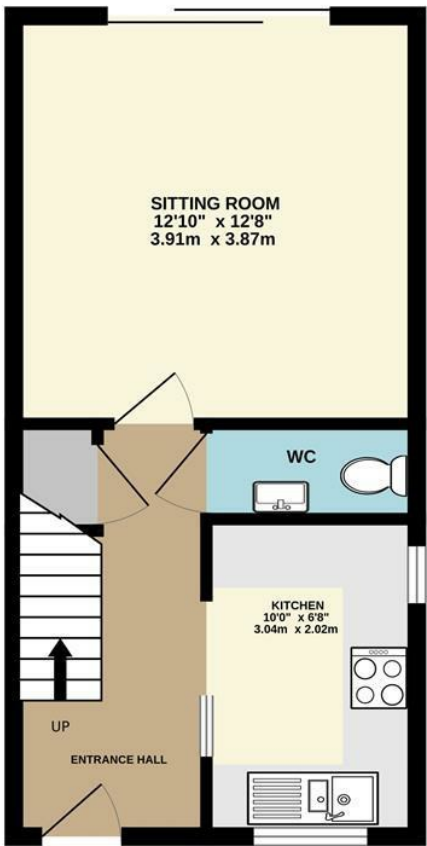

1ST FLOOR
328 sq.ft. (30.5 sq.m.) approx.

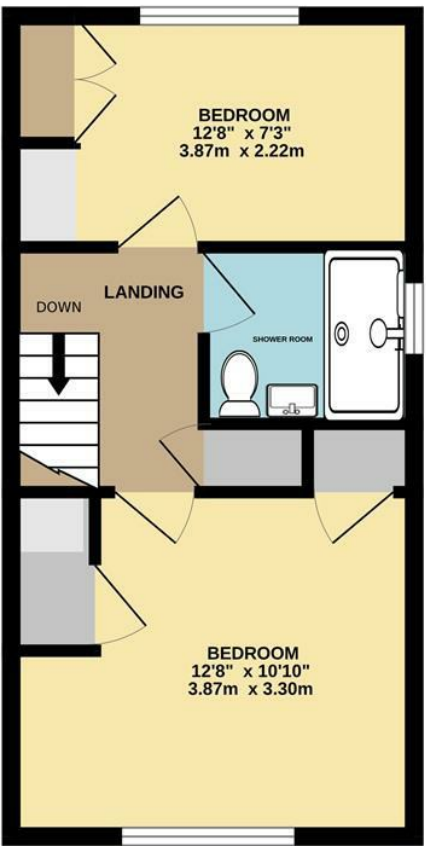

TOTAL FLOOR AREA : 656 sq.ft. (60.9 sq.m.) approx.
Whilst every attempt has been made to ensure the accuracy of the floorplan contained here, measurements of doors, windows, rooms and any other items are approximate and no responsibility is taken for any error, omission or mis-statement. This plan is for illustrative purposes only and should be used as such by any prospective purchaser. The services, systems and appliances shown have not been tested and no guarantee as to their operability or efficiency can be given.
Made with Metropix ©2024



These particulars, whilst believed to be accurate are set out as a general outline only for guidance and do not constitute any part of an offer or contract. Intending purchasers should not rely on them as statements of representation of fact, but must satisfy themselves by inspection or otherwise as to their accuracy. No person in this firms employment has the authority to make or give any representation or warranty in respect of the property.

