



Burhill Grove, Middlesex, HA5 3DW





gibsonhoney

Immaculate ground floor flat set in this prime location with walking distance of Pinner's amenities. This larger than average property consists of : Communal entrance, two double bedrooms, good size lounge, newly fitted bathroom and kitchen. The property benefits include : New gas central heating, re - wired, unfurnished and close to shops and transport.



## Full Description

Immaculate ground floor flat set in this prime location with walking distance of Pinner's amenities. This larger than average property consists of : Communal entrance, two double bedrooms, good size lounge, newly fitted bathroom and kitchen. The property benefits include : New gas central heating, re - wired, unfurnished and close to shops and transport.



92 High Street, Ruislip, Middlesex, HA4 8LS

T: 01895 625999

[lettings@gibsonhoney.co.uk](mailto:lettings@gibsonhoney.co.uk)

[www.gibsonhoney.co.uk](http://www.gibsonhoney.co.uk)



gibsonhoney

GROUND FLOOR

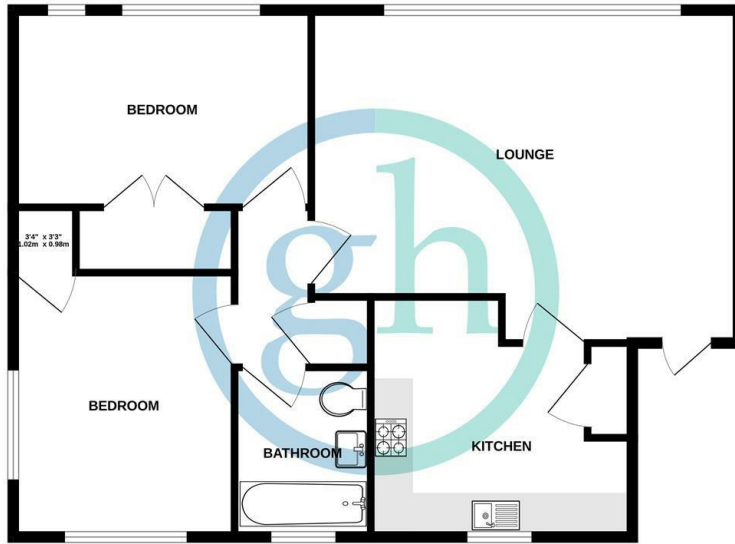

Whilst every attempt has been made to ensure the accuracy of the floorplan contained here, measurements of doors, windows, rooms and any other items are approximate and no responsibility is taken for any error, omission or mis statement. This plan is for illustrative purposes only and should be used as such by any prospective purchaser. The services, systems and appliances shown have not been tested and no guarantee as to their operability or efficiency can be given.  
Made with Metropac (2012)

Energy Efficiency Rating		Current	Potential
Very energy efficient - lower running costs			
(92 plus) A			
(81-91) B			
(69-80) C		69	76
(55-68) D			
(39-54) E			
(21-38) F			
(1-20) G			
Not energy efficient - higher running costs			
<b>England &amp; Wales</b>		EU Directive 2002/91/EC 	



You may download, store and use the material for your own personal use and research. You may not republish, retransmit, redistribute or otherwise make the material available to any party or make the same available on any website. These particulars, whilst believed to be accurate are set out as a general outline only for guidance and do not constitute any part of an offer or contract. Intending purchasers should not rely on them as statements or representation of fact, but must satisfy themselves by inspection or otherwise as to their accuracy. No person in this firm's employment has the authority to make or give any representation or warranty in respect of the property.