



Tarvin Drive, Bredbury. SK6 2PW

Beautifully presented semi detached bungalow in this quiet cul-de-sac location close to local amenities. Much improved by the present owners the accommodation features: Entrance hall, living room with rustic wood panelling, newly fitted kitchen with integrated oven and hob, 2 bedrooms and bathroom. Gas central heating is installed along with uPVC double glazing. Outside there is a driveway, detached garage and low maintenance rear garden with patio seating area. Viewing essential. Tenure Freehold - Chief rent 8.00 PA. Council Tax Band B. EPC Rated D

Asking Price £249,950



LIVING ROOM

16' 1" x 9' 5" (4.90m x 2.87m)



BEDROOM ONE

12' 6" x 10' 1" (3.81m x 3.07m)



OUTSIDE



BEDROOM TWO

10' 0" x 7' 10" (3.05m x 2.39m)

BATHROOM

7' 8" x 6' 2" (2.34m x 1.88m)



FITTED KITCHEN

11' 0" x 6' 5" (3.35m x 1.95m)

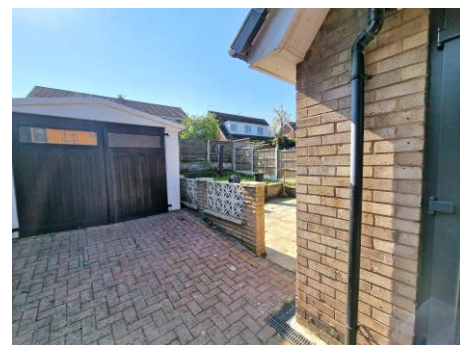

VIEWING ARRANGEMENTS

Appointment is strictly by appointment with Thomas Lardner Romiley Office -

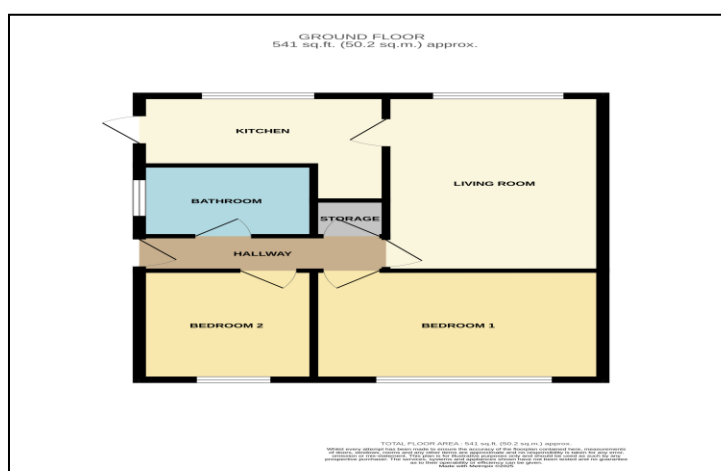

Thomas Lardner Estate Agents, which is a trading name of Stockport Residential Ltd, for themselves and for the vendors or lessors of this property whose agents they are give notice that: (1) all measurements are approximate and any plans provided are not to scale; (2) the particulars are set out as a general outline only for the guidance of intending purchasers or lessors, and do not constitute, nor constitute part of, an offer or contract; (3) we have not tested any apparatus, equipment, fixtures, fittings or services, and so cannot verify that they are in working order or fit for purpose; (4) solicitors should confirm moveable items described in these particulars are, in fact, included in the sale since circumstances change during marketing or negotiations.

T709 Printed by Ravensworth 01670 713330