



5, The Beeches, Stockport Road, Romiley, SK6 3AQ

A sought-after development of just 12 apartments suitable for the over 55's located in the heart of Romiley Village with its independent shops & railway station. This first floor 2 bed apartment is offered as a 50% share with Johnnie Johnson Housing owning the remaining share. Once you own the apartment there is the facility to purchase further shares if required up to a maximum of 75% at this point no rent would be payable. The apartments are set within well tended communal gardens with residents parking to the front. Featuring: Communal entrance with lift & stairs to upper floors, hall, lounge overlooking the front, fitted dining kitchen, 2 beds & modern shower room with large walk in storage cupboard. Gas central heating is installed with uPVC double glazing. Council Tax Band: B. Energy Rating: C. Tenure: Leasehold with 74 years left.

Price Guide: £110,000 for 50% share



ENTRANCE HALL

16' 0" x 3' 2" (4.87m x 0.96m)



MODERN SHOWER ROOM

6' 3" x 5' 9" (1.90m x 1.75m)



LOUNGE

16' 6" x 9' 1" (5.03m x 2.77m)



WALK IN STORAGE CUPBOARD

6' 10" x 2' 9" (2.08m x 0.84m)

SPECIAL NOTE:

The apartment is sold as a 50% share with Johnnie Johnson Housing owning the remaining share. Purchasers need to be approved by the housing association and have to be over 55. A monthly fee of £331.93 is payable which covers service charge (£153.61), ground rent (N/A) and rent (£178.32). It is possible to purchase a further 25% share from the housing association and at this point no rent would be payable. Further enquiries can be directed to our Romiley office.



VIEWING ARRANGEMENTS

Viewing is strictly by appointment with Thomas Lardner Romiley Office - telephone number 0161 494 5136.

FITTED DINING KITCHEN

15' 3" x 6' 9" (4.64m x 2.06m)



BEDROOM ONE

13' 0" x 9' 0" (3.96m x 2.74m)



BEDROOM TWO

13' 0" x 6' 0" (3.96m x 1.83m)

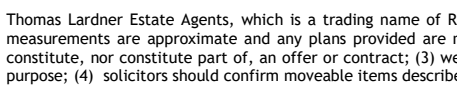

FIRST FLOOR
559 sq.ft. (51.9 sq.m.) approx.

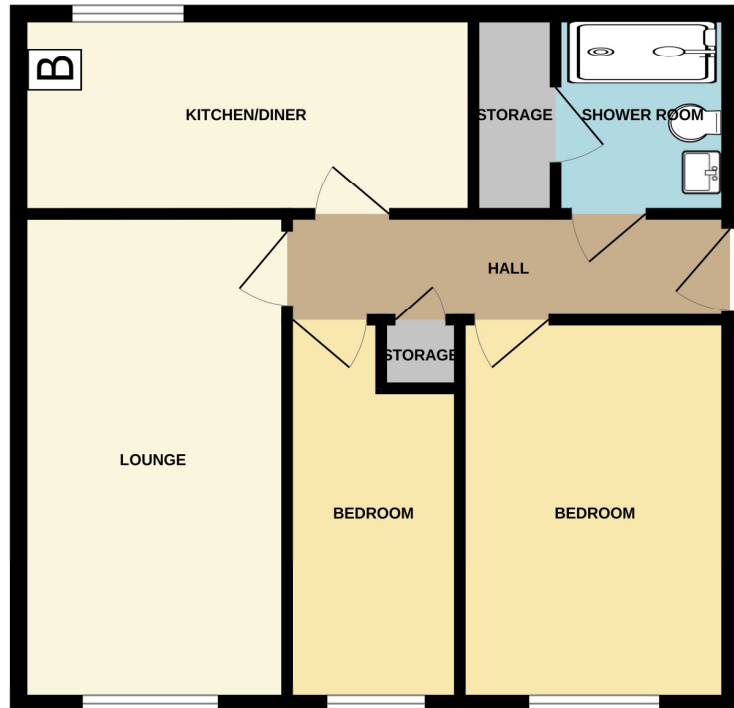

TOTAL FLOOR AREA: 559 sq.ft. (51.9 sq.m.) approx.

Whilst every attempt has been made to ensure the accuracy of the floorplan contained here, measurements of doors, windows, rooms and any other items are approximate and no responsibility is taken for any error, omission or mis-statement. This plan is for illustrative purposes only and should be used as such by any prospective purchaser. The services, systems and appliances shown have not been tested and no guarantee as to their operability or efficiency can be given.

Made with Metropix C2024

Thomas Lardner Estate Agents, which is a trading name of Romiley Residential Ltd, for themselves and for the vendors or lessors of this property whose agents they are give notice that: (1) all measurements are approximate and any plans provided are not to scale; (2) the particulars are set out as a general outline only for the guidance of intending purchasers or lessors, and do not constitute, nor constitute part of, an offer or contract; (3) we have not tested any apparatus, equipment, fixtures, fittings or services, and so cannot verify that they are in working order or fit for purpose; (4) solicitors should confirm moveable items described in these particulars are, in fact, included in the sale since circumstances change during marketing or negotiations.

1709 Printed by Ravensworth 01670 713330