

SIGNATURE

NORTH EAST

OFFICIALLY RATED THE NO.1 ESTATE AGENT IN THE NORTH EAST





 Kingdom Place, North Shields NE29 6YQ

Kingdom Place, North Shields NE29 6YQ

Asking Price
£345,000

Signature North East welcomes to the market, this stunning property nestled in the heart of North Shields, offering captivating balcony views of the Royal Quay Marina and the serene river. This detached 3-bedroom, 3-bathroom house presents an ideal sanctuary for young families. North Shields boasts a prime location, appealing to those desiring a tranquil suburb with excellent city connections, complemented by nearby recreational spots such as Leisure Parks, sports centres, and the picturesque Redburn Dene.

Step into the central hallway, your gateway to the ground floor's principal rooms and a convenient WC. The spacious sitting/dining room beckons with ample space for desired furnishings. Accessible via French doors from here is the charming conservatory, bathed in natural light through skylights. The well-appointed kitchen offers abundant storage with wall and base units, featuring integrated hob and oven. A downstairs WC and utility room, with an outside door for added convenience, complete this level.

Ascending to the first floor reveals three generously sized bedrooms, easily accommodating double beds and additional furnishings. The master bedroom boasts an en-suite with a step-in shower, hand basin, and WC. Step out onto the balcony from the master bedroom, where tranquil river views await, perfect for enjoying early morning coffee or moments of relaxation. Completing this floor is the recently renovated family bathroom, exuding a modern aesthetic.

Externally, the property delights with a spacious garden featuring multiple levels and an ample patio, ideal for outdoor entertaining. Three off-street parking spaces via the front drive add to the property's convenience.

This inviting home awaits your presence. Contact Signature North East today to schedule your viewing and discover your next chapter in North Shields.



PLEASE NOTE THAT THE VENDOR HAS CERTIFIED THE PROPERTY INFORMATION AND IMAGES.

PROPERTY FLOORPLAN

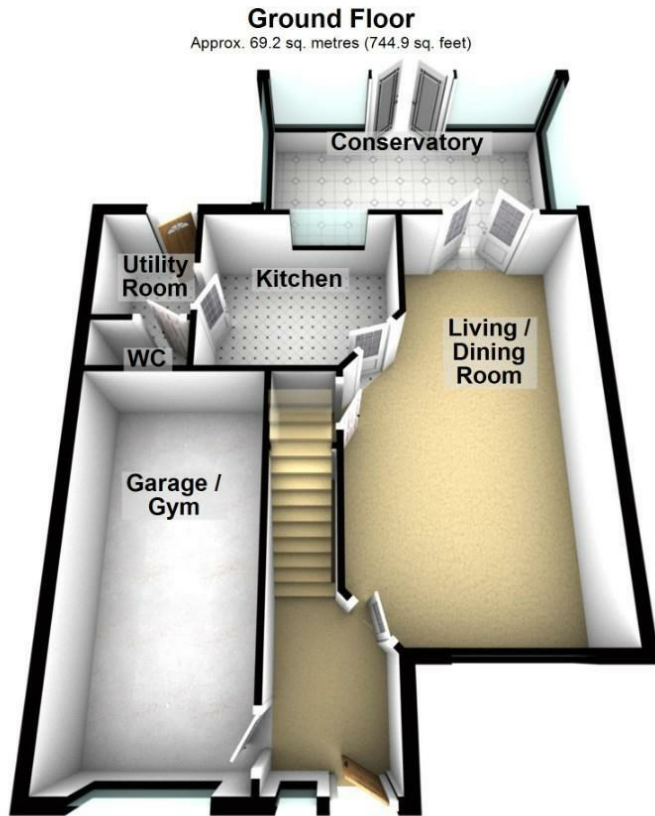

Total area: approx. 117.6 sq. metres (1265.7 sq. feet)

Please be advised the floorplans are not drawn to scale and are to be used to give an idea of the layout of the property.
Plan produced using PlanUp.

Measurements:

Living Room
21'3" x 10'11"

Kitchen
9'10" x 8'5"

Conservatory
16'1" x 8'9"

Utility Room
5'9" x 5'2"

WC
4'9" x 2'6"

Bedroom One
17'3" x 9'0"

En Suite
7'10" x 3'10"

Bedroom Two
10'9" x 10'4"

En Suite
5'5" x 5'2"

Bedroom Three
12'3" x 7'8"

Garage / Gym
17'10" x 8'6"

Energy Efficiency Rating

	Current	Potential
Very energy efficient - lower running costs		
(92 plus) A		
(81-91) B		83
(69-80) C	67	
(55-68) D		
(39-54) E		
(21-38) F		
(1-20) G		
Not energy efficient - higher running costs		

England & Wales

EU Directive
2002/91/EC







More 5 Star Customer Reviews than any other Agent based in the North East on allAgents.co.uk



SALES

LETTINGS

FINANCE

LAW

WE COVER THE WHOLE OF THE NORTH EAST

Whitley Bay
0191 251 3344

Cramlington
01670 897 213

Tynemouth
0191 296 6689

Morpeth
01670 513 966

Ponteland
01661 820 082

Wallsend
0191 432 4151

Alnwick
01665 511 800

Heaton
0191 432 4275

Forest Hall
0191 266 9966

Other locations
0191 640 3523

Newcastle
0191 640 2284

Durham
0191 303 8252

Gosforth
0191 640 3523

Sunderland
0191 543 6390

Whickham
0191 432 5102

Gateshead
0191 432 4294

Jesmond
0191 281 1037

Killingworth
0191 640 3602

Ryton
0191 413 9845

Head Office &
Lettings
0191 253 4815

*Highest recommended 5-star reviews than any other Estate Agent based in the North East on allAgents.co.uk - The UK's Largest Customer Review Website for the Property Industry & Awarded Best Estate Agency 2018 & 2019 - North East England by SME News